

DATE	BY	CHECK	JOB NO.
6	ANC		40243
PLAN SHEET			

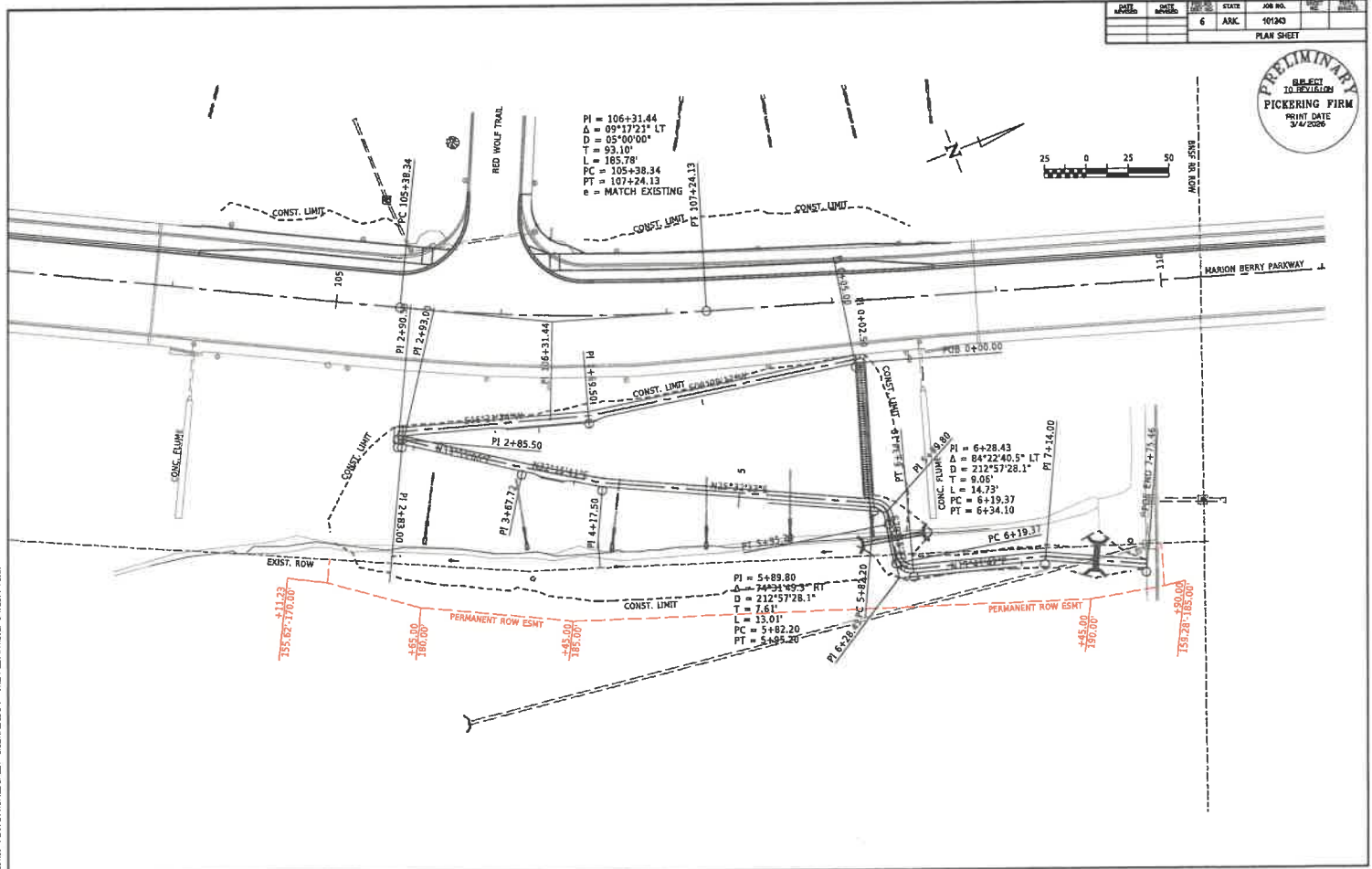

2683131-PLAN & PROFILE SHEET - BORDWALL/COON CREATED: 11/10/2025 DRAWN: MCD28

Return recorded document to:
CITY OF JONESBORO
300 South Church Street
Jonesboro, AR 72401

The above space is reserved for Craighead County recording information

PERMANENT RIGHT-OF-WAY EASEMENT

KNOW ALL MEN BY THESE PRESENTS: (01-144171-00800)

That, **STATE OF ARKANSAS**, hereinafter referred to as Grantor (whether one or more), does hereby dedicate, grant and convey unto the Public, and that the **CITY OF JONESBORO**, a Municipal Corporation of the State of Arkansas, hereinafter referred to as Grantee, does hereby accept on behalf of the public, for use as a permanent right-of-way across the following described real property in Craighead County, State of Arkansas, to-wit:

PART OF THE SOUTHWEST QUARTER OF THE SOUTHEAST QUARTER OF SECTION 17, TOWNSHIP 14 NORTH, RANGE 4 EAST, JONESBORO, CRAIGHEAD COUNTY, ARKANSAS, MORE PARTICULARLY DESCRIBED AS FOLLOWS:

BEGINNING AT THE SOUTHWEST CORNER OF THE SOUTHWEST QUARTER OF THE SOUTHEAST QUARTER OF SECTION 17, TOWNSHIP 14 NORTH, RANGE 4 EAST, JONESBORO, CRAIGHEAD COUNTY, ARKANSAS; THENCE NORTH 00°00'00" EAST, 785.28 FEET; THENCE NORTH 90°00'00" EAST, 829.63 FEET TO THE POINT OF BEGINNING PROPER; THENCE NORTH 24°36'19" EAST, 121.65 FEET; THENCE NORTH 18°38'58" EAST, 382.20 FEET; THENCE SOUTH 72°46'21" EAST, 25.72 FEET; THENCE SOUTH 10°53'14" WEST, 45.28 FEET; THENCE SOUTH 18°43'28" WEST, 312.81 FEET; THENCE SOUTH 26°16'07" WEST, 92.86 FEET; THENCE SOUTH 35°57'42" WEST, 58.75 FEET; THENCE NORTH 63°29'00" WEST, 14.38 FEET TO THE POINT OF BEGINNING PROPER; CONTAINING 0.3 ACRES, MORE OR LESS, SUBJECT TO ALL RIGHT-OF-WAY AND EASEMENTS OF RECORD.

This right-of-way easement is for the purpose of constructing and maintaining pedestrian and bicycle infrastructure improvements. Any other use of this area, other than by record owners, shall only be granted by record owners, but they are not precluded from using or granting other use, so long as same does not interfere unreasonably with the express purpose intended.

This grant of easement and right-of-way shall be binding upon the heirs, successors, administrators and assigns of the grantors.

IN WITNESS WHEREOF, the grantors have executed this instrument on the ____ day of _____, 20____.

Owner Info

BY:

Signature: Russ Hannah

Name: Russ Hannah

Title: Chief Financial Officer

ACKNOWLEDGMENT

STATE OF Arkansas.

COUNTY OF Craighead.

On this day before me, the undersigned officer, personally appeared Russ Hannah, to me well known to be the person whose name is subscribed to the foregoing instrument, and acknowledged that he had executed the same for the purpose therein stated and set forth.

WITNESS my hand and seal this 13 day of May, 2021.

Notary Public (Signature): Patsy Bishop

My Commission Expires: 11-20-2034

PATSY BISHOP
NOTARY PUBLIC - STATE OF ARKANSAS
CRAIGHEAD COUNTY
MY COMMISSION EXPIRES 11-20-2034
COMMISSION# 12401424

EXECUTIVE SUMMARY

Contact: Russ Hannah (870) 972-2285

ACTION ITEM: Arkansas State University (A-State) seeks approval to grant a permanent right-of-way easement to the City of Jonesboro, Arkansas, located across A-State property in section 17, Township 14 North, Range 4 East, in Jonesboro, Craighead County, to construct and maintain pedestrian and bicycle infrastructure improvements.

ISSUE: The Board of Trustees must approve the conveyance of easements affecting university property.

BACKGROUND:

- Arkansas State University owns real property in Jonesboro, located in Section 17, Township 14 North, Range 4 East, the southwest quarter of the southeast quarter of which the City of Jonesboro has requested a permanent right-of-way easement for the purpose of constructing and maintaining pedestrian and bicycle infrastructure improvements.
- The easement, as shown and legally described in Exhibit A (Legal Description) and Exhibit B (Easement Map), will provide the City of Jonesboro access for these construction and maintenance projects, while preserving ASU's property rights and ensuring that all activity remains consistent with university operations.
- The Chancellor of Arkansas State University and the President of the ASU System recommend approval of the proposed easement, as the project will enhance accessibility and safety for students, faculty, staff, and the surrounding community.

RECOMMENDATION/RESOLUTION:

Be it resolved that Arkansas State University is approved to grant a permanent right-of-way easement to the City of Jonesboro, Arkansas, across A-State property, located in Section 17, Township 14 North, Range 4 East, in Jonesboro, Craighead County, Arkansas, as described in the attached easement document. The Chancellor, or Chancellor's designee, is authorized to execute all documents necessary to carry out the intent of this Resolution.



Price Gardner, Secretary

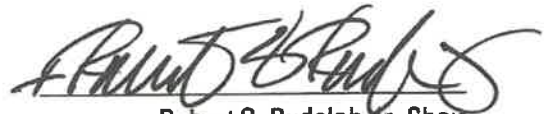

Robert G. Rudolph Jr., Chair