

Z:\Morris Real Estate Holdings, LLC\Projects\Sarah's Crossing\Engineering\Phase IV\Sarah Crossing P4 11 2025.dwg, 7/1/2025 3:52:24 PM

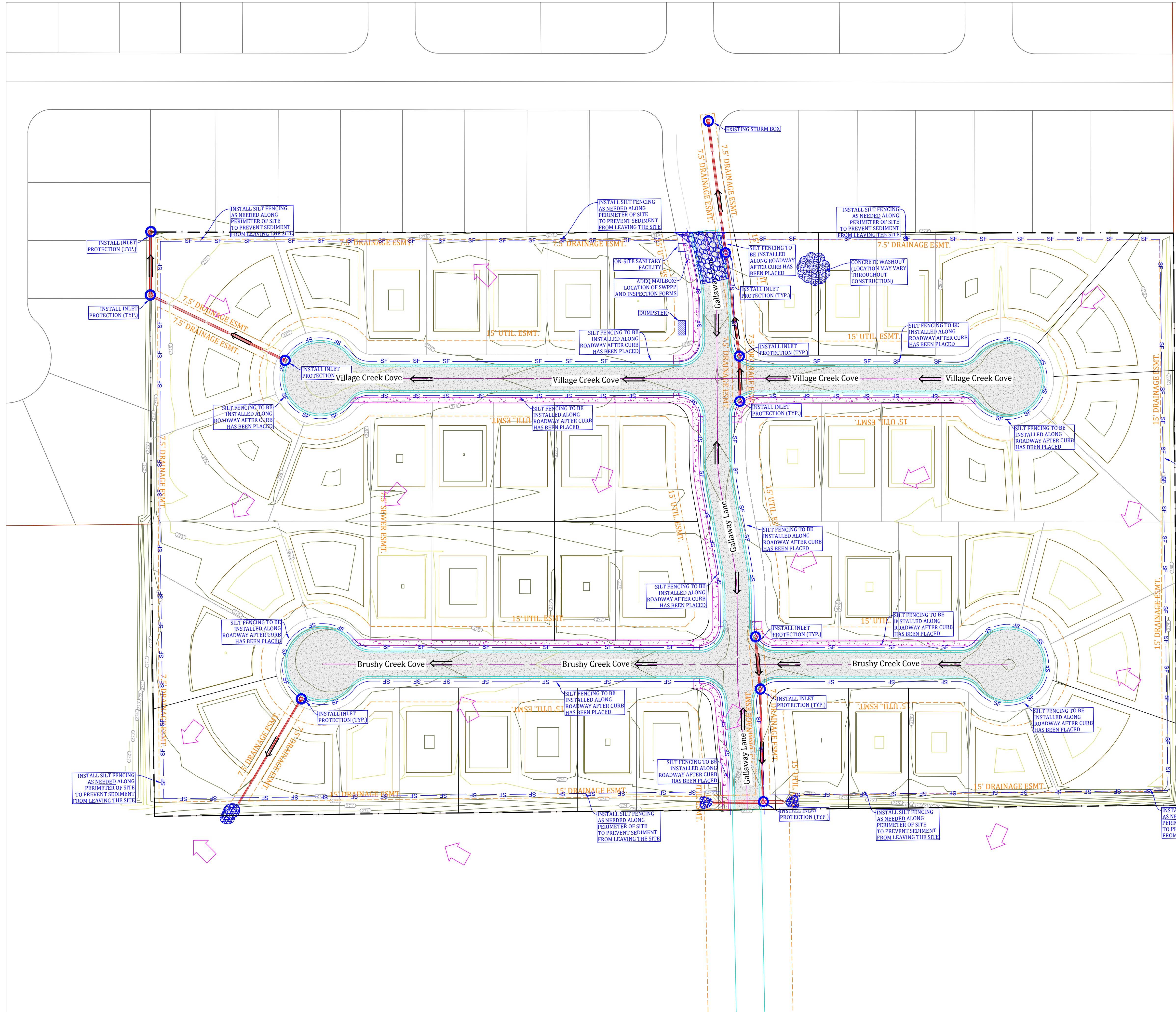

- — SILT FENCE BARRIERS TO BE ERECTED AROUND INLET LOCATIONS PRIOR TO BOX TOPS BEING POURED TO PREVENT SEDIMENT FROM INFILTRATING STORM DRAIN NETWORK; ONCE BOX TOPS HAVE BEEN POURED, WATTLES SHALL BE UTILIZED TO CONTINUE PREVENTION OF SEDIMENT INFILTRATION.
- — PRE-DEVELOPMENT FLOW DIRECTION
- — POST-DEVELOPMENT FLOW DIRECTION
- SILT FENCE, INSTALL AS NECESSARY TO DIVERT FLOW AND PREVENT SEDIMENT FROM LEAVING THE SITE.

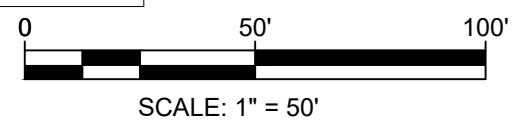

Know what's below.
Call before you dig.

SARAH CROSSING - PHASE IV

EROSION CONTROL PLAN



REVISIONS			
DATE	BY	DESCRIPTION	

DRAWING INFO.	
DRAWN BY:	IMH
DATE:	06/04/2025
SCALE:	1"=50'

SHEET NUMBER:

E-1

MARK MORRIS

MARK MORRIS P.E.
6011 SOUTHWEST DRIVE
JONESBORO, AR 72404
PH: 1-870-919-7700
MARK@MARKMORRISHOMES.COM