

LEGAL DESCRIPTION: (As Furnished)

The South 660 feet of the Southwest Quarter of the Southeast Quarter of Section 33, Township 14 North, Range 4 East, containing 20 acres, more or less, ALSO, THE South 660 feet of that part of the Southeast Quarter of the Southeast Quarter of Section 33, Township 14 North, Range 4 East, lying West of the right-of-way of the Missouri Pacific Railway Company, containing 4.034 acres, more or less, and containing in the aggregate 24.034 acres, more or less, Subject to all existing public and private roads and easements and subject to reservation of undivided one-half of all oil, gas, coal, and other minerals in, upon and under above lands, reserved by the Federal Land Bank of St. Louis in deed recorded in Deed Record 92 Page 226 at Jonesboro, Arkansas.

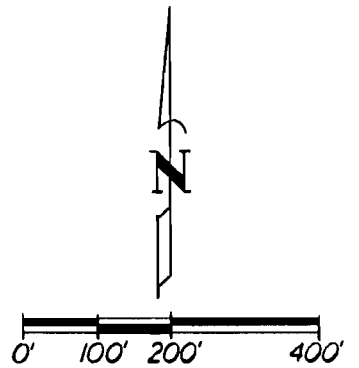

METROPOLITAN AREA PLANNING COMMISSION
Jonesboro - Craighead County

PRELIMINARY APPROVAL
 FINAL APPROVAL
 AS NOTED
 DISAPPROVED

Harold M. Cracker Jr. Chairman
Lee [Signature] Secretary
 _____ Date

OWNER'S CERTIFICATION:

We hereby certify that we are the owners of the property shown and described hereon, that we adopt the plan of subdivision and dedicate perpetual use of all streets and easements as noted.

Roy Cooper

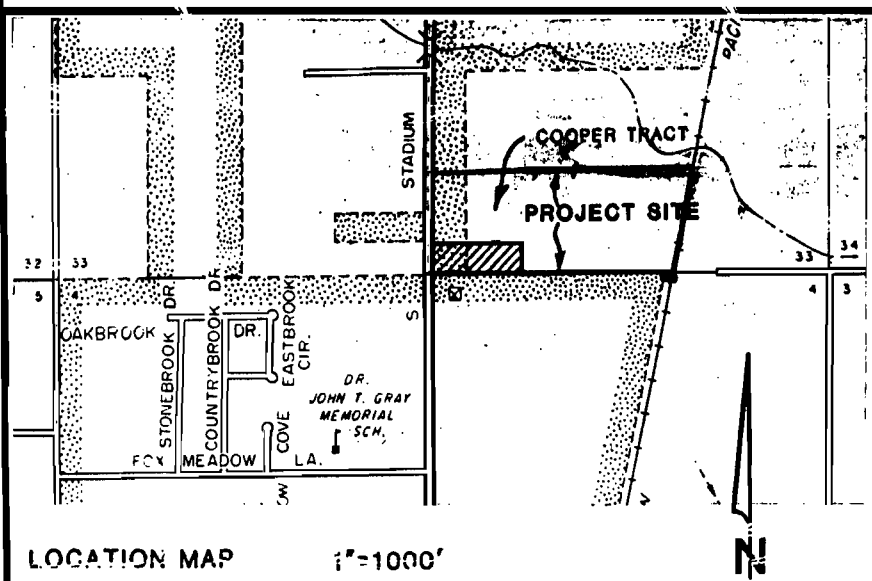

R291-1

JONESBORO
MILLER
NEWELL
 • Engineers
 • Surveyors
 JONESBORO ARKANSAS

REZONING PLAT OF
 PT. SE 1/4 SEC. 33-T14N-R4E
 for
 MR. ROY COOPER
 JONESBORO, ARKANSAS

JOB NO. 95-42 DATE 12-14-90