

AREAS OF DISTURBANCE:
 AREA DISTURBED FOR SITE CONSTRUCTION = **6.0 ACRES**
 TOTAL LAND AREA = **6.0 ACRES**

- NOTES:**
- THIS DRAWING REPRESENTS THE SCHEMATIC MAP OF THE LOCATION AND TYPE OF THE MINIMUM EROSION CONTROL MEASURES ANTICIPATED FOR THIS SITE AND SHALL BE CONSIDERED A PART OF THE STORM WATER POLLUTION PREVENTION PLAN (SWPPP) AS REQUIRED BY THE CITY OF JONESBORO AND ADEQ. THIS MAP SHALL BE UPDATED AND MODIFIED PERIODICALLY AS SPECIFIED IN THE SWPPP PLAN IN ACCORDANCE WITH THE REQUIREMENTS OF THE STATE OF ARKANSAS NATIONAL POLLUTION DISCHARGE ELIMINATION SYSTEM GENERAL PERMIT (NPDES PERMIT).
 - THE OWNER SHALL BE RESPONSIBLE FOR SUBMITTING THE NOTICE OF INTENT TO THE CITY OF JONESBORO ENGINEERING DEPARTMENT AND ARKANSAS DEPARTMENT OF ENVIRONMENTAL QUALITY (ADEQ) AS REQUIRED BY THE GENERAL NPDES PERMIT REGULATIONS AND OBTAINING THE REQUIRED PERMIT FROM ADEQ.
 - CONTRACTOR SHALL INSTALL, INSPECT, MAINTAIN, REPAIR, AND MODIFY ALL EROSION CONTROL MEASURES AND SWPPP PLAN IN ACCORDANCE WITH THE GENERAL PERMIT REQUIREMENTS TO KEEP THEM IN GOOD WORKING CONDITION THROUGHOUT THE ENTIRE CONSTRUCTION PERIOD. FAILURE TO MAINTAIN COMPLIANCE MAY RESULT IN THE DENIAL OF BUILDING AND CONSTRUCTION INSPECTIONS UNTIL CORRECTIONS HAVE BEEN MADE. CONTRACTOR SHALL MAINTAIN A CONTINUOUSLY UPDATED SWPPP PLAN AND MAP ON SITE (IN A CONTAINER MARKED AS SUCH TO IDENTIFY THE PLAN) IN A PUBLIC ACCESSIBLE LOCATION FOR REVIEW AND INSPECTION BY THE APPROPRIATE INSPECTORS.
 - SILT FENCE & OTHER EROSION CONTROL DEVICES SHALL BE INSTALLED (AS SHOWN ON THE MAP) TO PREVENT MIGRATION OF SEDIMENT TO ADJACENT PROPERTIES & ALONG TOP OF DITCH BANK TO ENSURE THAT THE EXISTING DITCHES ARE NOT CONTAMINATED WITH SEDIMENT DURING CONSTRUCTION. ADDITIONAL LOCATIONS MAY BE NECESSARY AS CONSTRUCTION PROGRESSES. AREAS DISTURBED BY CONSTRUCTION SHALL BE TEMPORARILY SEEDED IN AREAS WHERE CONSTRUCTION CEASES FOR 14 DAYS AND PERMANENTLY SEEDED WITHIN 14 DAYS OF THE COMPLETION OF CONSTRUCTION. THE LOCAL SOIL CONSERVATION SERVICE CAN BE CONTACTED FOR ASSISTANCE.
 - CONTRACTOR SHALL INSTALL A STONE CONSTRUCTION EXIT (PRIOR TO CONSTRUCTION) AT THE LOCATIONS CONSTRUCTION VEHICLES LEAVE THE SITE TO PREVENT DUST AND MUD TRACKING ONTO STREETS. CONTRACTOR SHALL CLEAN ALL TRACKING MATERIALS FROM STREETS AS FREQUENTLY AS NECESSARY TO MAINTAIN CLEAN STREETS AND AT A MINIMUM OF THE END OF THE DAY.
 - AN INSPECTION SHALL BE MADE WEEKLY. ALL OBSERVED DEFICIENCIES OF THE BEST MANAGEMENT PRACTICES (BMPs) WILL BE RECORDED AND REPAIRED AS SOON AS POSSIBLE.
 - SEDIMENT SHALL BE REMOVED FROM ALL EROSION CONTROL DEVICES WHEN SEDIMENT REACHES 50% OF THE DEVICE CAPACITY.
 - A SOLID WASTE CONTAINER SHALL BE PROVIDED FOR SOLID WASTE REMOVAL.
 - A TEMPORARY SANITARY SEWER CONTAINER SHALL BE PROVIDED.
 - A CONCRETE WASTE PIT SHALL BE PROVIDED AS NEEDED DURING THE CONSTRUCTION OF THE SITE.

OWNER / CONTRACTOR CERTIFICATION:
 I certify under penalty of law that I understand the term and conditions of the General National Pollutant Discharge Elimination System (NPDES) Permit that authorizes the storm water discharges associated with the industrial activity from the construction site identified as part of this certification.

OWNER _____ DATE _____
 CONTRACTOR _____ DATE _____

PROFESSIONAL PLAN CERTIFICATION:
 I certify under penalty of law that this document and all attachments were prepared under my direction or supervision in accordance with a system designed to assure that all qualified personnel properly gathered and evaluated the information submitted. Based on my inquiry of the person or persons who manage the system, or those persons directly responsible for gathering the information submitted is, to the best of my knowledge and belief, true, accurate, and complete.
 I am aware that there are significant penalties for submitting false information, including the possibility of fine and imprisonment for knowing violations."

CARLOS WOOD _____ ENGINEER
 PRINTED NAME: _____ PRINTED TITLE: _____
Carlos Wood _____ DATE: 11-18-13
 SIGNATURE: _____

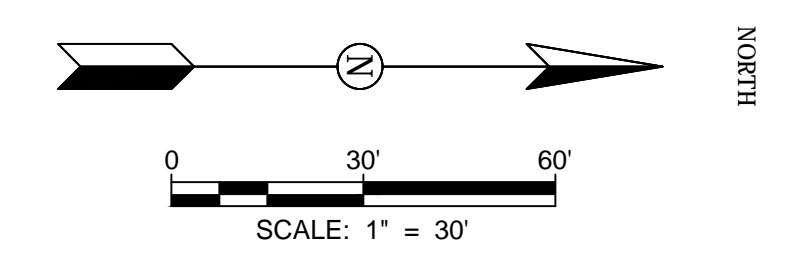

PERMIT NOTE:
 DEVELOPER SHALL OBTAIN GRADING PERMIT FROM THE CITY OF JONESBORO ENGINEERING DEPARTMENT PRIOR TO COMMENCING EARTHWORK AND/OR CLEARING OPERATIONS.
 DEVELOPER SHALL OBTAIN REQUIRED ADEQ PERMIT PRIOR TO COMMENCING WORK ON THE SITE. PREPARE A SWPPP PLAN, AND DISPLAY THEM FOR PUBLIC ACCESS AT THE SITE.

LEGEND

	CURB		EXISTING CONTOUR
	DRAIN FLOW		PROPOSED CONTOUR
	BENCHMARK		EXISTING SPOT ELEVATION
	FIRE HYDRANT		SEDIMENT (SILT) FENCE

PROPOSED SPOT ELEVATION:
 TW = TOP WALK
 TC = TOP CURB
 GT = GUTTER
 PVT = PAVEMENT
 FL = FLOWLINE

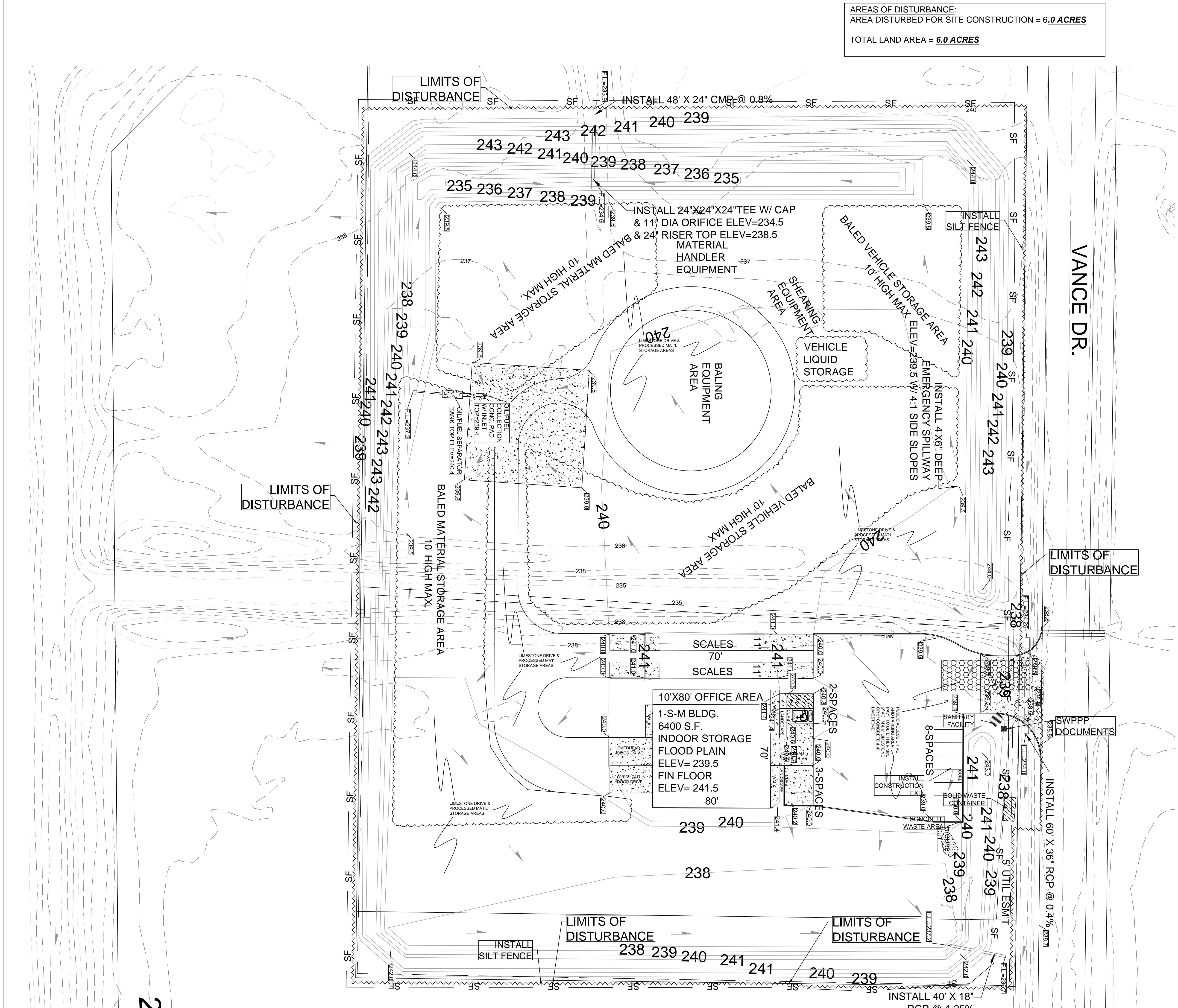

SP-3

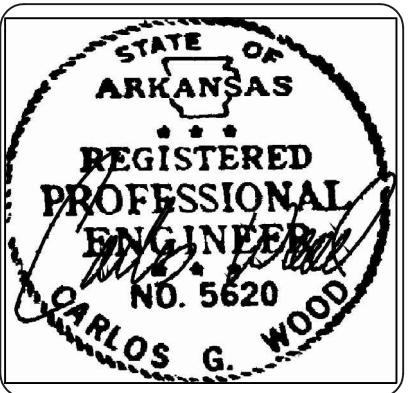

JONESBORO RECYCLING FACILITY
 EROSION CONTROL MAP
 JONESBORO, AR

DATE: 7/29/13
 BY: 9-17-13
 9-29-13
 11-18-13
 1-7-15
 1-8-15
 DRAWN BY: BGW

CARLOS WOOD, P.E.
 ENGINEERING CONSULTANT
 122 CR 375
 BONO, AR 72416
 PHONE/FAX: (870) 972-8335
 EMAIL: WOODENGR@SBCGLOBAL.NET
 WEBSITE: WWW.WOODENGR.COM

