

**OWNER'S CERTIFICATION:**  
 We hereby certify that we are the owners of the property shown and described hereon, that we adopt the plan of subdivision and dedicate perpetual use of all streets and easements as noted.

*C.R. Miles*

**CERTIFICATE OF SURVEY:**  
 To all parties interested in Title to these premises: I hereby certify that I have prior to this day made a survey of the above described property as shown on the Plat of Survey hereon. The property lines and corner monuments, to the best of my knowledge and ability, are correctly established; Encroachments, if any, as disclosed by Survey, are shown hereon.

By: *George M. Hamman*  
 Date: *02/11/04*

PROFESSIONAL LAND SURVEYOR  
 STATE OF ARKANSAS  
 NO. 1273

**LEGAL DESCRIPTION:**  
 A part of the East Half of Section 7, Township 14 North, Range 4 East, Craighead Co., Ark. to wit: From the Southeast corner of the Northeast Quarter of the Southeast Quarter, run S 88°12'51" W a distance of 69.90 ft. to the POINT OF BEGINNING; thence continue S 88°12'51" W a distance of 1247.27 ft. to a point in the centerline of Lost Creek; thence follow along said creek centerline as follows: N00°30'36"E a distance of 208.91 ft., then N05°07'27"E a distance of 106.45 ft., then N16°39'36"E a distance of 123.32 ft., then N33°40'56"E a distance of 86.34 ft., then N28°34'52"E a distance of 366.60 ft., then N31°32'26"E a distance of 171.39 ft., then N29°11'25"E a distance of 107.25 ft., then N27°24'24"E a distance of 70.12 ft., then N33°01'42"E a distance of 107.96 ft., then N30°37'35"E a distance of 53.95 ft., then N34°53'03"E a distance of 138.18 ft., then N53°34'03"E a distance of 82.55 ft., then N69°33'27"E a distance of 114.83 ft., then S74°36'35"E a distance of 122.41 ft., then N81°19'00"E a distance of 90.40 ft. to a point on the West right of way line of Patrick St.; then run along said right of way line as follows: S03°48'15"E a distance of 140.69 ft., then S01°52'36"E a distance of 86.35 ft., then S00°32'50"W a distance of 1116.14 ft. to the POINT OF BEGINNING, containing 32.58 acres.

**NOTES:**  
 1) THIS SURVEY AND PLAT ARE THE PROPERTY OF THE SURVEYOR AND ARE INTENDED FOR THE SOLE USE AND BENEFIT OF THE SURVEYOR & CLIENT.  
 2) OWNER: C. R. MILES  
 3) FLOOD PLAIN: A PORTION OF THIS TRACT DOES LIE WITHIN THE 100-YR. FLOOD PLAIN AND THE FLOODWAY PER FLOOD INSURANCE RATE MAP OF CRAIGHEAD CO., ARK. AND INCORPORATED AREAS, COMMUNITY PANEL NO. 05031C044 C, DATED 09/27/91. THIS TRACT DOES LIE WITHIN A ZONE "X" FLOOD PLAIN, PER THE MAP REFERENCED ABOVE.

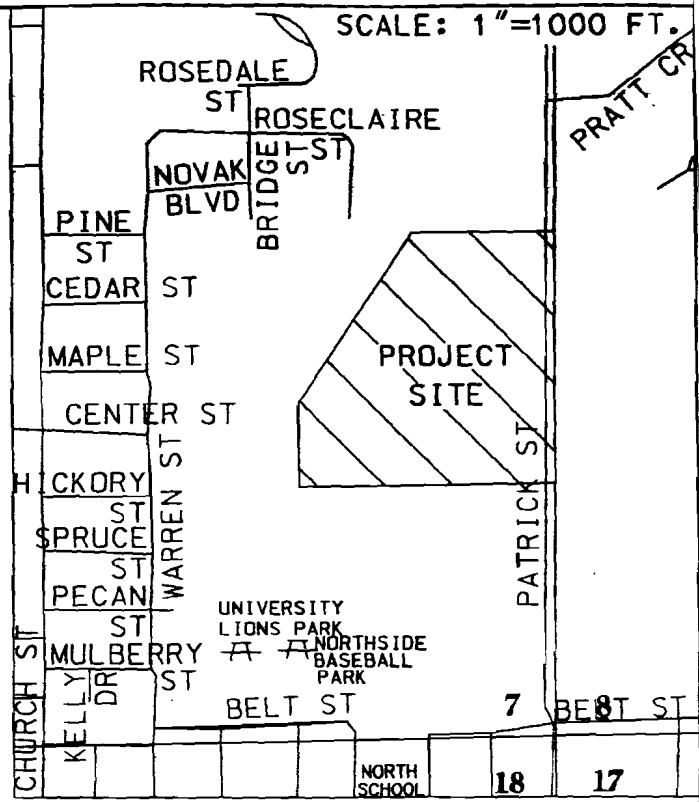

**EXISTING ZONING: R-1**  
**REQUESTED ZONING: R-2A**

**HNE** ENGINEERS - SURVEYORS  
 2311 E. NETTLETON AVE.  
 JONESBORO, AR 72401  
 (870) 932-7880

**REZONING PLAT FOR RICH SMITH DEVELOPMENT**

JOB NO. 104029 DATE 02-11-04  
 © 2004, Hamman Newell Engineering RE  
 ONLY COPIES WITH VIOLET COLORED SIGNATURE ARE VALID HNE COPIES DRWR 5