

BROWNS LANE
($\frac{1}{2}$ ASPHALT SURFACE)

BASIS OF BEARING: ARKANSAS STATE PLANE GRID NORTH ZONE (0301)

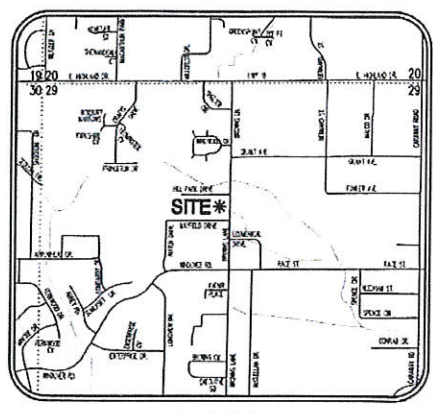

VICINITY MAP
(NOT TO SCALE)

LEGEND:

- FOUND 5/8" REBAR W/ YELLOW PLASTIC CAP STAMPED "TERRY BARE P.S. 1048" (OR AS NOTED)
- ▲ COMPUTED POINT (NOT MONUMENTED)
- STORM DRAIN MANHOLE
- SANITARY SEWER MANHOLE
- SANITARY SEWER LINE

SURVEYOR'S NOTES:

1. SURVEYOR HAS MADE NO INVESTIGATION OR INDEPENDENT SEARCH FOR EASEMENTS OF RECORD OR ANY OTHER FACTS WHICH AN ACCURATE TITLE SEARCH MAY DISCLOSE.
2. BASIS OF BEARING: GRID NORTH, ARKANSAS STATE PLANE COORDINATES, NORTH ZONE (0301).
3. THE FOLLOWING DOCUMENTS WERE USED IN THE CONSTRUCTION OF THIS SURVEY:
 - RECORD PLAT, HILL PARK ADDITION, BY TYLER K. WILSON, P.S. 1757, RECORDED IN BOOK C, PAGE 244, DATED JULY 23, 2013.
4. SUBJECT PROPERTY LIES OUTSIDE THE SPECIAL FLOOD ZONE A, AS SHOWN ON F.E.M.A. FLOOD INSURANCE RATE MAP 0503100132C, DATED SEPTEMBER 27, 1991, REVISED SEPTEMBER 10, 1999.
5. SUBJECT PROPERTY IS ZONED C-3 LUO, GENERAL COMMERCIAL DISTRICT, LIMITED USE OVERLAY.
6. C-3 BUILDING SETBACK REQUIREMENTS:
 - STREET SETBACK 25'
 - REAR SETBACK 20'
 - SIDE SETBACK 10'

CERTIFICATE OF SURVEY:

THIS IS TO CERTIFY THAT HAYWOOD, KENWARD, BARE AND ASSOCIATES, INC., PROFESSIONAL LAND SURVEYORS, HAVE SURVEYED THE FOLLOWING DESCRIBED PARCELS OF LAND:

*THE SOUTH 8.0 FEET OF LOT 9 AND THE NORTH 8.0 FEET OF LOT 10
LESS AND EXCEPT THE WEST 7.5 FEET AND THE EAST 27.7 FEET OF LOTS 9 AND 10*

HILL PARK ADDITION (PHASE 1 AND 2), JONESBORO, CRAIGHEAD COUNTY, ARKANSAS.

TO THE CITY OF JONESBORO, CRAIGHEAD COUNTY, ARKANSAS.

WE BEING THE AGENTS DO HEREBY DEDICATE TO THE PUBLIC USE FOREVER, ALL THE STREETS OF WIDTH, LENGTH, AND LOCATION, AS SHOWN ON THE PLAT HEREON, AND SAID AGENTS DO HEREBY DEDICATE ALL EASEMENTS TO THE PUBLIC USE FOR THE EXPRESS PURPOSE INDICATED. SAID EASEMENTS SHALL NOT BE USED FOR INGRESS/EGRESS BY THE PUBLIC.

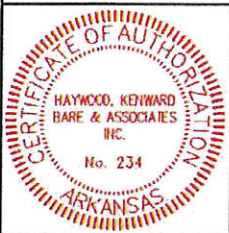
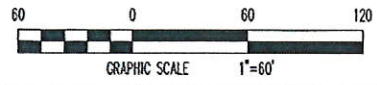

DRAINAGE EASEMENT ABANDONMENT

HILL PARK ADDITION TO THE CITY OF JONESBORO, CRAIGHEAD COUNTY, ARKANSAS

HAYWOOD, KENWARD, BARE & ASSOCIATES, INC.
CIVIL ENGINEERING - SURVEYING - PLANNING
1801 LATOURETTE DRIVE
JONESBORO, ARKANSAS 72404
TEL 870-932-2018 FAX 870-932-1076

REVISIONS	
DATE	DESCRIPTION
SURVEY INDEX CODE 500-141-016-0-39-420-16-1563	
PROJECT NO. JB9458-28	
DRAWN BY JWH	CHECKED BY MAD
SHEET 1 OF 1	SCALE 1"=60'
DATE 10/15/15	DRAWING NO. H-40

©COPYRIGHT 2015, ALL RIGHTS RESERVED

CLIENT
ACE PROPERTIES HOLDINGS