

RIGHT OF WAY ACQUISITION

A PART OF THE NORTHEAST QUARTER OF THE NORTHWEST QUARTER OF SECTION 4, TOWNSHIP 13 NORTH, RANGE 4 EAST, MORE PARTICULARLY DESCRIBED AS FOLLOWS;

COMMENCING AT THE NORTHEAST CORNER OF THE SOUTHEAST QUARTER OF THE NORTHWEST QUARTER; THENCE S89°24'W 664.64 FEET; THENCE N00°04'W 45.66 FEET TO THE POINT OF BEGINNING;

THENCE N89°37'W 235.23 FEET; THENCE N00°13'W 3.50 FEET; THENCE S89°37'E 235.25 FEET; THENCE S00°04'E 3.50 FEET TO THE POINT OF BEGINNING; CONTAINING (823.38 SQ. FT.) 0.02 ACRES, MORE OR LESS, AND BEING SUBJECT TO ANY EASEMENTS OF RECORD.

10 FOOT TEMPORARY CONSTRUCTION EASEMENT

A 10 FOOT WIDE STRIP OF LAND PARALLEL AND ADJACENT TO THE NORTH LINE OF THE DESCRIBED RIGHT OF WAY ACQUISITION AS SHOWN ON PLAT OF SURVEY HEREOF.

LEGEND

- SIP - SET 1/2" REBAR
- SCPS - SET COTTON PICKER SPINDLE
- FIP - FOUND IRON PIN
- POB - POINT OF BEGINNING

HERBERT HINE, PLS 1142
HINE LAND SURVEYING
P.O. BOX 2764 E. GULFPORT AVE SUITE 111
JONESBORO, ARKANSAS 72401



SURVEYORS CERTIFICATION

THIS IS TO CERTIFY THAT I FOUND OF THIS DATE SURVEYED THE ABOVE DESCRIBED PROPERTY IN ACCORDANCE WITH MONUMENTS FOUND AND THIS PLAT CONFORMS TO THAT SURVEY.

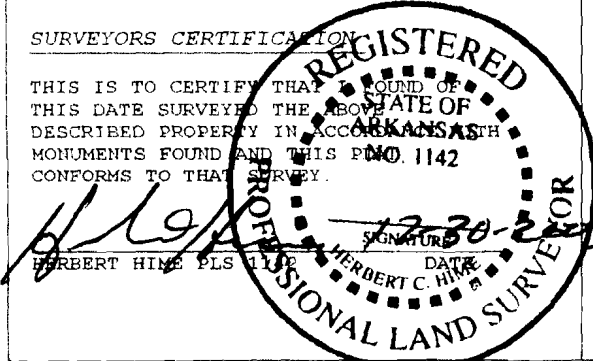

PARCELL "H"

DRAWN	DATE	JOHN T. GRAY SCHOOL PROPERTY
APPROVED	DATE	JONESBORO, ARKANSAS
SCALE	SHEET	PROJECT NO.
1" = 200'		