

**EASEMENT CHART**

A	N00°14'09\"W	105.28'
B	S89°12'03\"W	52.20'
C	S32°16'51\"W	84.65'
D	N89°52'02\"W	236.38'
E	S00°13'52\"E	222.08'
F	N00°06'58\"E	133.16'
G	S50°12'53\"W	36.32'
H	N87°35'24\"W	167.27'
I	N58°16'10\"W	90.40'
J	N41°48'07\"W	27.19'
K	N59°02'48\"W	57.91'
L	N00°08'06\"W	23.35'
M	S59°02'48\"E	68.66'
N	S44°08'45\"E	61.51'
O	S58°16'10\"E	82.28'
P	S87°35'24\"E	154.32'
Q	N50°12'53\"E	19.26'
R	N00°06'58\"E	123.75'
S	N00°13'52\"W	242.14'
T	S89°52'02\"E	245.45'
U	N32°16'51\"E	75.17'
V	N89°12'03\"E	49.27'
W	S00°14'09\"E	20.00'

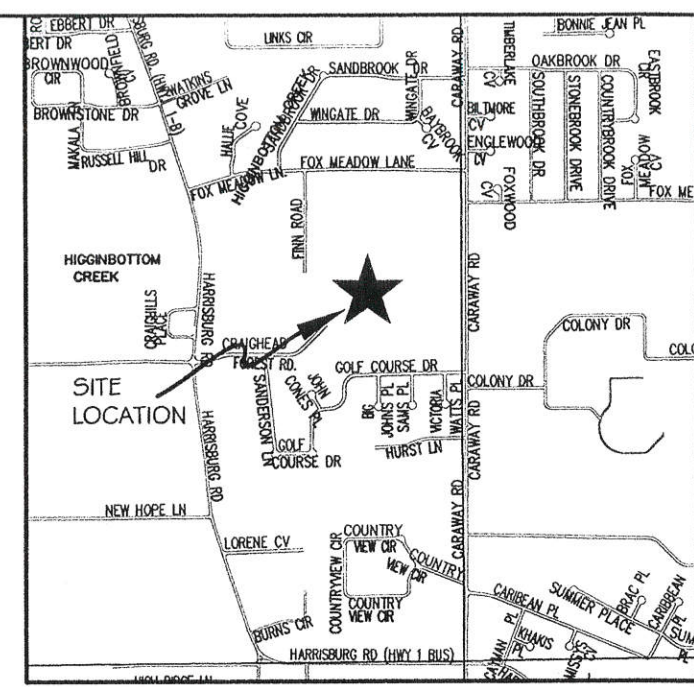
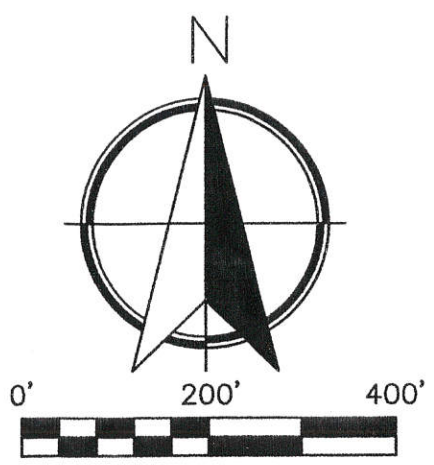

**LEGAL DESCRIPTION: (TRACT "D") (as furnished)**

That part of the Northeast Quarter of Section 5, Township 13 North, Range 4 East, in Craighead County, Arkansas, being described as follows: Beginning at the Southeast corner of said NE 1/4 of said Section 5, run thence N00°01'W 499.94 feet, run thence S89°59'W 29.9 feet to the West line of Caraway Road, run thence North 217.0 feet, run thence S89°59'W 501.3 feet, run thence N00°33'W 149.1 feet to the true point of beginning, run thence S89°44'W 673.7 feet, run thence N00°26'W 343.4 feet, run thence N89°44'E 673.0 feet, run thence S00°33'E 343.4 feet to the true point of beginning, containing 5.31 acres, more or less, AND subject to any utility easements.

**LEGAL DESCRIPTION: (TRACT "E") (as furnished)**

That part of the Northeast Quarter of Section 5, Township 13 North, Range 4 East, in Craighead County, Arkansas, being described as follows: Beginning at the Southeast corner of said NE 1/4 of said Section 5, run thence N00°01'W 499.94 feet, run thence S89°59'W 29.9 feet to the West line of Caraway Road, run thence North 217.0 feet, run thence S89°59'W 501.3 feet to the true point of beginning, run thence N00°33'W 149.1 feet, run thence S89°44'W 673.7 feet, run thence S00°26'E 501.6 feet to a point on the North line of Lot 1 of Katlyn Manor Minor Plat of a replat of Linda Kerr Subdivision, run thence N88°32'E, along the North of said Lot 1 of katlyn Manor Minor Plat of a replat of Linda Kerr Subdivision, 376.2 feet, run thence North 345.9 feet, run thence N89°59'E 295.2 feet to the true point of beginning, containing 5.32 acres, more or less, AND subject to any utility easements.

TOGETHER WITH the access easement as referenced in Access Easement Agreement executed June 29, 2012 by and between Willow Creek Properties, LLC, an Arkansas limited liability company, and Willow Creek Properties Phase Two, LLC, an Arkansas limited liability company, filed for record July 3, 2012 as Document Number JB2012R-011206, records of Craighead County, Arkansas.

**NOTES:**

- 1) THIS SURVEY AND PLAT ARE THE PROPERTY OF THE SURVEYOR AND ARE INTENDED FOR THE SOLE USE AND BENEFIT OF THE SURVEYOR & CLIENT.
- 2) THE CLOSURE PRECISION OF THE PLAT IS IN EXCESS OF 1' IN 644,000'.
- 3) THE RESEARCH COMPLETED FOR THIS SURVEY INCLUDES PREVIOUS SURVEYS.
- 4) ALL PINS SET ARE 1/2" REBAR, UNLESS NOTED OTHERWISE.
- 5) FLOOD PLAIN: THIS TRACT DOES NOT LIE WITHIN THE 100-YR FLOOD PLAIN PER FLOOD INSURANCE RATE MAP OF CRAIGHEAD CO., ARK. AND INCORPORATED AREAS, COMMUNITY PANEL NO. 05031C0134 C, DATED 09/27/91. THIS TRACT DOES LIE WITHIN A ZONE "X" FLOOD PLAIN, PER THE MAP REFERENCED ABOVE.

**CERTIFICATE OF SURVEY:**

To all parties interested in Title to these premises: I hereby certify that I have prior to this day made a survey of the above described property as shown on the Plat of Survey hereon. The property lines and corner monuments, to the best of my knowledge and ability, are correctly established: the improvements are as shown on the Plat of Survey. Encroachments, if any, as disclosed by Survey, are shown hereon.

**OWNER'S CERTIFICATION:**

We hereby certify that we are the owners of the property shown and described hereon, that we adopt the plan of subdivision and dedicate perpetual use of all streets and easements as noted.

City of **Jonesboro** ARKANSAS  
 DATE **7/26/13**  
 FILE # **MP13-20**  
 FINAL APPROVAL  
 PRELIMINARY (NOT FOR RECORDING)  
 APPROVED BY: *[Signature]*  
 PLANNING DEPT  
 ENGINEERING DEPT

**WILLOW CREEK APARTMENTS PHASE II  
 MINOR PLAT  
 JONESBORO, ARKANSAS**

ENGINEERS		PLANNERS		SURVEYORS	
<b>Civilogic</b>					
203 Southwest Dr., Jonesboro, AR - (870) 932-7880 - www.civilogic.net					
<b>EXHIBIT 'A'</b>					
Date	Scale	Job No.	Sheet No.		
07-09-13	1"=200'	109064	1 of 1		
Section	Township	Range	County		
5	13N	04E	CRAIGHEAD		
ONLY COPIES WITH VIOLET COLORED SIGNATURE ARE ORIGINAL CIVILOGIC COPIES					
© 2013, Civilogic		Drawn By: RE	Checked by: GH		

*[Handwritten Signature]*