

GRAPHIC SCALE 1" = 50'

0 100 200

**REZONING PLAT**

**R-1 EXISTING**

**C-3 REQUESTED**

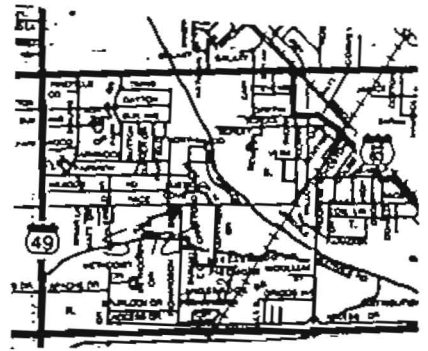
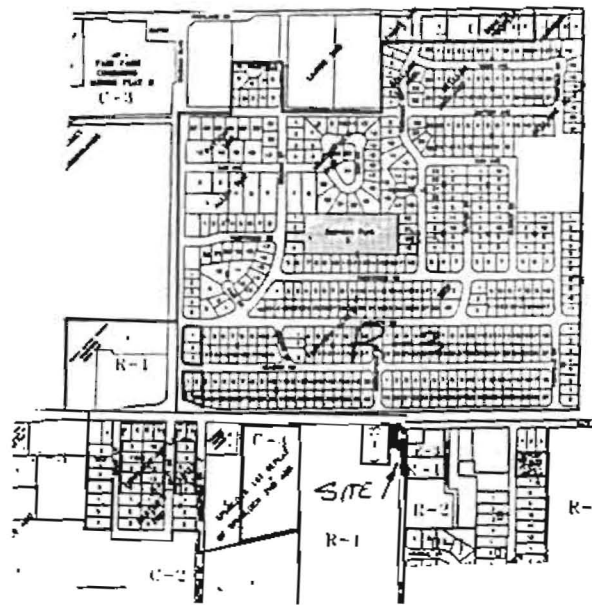

**DESCRIPTION:**  
 A PART OF THE NORTH-EAST QUARTER OF THE SOUTH-EAST QUARTER OF SECTION 28, TOWNSHIP 14 NORTH, RANGE 4 EAST CRAIGHEAD COUNTY, ARKANSAS AND BEING MORE PARTICULARLY DESCRIBED AS FOLLOWS:  
 Beginning at the East Quarter corner of said Section 28; thence South 0°49'00" West 165.00 feet; thence North 89°59'00" West 110.00 feet; thence North 0°49'00" East 165.00 feet; thence North 89°59'00" East 110.00 feet to the point of beginning proper, containing 18,150.00 square feet (0.42 ac.) more or less and being subject to all public and private roads and easements.

**OWNER CERTIFICATION:**  
 We hereby certify that we are the owners of the property shown and described hereon and that we accept the plan of Subdivision and dedicated perpetual use of all Streets and easements as noted.

*Mark Johnson*      5-1-00  
*Bonnie Flynn*      5-1-00

**SURVEYORS CERTIFICATION:**  
 This is to certify that I have of this date Surveyed the above described property in accordance with Monuments found and this plat conforms to that survey.

4-28-2000      *Herbert Hime*  
 DATE      HERBERT HIME PLS # 1142

HERBERT HIME  
 LAND SURVEYING  
 P.O. B. 361  
 BROOKLAND, ARKANSAS 72417