

DESCRIPTION - TRACT "B"

A PART OF THE SOUTHEAST QUARTER OF SECTION 9, TOWNSHIP 14 NORTH, RANGE 4 EAST JONESBORO, ARKANSAS BEING MORE PARTICULARLY DESCRIBED AS FOLLOWS:

BEGIN AT THE SOUTHEAST CORNER OF THE NORTHEAST QUARTER OF THE SOUTHEAST QUARTER OF SECTION 9, TOWNSHIP 14 NORTH, RANGE 4 EAST JONESBORO, ARKANSAS; THENCE S88°14'31"W 263.87 FEET TO THE POINT OF BEGINNING PROPER FOR TRACT "B"; THENCE S88°14'31"W 388.51 FEET, THENCE N23°51'00"W 182.59 FEET, THENCE S89°58'21"E 462.24 FEET, THENCE S00°01'45"W 154.86 FEET TO THE POINT OF BEGINNING PROPER CONTAINING 1.58 ACRES, MORE OR LESS, SUBJECT TO ALL RIGHTS OF WAY AND EASEMENTS OF RECORD.

CERTIFICATION

I HEREBY CERTIFY THAT McALISTER ENGINEERING HAS THIS DATE MADE A BOUNDARY SURVEY OF THE ABOVE DESCRIBED PROPERTY IN COMPLIANCE WITH THE ARKANSAS MINIMUM STANDARDS FOR PROPERTY BOUNDARY SURVEYS AND PLATS AND THAT ALL PROPERTY LINES AND CORNER MONUMENTS HAVE BEEN CORRECTLY ESTABLISHED TO THE BEST OF MY KNOWLEDGE AND BELIEF.

CLARENCE W. McALISTER, PROFESSIONAL LAND SURVEYOR NO. 1303 NOVEMBER 14, 2006

OWNER'S CERTIFICATION

I HEREBY CERTIFY THAT I AM IN AGREEMENT WITH ARKANSAS STATE UNIVERSITY TO PURCHASE THE ABOVE DESCRIBED PROPERTY CONTINGENT UPON THE REZONING OF SAID PROPERTY AND I HEREBY REQUEST A REZONING FROM RESIDENTIAL ONE (R-1) TO COMMERCIAL FIVE (C-5) AS SHOWN HEREON.

BRUCE TAYLOR, DDS

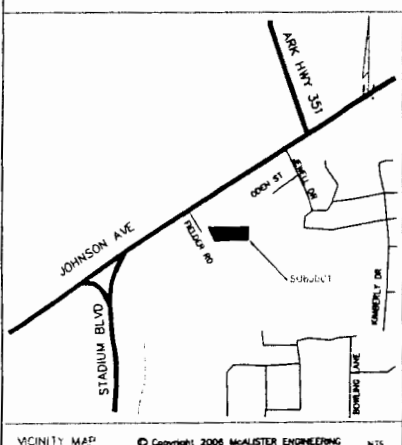

REZONING PLAT

A PART OF THE SOUTHEAST QUARTER OF SECTION 9, TOWNSHIP 14 NORTH, RANGE 4 EAST JONESBORO, ARKANSAS

| | | |
|--|-------------------|------------------|
| McALISTER ENGINEERING CIVIL ENGINEERING AND LAND SURVEYING <small>1213 OR 601 JONESBORO, AR 72404 870-631-1400</small> | DRAWN BY: SJM | CHECKED BY: CWM |
| | SCALE: 1" = 100' | |
| | DATE: 14NOV06 | CAD FILE 0625235 |
| | DWG REF. 4E-14N-9 | |
| | JOB NO. 0625235 | SHEET 1 / 1 |
| CLARENCE W. "MAC" McALISTER, PE, PLS 500-14N-04E-0-09-200-16-1303 | | |