

**A PART OF SECTION 33  
TOWNSHIP 14 NORTH, RANGE 3 EAST  
JONESBORO, CRAIGHEAD COUNTY, ARKANSAS**

PREPARED FOR: FISHER ARNOLD

**BASIS OF BEARINGS:**  
ARKANSAS STATE PLANE COORDINATE  
SYSTEM NORTH ZONE (301)  
LAT. 35°47'46.08234", LONG. -90°43'52.37010"  
COMB. SCALE FACTOR: 1.00007267036962  
(GRID TO GROUND - DISTANCES ARE IN GROUND)  
CONVERGENCE ANGLE: N 00°44'18" W



**DANIELS**  
LAND SURVEYING PLLC  
2713 PAULA DRIVE, SUITE A, JONESBORO, AR 72404  
PHONE: 870.335.6225 | WEB: WWW.DANIELS-LS.COM

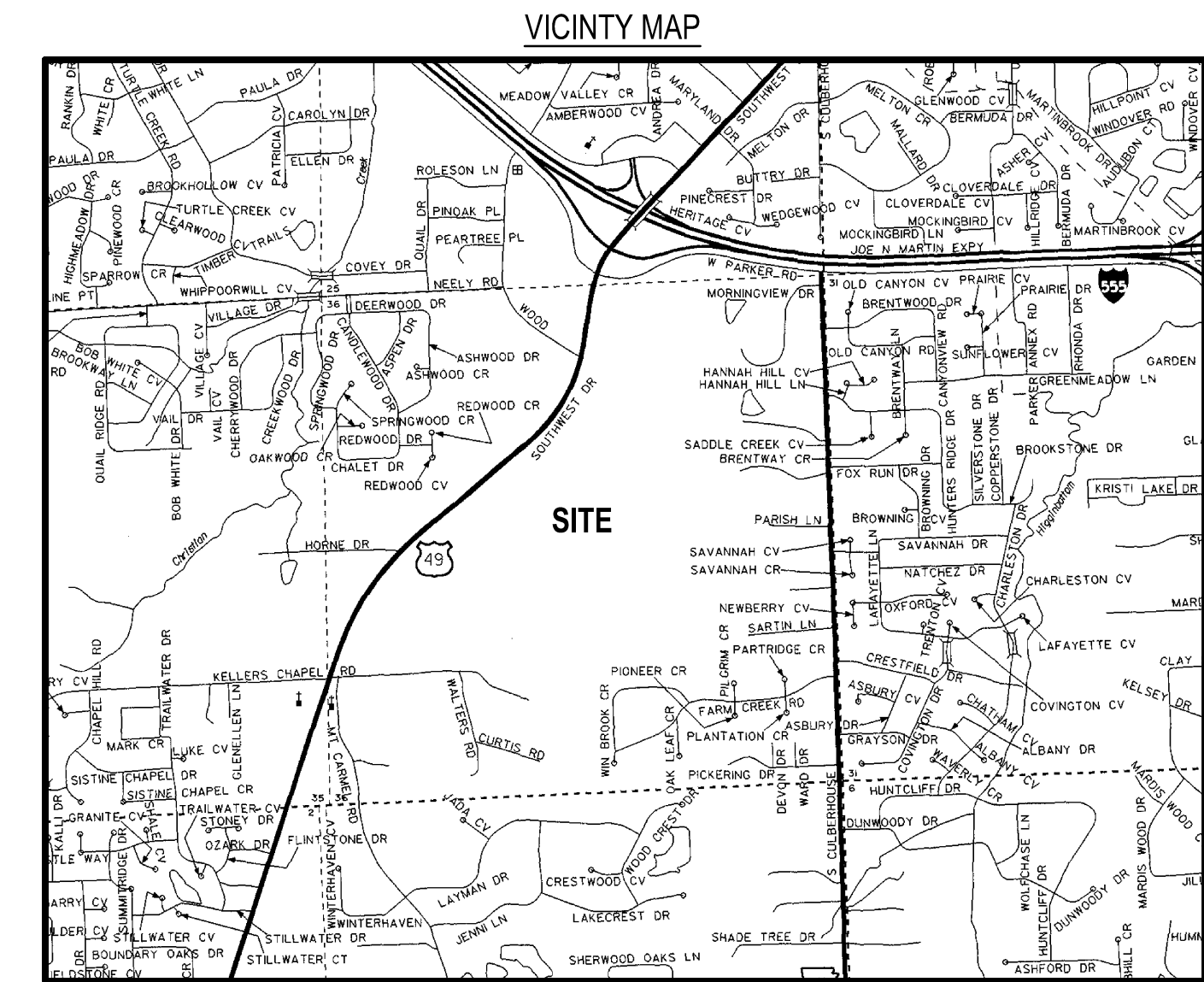

**REZONING REQUEST**  
118.34 ACRES  
C3-LUO TO PD-M

**US HIGHWAY 49  
(SOUTHWEST DRIVE)**

**HORNE DRIVE**

**JAXON DRIVE**

**JAXON LANE**

**KELLERS  
CHAPEL**

**WINBROOK  
CIRCLE**

**WALTERS RD.**

**MT. CARMEL RD.**



- LEGEND:**
- FOUND IRON PIPE AS NOTED
  - FOUND REBAR AS NOTED
  - ⊙ FOUND COTTON PICKER SPINDLE
  - ⊙ FOUND MAG NAIL
  - ⊙ FOUND IRON
  - ⊙ FOUND CONCRETE MON.
  - ⊙ SET COTTON PICKER SPINDLE
  - ⊙ SET 5/8" X 20" REBAR
  - ⊙ FOUND ARDOT MON/JALUM. CAP

- SURVEYOR'S NOTES:**
- Except as specifically stated or shown on this plat, this survey does not purport to reflect any of the following which may be applicable to the subject real estate: easements, other than possible easements which were visible at the time of making this survey, building setback lines, restrictive covenants, subdivision restrictions, zoning or other land use regulations, and any other facts which an accurate and current title search may disclose.
  - Surveyor has made no investigation or independent search for easements of record, encumbrances, restrictive covenants, ownership title evidence, or any other facts which an accurate and current title search may disclose.
  - Survey is valid only if print has original seal and signature of surveyor present.
  - Declaration is made to original purchaser of the survey. It is not transferable to additional institutions of subsequent owners.
  - The locations of underground utilities as shown hereon are based on above ground and visible structures. Locations of underground utilities/structures may vary from locations shown hereon. Additional buried utilities/structures may be encountered. No excavations were made during the progress of this survey to locate buried utilities/structures.
  - This survey meets current "Arkansas Minimum Standards for Property Surveys and Plats." Field work for this survey was completed on 03/16/2020.
  - Every document of record reviewed and considered as a part of this survey is noted hereon. No abstract of title, nor title commitment, nor results of title searches were furnished to the surveyor. There may exist other documents of record which would affect this parcel.
  - All buildings, surface and subsurface improvements on and adjacent to the site are not necessarily shown.
  - The location and/or existence of utility service lines to the property surveyed are unknown and are not shown.
  - No attempt has been made as a part of this boundary survey to obtain or show data concerning existence, size, depth, condition, capacity, or location of any utility or municipal/public service facility. For information regarding these utilities or facilities, please contact the appropriate agencies or other surveys.

**TRACT DESCRIPTION:**  
A part of the Southwest Quarter of the Northwest Quarter, a part of the Southeast Quarter of the Northwest Quarter, and a part of the Southwest Quarter of the Northeast Quarter and a part of the Northwest Quarter of the Southwest Quarter and a part of the Northeast Quarter of the Southwest Quarter, and a part of the Northwest Quarter of the Southeast Quarter, and all being in Section 36, Township 14 North, Range 3 East, Craighead County, Arkansas and being more particularly described as follows:  
  
COMMENCING at the Southwest corner of the Northwest Quarter of the Southwest Quarter of said Section 36; thence North 88°56'51" East, 181.29 feet to the POINT OF BEGINNING; Thence North 00°44'51" West, 24.92 feet; Thence North 87°12'05" West, 68.02 feet; Thence North 16°47'37" West, 24.92 feet; Thence North 19°52'49" East, 148.99 feet; Thence North 21°32'46" East, 163.36 feet; Thence North 23°49'52" East, 197.11 feet; Thence with a curve to the right, with a radius of 2864.79 feet, 92.83 feet, to a point which bears North 28°11'21" East, 92.83 feet from the last said point; Thence South 61°02'05" East, 9.95 feet; Thence with a curve to the right, with a radius of 2878.33 feet, 307.41 feet, to a point which bears North 32°07'04" East, 307.27 feet from the last said point; Thence North 37°17'30" East, 129.76 feet; Thence North 37°24'18" East, 59.69 feet; Thence North 41°11'15" East, 196.50 feet; Thence North 45°10'17" East, 196.38 feet; Thence North 49°17'02" East, 202.12 feet; Thence North 51°19'12" East, 568.98 feet; Thence North 56°40'44" East, 113.17 feet; Thence North 56°38'48" East, 209.43 feet; Thence North 40°22'27" East, 156.89 feet; Thence North 51°36'11" East, 247.58 feet; Thence North 38°23'34" West, 10.00 feet; Thence North 51°36'06" East, 171.70 feet; Thence with a curve to the left, with a radius of 1733.51 feet, 175.32 feet, to a point which bears North 48°19'18" East, 175.25 feet from the last said point; Thence South 37°12'39" East, 110.56 feet; Thence South 37°01'48" East, 143.79 feet; Thence South 89°00'31" West, 35.43 feet; Thence South 00°04'39" West, 208.81 feet; Thence North 89°05'10" East, 209.73 feet; Thence North 00°10'04" West, 623.18 feet; Thence North 88°59'44" East, 656.02 feet; Thence South 00°00'17" East, 1074.26 feet; Thence South 89°59'48" West, 319.95 feet; Thence South 00°39'38" West, 250.80 feet; Thence South 00°39'38" West, 1320.06 feet; Thence South 88°56'31" West, 329.96 feet; Thence South 88°48'06" West, 1314.89 feet; Thence South 88°56'51" West, 1135.34 feet to the POINT OF BEGINNING, containing 118.34 acres more or less and being subject to all rights of way and easements of record.

**REZONING PLAT - A PART OF SECTION 33  
TOWNSHIP 14 NORTH, RANGE 3 EAST  
JONESBORO, CRAIGHEAD COUNTY, ARKANSAS**  
PREPARED FOR: FISHER ARNOLD

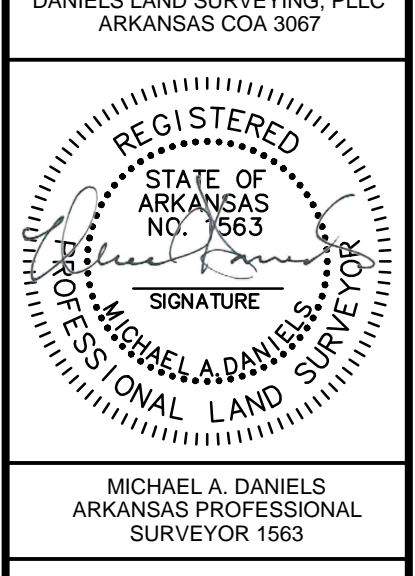
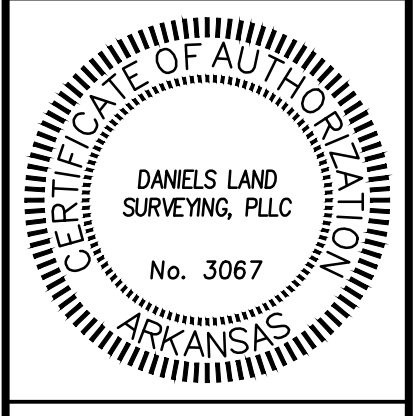

MICHAEL A. DANIELS  
ARKANSAS PROFESSIONAL  
SURVEYOR 1563

**REVISIONS**

#	DATE	NOTES	BY

FIELD BOOK (SC2)	SHEET 1 OF 1
DRAWN BY MAD	CHECKED BY
DATE 03/16/2020	SCALE 1"=200'
PROJECT NO. 093104	FILE NO. 14N03E36

STATE SURVEYOR CODE  
500-14N-03E-0-36-000-16-1563