

$\Delta = 20^{\circ}10'39''$   
 $R = 50.00$   
 $L = 17.61$

## DESCRIPTION

AN EASEMENT FOR DRAINAGE PURPOSES, LYING WITHIN LOT 9, ACCORDING TO GOTT REPLAT OF McDANIEL REPLAT OF A PART OF MARLO ACRES 5TH AND 6TH ADDITION AND LOT 13, BLOCK "G" OF MARLO ACRES 6TH ADDITION, AS RECORDED IN DEED RECORD BOOK 198, AT PAGE 61, IN AND FOR THE PUBLIC RECORDS OF CRAIGHEAD COUNTY, AT JONESBORO, ARKANSAS, BEING MORE PARTICULARLY DESCRIBED AS FOLLOWS:

COMMENCING AT THE NORTHWEST CORNER OF LOT 9 AFORESAID, THENCE SOUTH  $56^{\circ}36'00''$  EAST, ALONG THE NORTH LINE OF SAID LOT 9 (THE NORTH LINE OF SAID LOT 9 IS ASSUMED TO BEAR SOUTH  $56^{\circ}36'00''$  EAST AND ALL OTHER BEARING ARE RELATIVE THERETO), A DISTANCE OF 12.13 FEET TO THE POINT OF BEGINNING OF THE HEREIN DESCRIBED DRAINAGE EASEMENT: THENCE CONTINUE SOUTH  $56^{\circ}36'00''$  EAST, ALONG THE NORTH LINE OF SAID LOT 9, A DISTANCE OF 17.48 FEET TO A POINT: THENCE SOUTH  $02^{\circ}31'31''$  WEST, DEPARTING FROM SAID NORTH LINE, A DISTANCE OF 228.35 FEET TO A POINT LYING ON THE ARC OF A CURVE CONCAVE SOUTHWESTERLY, HAVING A RADIUS OF 50.00 FEET AND WHOSE RADIUS POINT BEARS SOUTH  $43^{\circ}42'38''$  WEST, SAID POINT ALSO LYING ON THE NORTH RIGHT-OF-WAY LINE OF MOCKINGBIRD LANE: THENCE NORTHWESTERLY, ALONG THE ARC OF SAID CURVE AND ALONG SAID NORTHERLY RIGHT-OF-WAY LINE, THROUGH A CENTRAL ANGLE OF  $20^{\circ}10'39''$ , A DISTANCE OF 17.61 FEET TO A POINT: THENCE NORTH  $02^{\circ}31'31''$  EAST, DEPARTING FROM SAID CURVE AND SAID NORTHERLY RIGHT-OF-WAY LINE, A DISTANCE OF 228.27 FEET TO THE POINT OF BEGINNING.

CONTAINING IN ALL 3,416 SQ.FT. OR 0.078 ACRES, MORE OR LESS.

SUBJECT TO EASEMENTS, RESTRICTIONS, RESERVATIONS AND RIGHTS-OF-WAY OF RECORD.

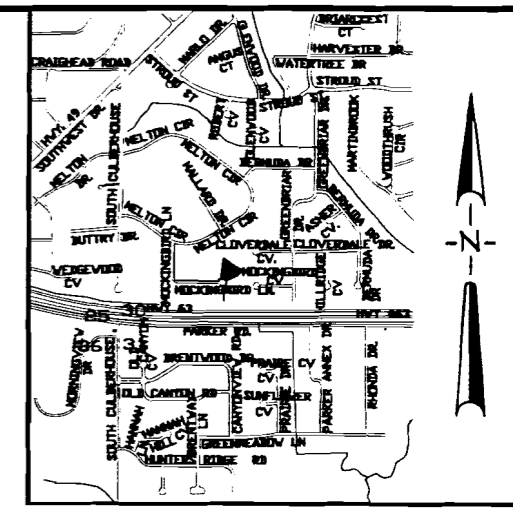

## VICINITY MAP

NOT TO SCALE

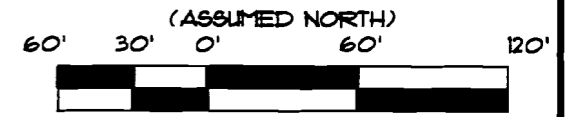
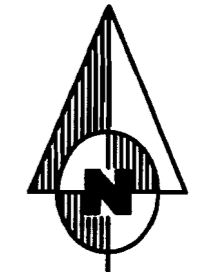

## GRAPHIC SCALE

IN FEET

## GENERAL NOTES

1. THIS DRAWING DOES NOT REPRESENT A BOUNDARY SURVEY.

DATE	REVISIONS	BY

**ASSOCIATED ENGINEERING AND TESTING, LLC**  
 CIVIL ENGINEERING, LAND SURVEYING AND MATERIALS TESTING  
 103 SOUTH CHURCH STREET - JONESBORO, AR 72401  
 PH: 870-932-3594 FAX: 870-935-1263

## EASEMENT DESCRIPTION SKETCH FOR CITY OF JONESBORO JONESBORO, ARKANSAS

DRAWN: JJN/CAD	CHECKED: KLS	DATE: 07/20/04	SHEET
SCALE: 1" = 60'	CADD FILE: 04216-01	DWG#: 0414303.0019	1 OF 1