

LEGAL DESCRIPTION:

Lots 7-13, Block A, Lots 1-7, Block B, Lots 1-15, Block C, Lots 1-15, Block D, and Lots 1-8, Block E, along with the right of ways of Beth Street, Carla Street, part of 5th Street and part of Bradley Street all in Northgate Addition, Jonesboro, Arkansas.

CERTIFICATE OF SURVEY:

To all parties interested in Title to these premises: I hereby certify that I have prior to this day made a survey of the above described property as shown on the Plat of Survey hereon. The property lines and corner monuments, to the best of my knowledge and ability, are correctly established: the improvements are as shown on the Plat of Survey. Encroachments, if any, as disclosed by Survey, are shown hereon.

NOTES:

- 1) BEARINGS BASED ON GPS OBSERVATION.
- 2) THE CLOSURE PRECISION OF THE PLAT IS IN EXCESS OF 1' IN 500,000'
- 3) THE RESEARCH COMPLETED FOR THIS SURVEY INCLUDES LEGAL DESCRIPTION PROVIDED.
- 4) ALL PINS SET ARE 1/2" REBAR, UNLESS NOTED OTHERWISE.
- 5) FLOOD PLAIN: THIS TRACT DOES LIE WITHIN THE 100-YR FLOOD PLAIN PER FLOOD INSURANCE RATE MAP OF CRAIGHEAD CO., ARK. AND INCORPORATED AREAS, COMMUNITY PANEL NO. 05031C0043 C, DATED 09/27/91.

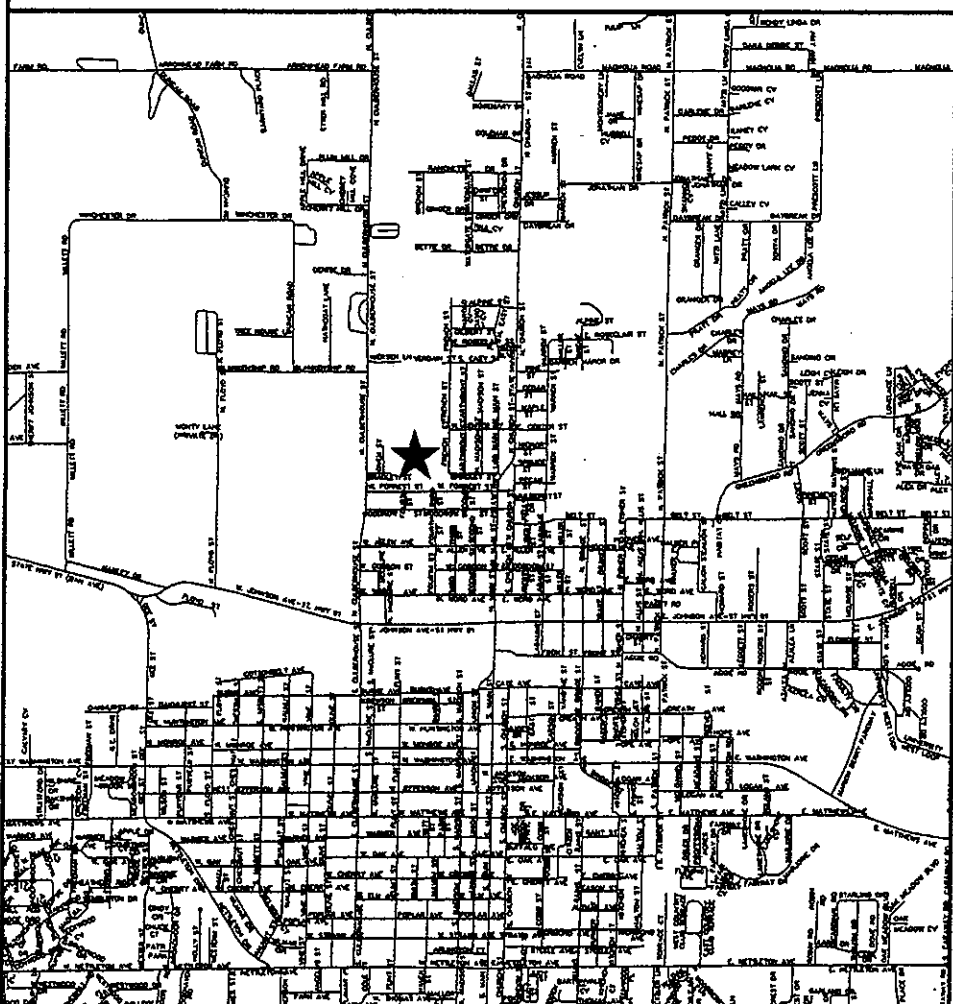

**EXISTING R-3 ZONING
REQUESTED PD-R ZONING**

ENGINEERS		PLANNERS		SURVEYORS	
Civilogic					
203 Southwest Dr. - Jonesboro, AR - (870) 932-7880 - www.civilogic.net					
REZONING PLAT PT. NORTHGATE ADDN FOR ROBERT ABRAHAM, M.D. JONESBORO, ARKANSAS					
Date	Scale	Job No.	Sheet		
06-12-13	1"=200'	113050	No.		
Section	Township	Range	County		
7	14N	04E	CRAIGHEAD	1 of 1	
ONLY COPIES WITH VIOLET COLORED SIGNATURE ARE ORIGINAL CIVILOGIC COPIES					