

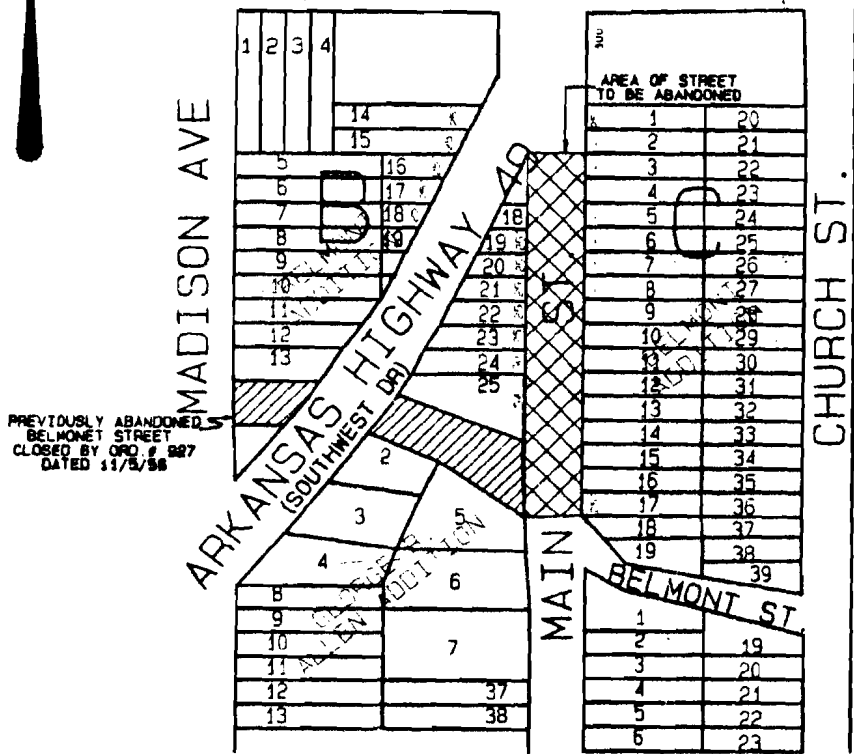

AS PER CITY OF JONESBORO
BLOCK MAPS.

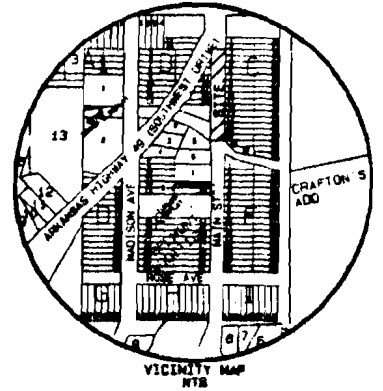

OWNERS OF ADJACENT LOTS AS FOLLOWS:

BLOCK "C" OF BELMONT ADDITION
 LOTS 3, 4, 12, 13 - JAMESENA LYLE MAY
 LOTS 5 & 6 - REAL ESTATE SOLUTIONS INC.
 LOTS 7-11; 14-19 - JUANITA EBBERT

BLOCK "B" OF BELMONT ADDITION
 LOTS 16 & 17 - JUANITA EBBERT
 LOTS 18 - 25 - FOWLER FOODS

ABANDONED BELMONT STREET - FOWLER FOODS

LEGAL DESCRIPTION:

ALL THAT PART OF MAIN STREET (60.00 FEET WIDE) WHICH LIES WEST OF LOTS 3 THROUGH 17 OF BLOCK "C" AND EAST OF LOTS 16 THROUGH 25 OF BLOCK "B" AND THAT PART OF THE ABANDONED BELMONT STREET LYING EAST OF ARKANSAS HIGHWAY 49 (SOUTHWEST DRIVE) AND WEST OF MAIN STREET. ALL IN BELMONT ADDITION TO THE CITY OF JONESBORO, ARKANSAS.

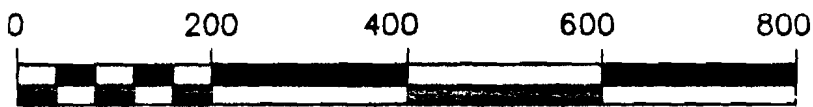

GRAPHIC SCALE 1"=200'

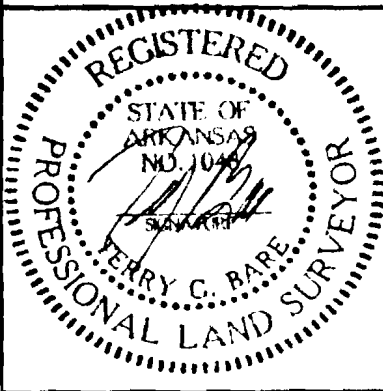

CLIENT
FOWLER FOODS

STREET ABANDONMENT

THAT PART OF MAIN STREET LYING WEST OF LOTS 3 - 17, BLOCK "C" AND EAST OF THE ABANDONED BELMONT STREET AND LOTS 16 - 25, BLOCK "B" OF BELMONT'S ADDITION TO JONESBORO, ARKANSAS

HAYWOOD, KENWARD, BARE & ASSOCIATES, INC.
 CIVIL ENGINEERING - SURVEYING - PLANNING
 3301 E. HIGHLAND DRIVE
 JONESBORO, ARKANSAS 72401
 TEL 870-932-2019 FAX 870-932-1078

REVISIONS

DATE	BY	DESCRIPTION

DRAWN BY	SHEET
J. HOOTS	1 OF 1
DATE	SCALE
8/9/99	1" = 200'
JOB NO.	DRAWING NO.
300261	G-207