

Jonesboro Land Bank



History

- Established by City Council in December 2017
- Commissioners were appointed in April 2018
- First meeting was held May 2018
- Approved our first acquisition December 2018

Commissioners

- **Dr. Bob Warner**; Chair; Ward 1 Rep
- **James Hollywood**; Vice Chair; Ward 2 Rep
- **Becky Durham**; Ward 3
- **Jeffrey Herndon**; Low Income Housing
- **Brent Martin**; Officer of a Financial Institution
- **Corey Mills**; Citizens Fair Housing Board
- **Ray Osment**; Housing Industry
- **Jeremy Moore**; Ward 4 Rep
- **Dennis Zolper**; JURHA
- **Heather Owens**; City Attorney
- **Deanna Hornback**; Finance
- **Jonathan Smith**; Director

The purpose of the Commission is to reverse urban blight, increase homeownership and the stability of property values, provide affordable housing, improve the health and safety of neighborhoods within the city, and maintain the architectural fabric of the community

Concentrating our resources

- Established 3 “focus areas”
 - North Jonesboro
 - West End
 - Old Nettleton Area
- Why these areas?
 - Recommended in the Master Land Use Plan
 - Areas of high concentration of liens and existing code violations
 - Established neighborhood associations

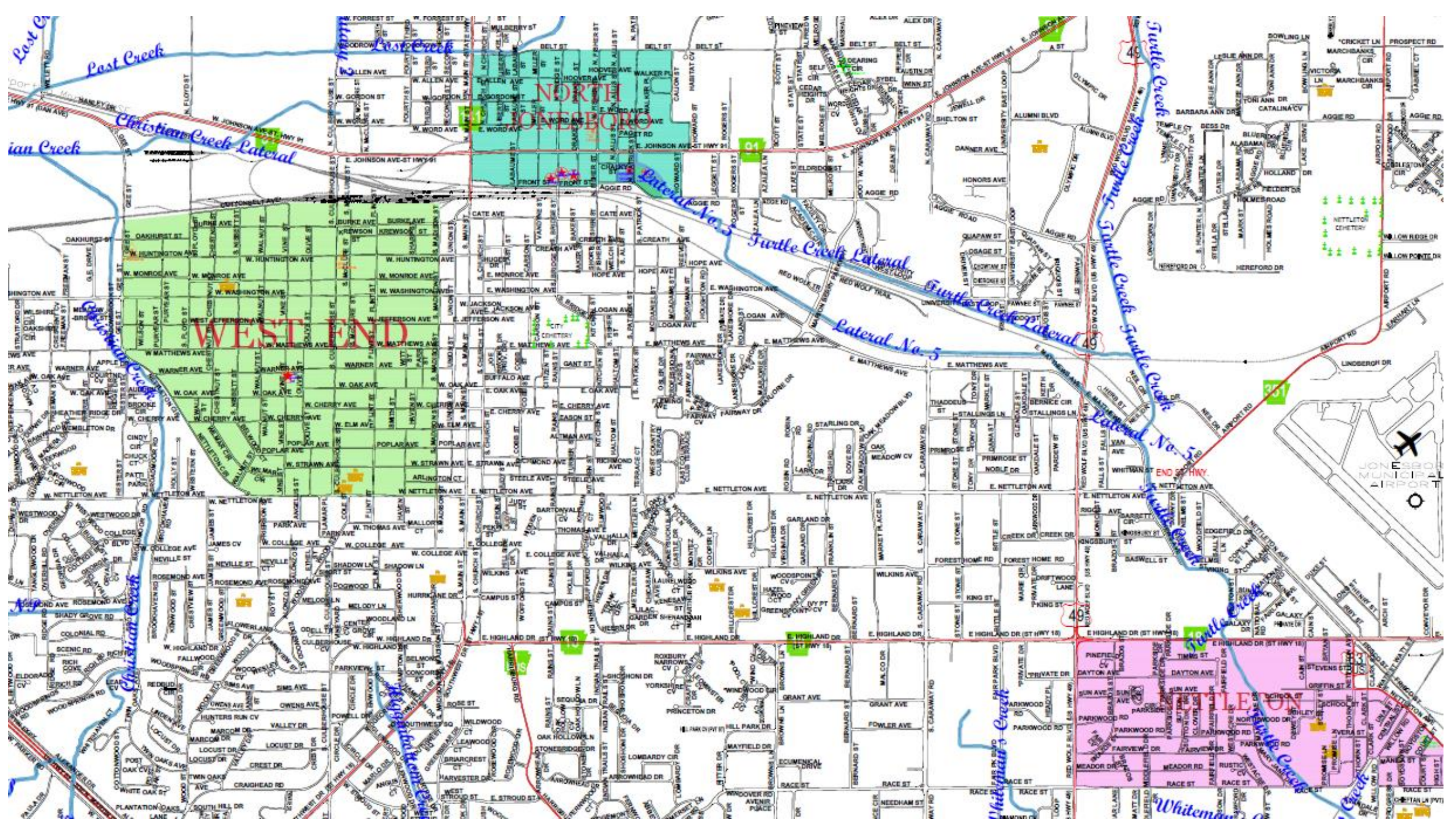

NORTH JONESBORO

WEST END

LITTLETON

JONESBORO MUNICIPAL AIRPORT

Last Creek
Christian Creek Lateral

Furtle Creek Lateral
Lateral No. 5

Furtle Creek
Lateral No. 5
Whiteman's Creek

Christian Creek
Whiteman's Creek

Whiteman's Creek

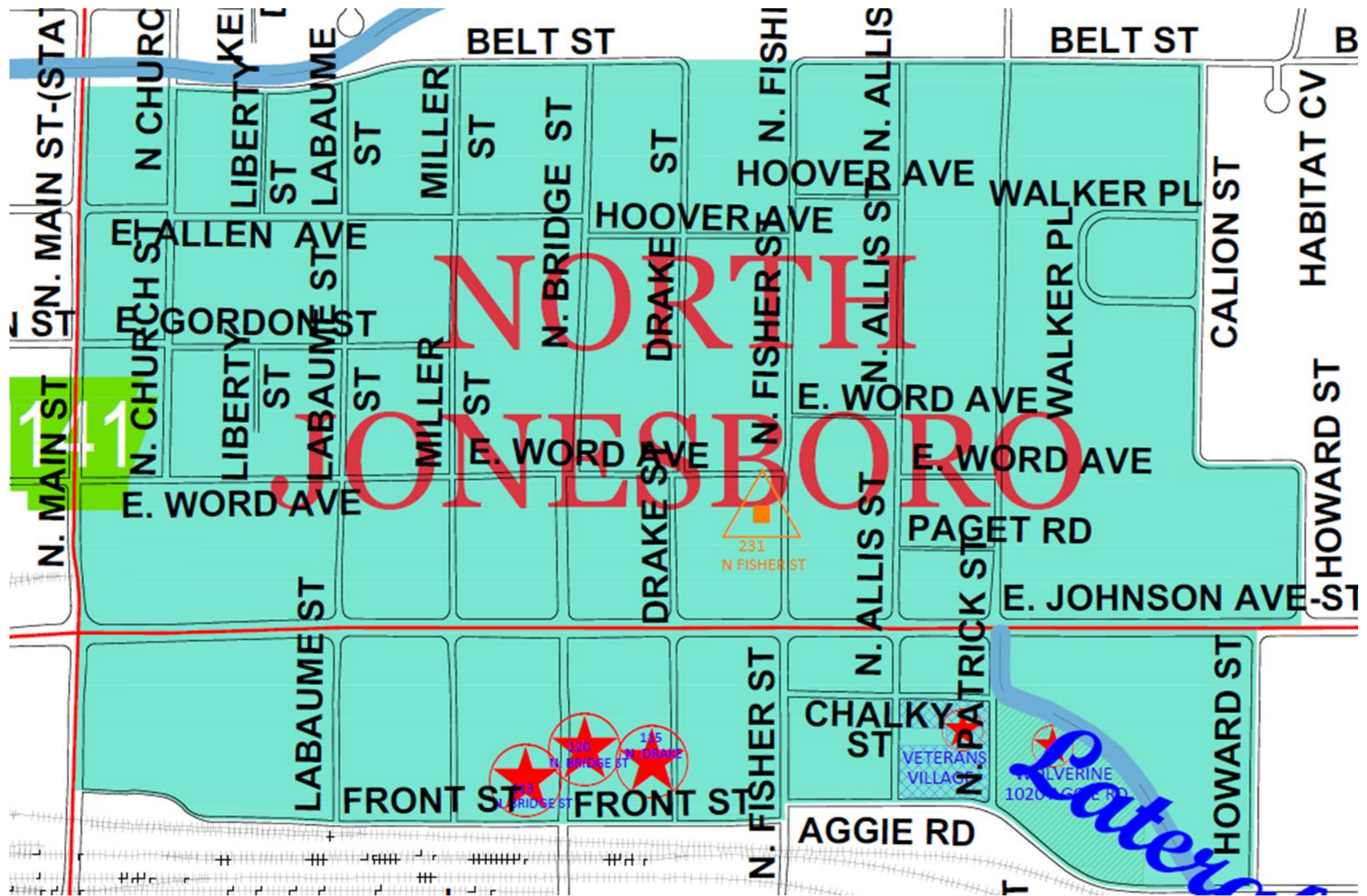

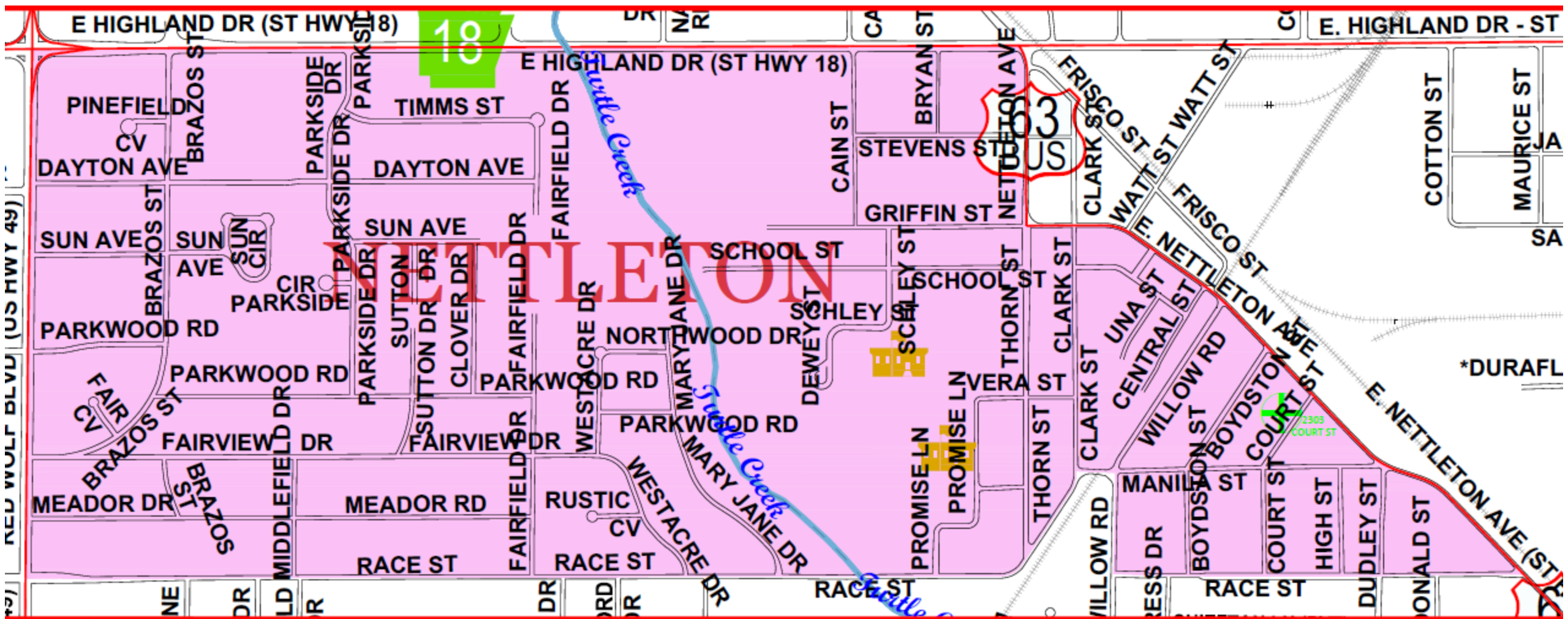

18

3

NETTLETON

2303 COURT ST

*DURAFL

Property in our Inventory

- 115 North Drake (Donation)
- 120 North Bridge (Liens, Delinquent Taxes)
- 113 North Bridge (Liens)
- 827 Warner (Abandon house)



Statement of Expenses

File Number: 18-075506-300

To:

City of Jonesboro, Arkansas

From:

Lenders Title Company
2207 Fowler Avenue
Jonesboro, Arkansas 72401

Entry	Appraised	Assessed
Land:	5,000	1,000
Improvements:	31,850	6,370
Total Value:	36,850	7,370
Taxable Value:		6,080
Millage:		0.0422
Estimated Taxes ? :		\$256.58
Assessment Year:		2018

Amount	Total
834.73	\$834.73
20.00	\$20.00
129.15	\$129.15
225.00	\$225.00
Total	\$1,208.90

Entry	Appraised	Assessed
Land:	5,000	1,000
Improvements:	0	0
Total Value:	5,000	1,000
Taxable Value:		1,000
Millage:		0.0422
Estimated Taxes ? :		\$42.20
Assessment Year:		2018

For Office Use Only:			
Taxes:	253.20	St. Fees:	135.05
Penalty:	21.10	Ct. Fees	8,580.98
Interest:	43.59	Total:	9,035.82
Amount Rec'd	_____	Date Rec'd	_____
Receipt No.	_____	Deed No.	_____

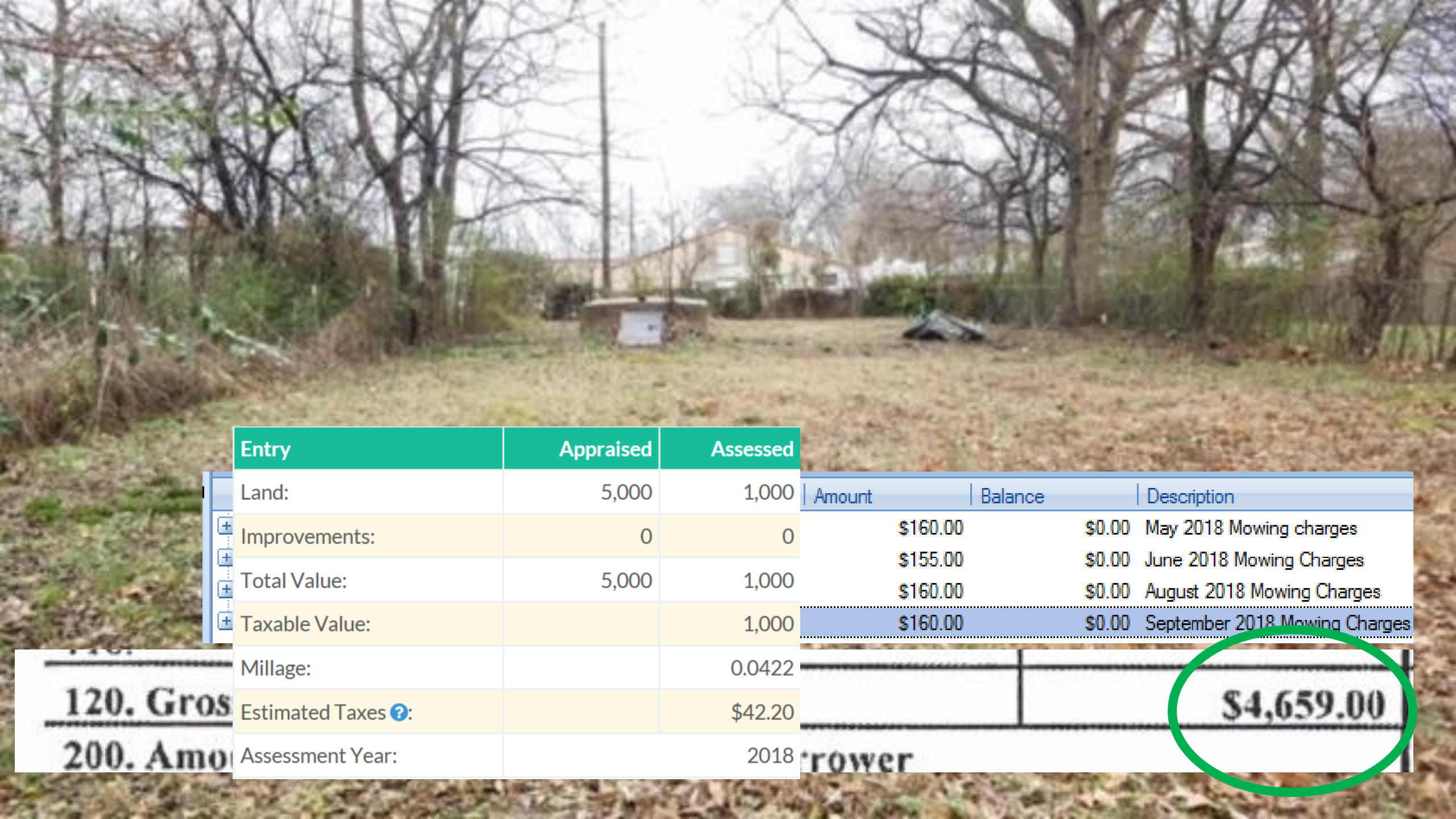

Entry	Appraised	Assessed
Land:	5,000	1,000
Improvements:	0	0
Total Value:	5,000	1,000
Taxable Value:		1,000
Millage:		0.0422
Estimated Taxes ? :		\$42.20
Assessment Year:		2018

Amount	Balance	Description
\$160.00	\$0.00	May 2018 Mowing charges
\$155.00	\$0.00	June 2018 Mowing Charges
\$160.00	\$0.00	August 2018 Mowing Charges
\$160.00	\$0.00	September 2018 Mowing Charges

120. Gros
200. Amo

		\$4,659.00
--	--	-------------------

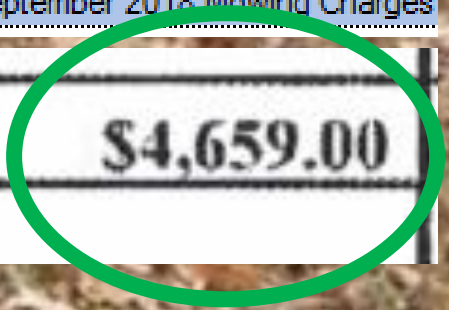



Entry	Appraised	Assessed
Land:	8,000	1,600
Improvements:	21,600	4,320
Total Value:	29,600	5,920
Taxable Value:		5,920
Millage:		0.0422
Estimated Taxes ? :		\$249.82
Assessment Year:		2018

		411. O
		412.
		413.
	\$249.82	414.
		415.
		416.
	\$10,962.82	410. G
		500. Re

TRUE COST TO THE CITY

ADDRESS	COST
115 NORTH DRAKE	\$1,208.90
120 NORTH BRIDGE	$\begin{array}{r} \$9,035.82 \\ - \underline{\$8,580.98} \\ \hline \end{array}$ \$454.84
113 NORTH BRIDGE	$\begin{array}{r} \$4,659.00 \\ - \underline{\$635.00} \\ \hline \end{array}$ \$4024.00
827 WARNER	\$10,962.82
501 MARSHALL (\$3,030.88)	-
TOTAL TO DATE	\$15,570.56

NEXT STEPS



- Lien Foreclosures
- Draft an ordinance to address boarded-up and abandon houses
- Continue to look for additional inventory
- Encourage the adoption of future Land Use Committee Recommendations ; specifically Form Based Codes and Redevelopment Areas

