

**LEGEND**

- FOUND IRON PIPE (AS NOTED)
- FOUND REBAR (AS NOTED)
- △ CALCULATED CORNER
- SET REBAR W/ CAP STAMPED B. WOOD PS #1817
- - - BOUNDARY LINE
- - - EASEMENT LINE
- - - ROAD CENTERLINE

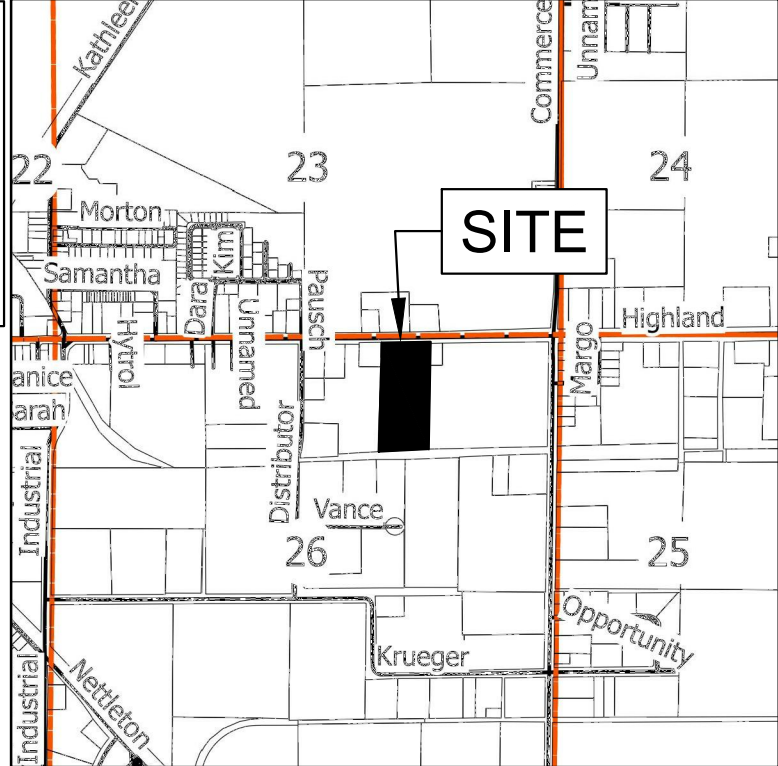

**SURVEYOR'S CERTIFICATION:**  
 I, BRANDON G. WOOD, CERTIFY THAT THE SURVEY SHOWN HERON WAS MADE IN ACCORDANCE WITH THE REQUIREMENTS OF "ARKANSAS STANDARDS OF PRACTICE FOR PROPERTY BOUNDARY SURVEYS AND PLATS".  
 BRANDON G. WOOD, P.S. # 1817

**DESCRIPTION:**  
 LOT 1 OF SAI REAL ESTATE'S HIGHLAND REPLAT, AS RECORDED IN DOCUMENT # 2022R-009996, PLAT BOOK 'C' PAGE 375, RECORDED IN THE CRAIGHEAD COUNTY CIRCUIT CLERK'S OFFICE IN JONESBORO, CRAIGHEAD COUNTY, ARKANSAS.

- SURVEYOR'S NOTES:**
1. SURVEYOR HAS MADE NO INVESTIGATION OR INDEPENDENT SEARCH FOR EASEMENTS OF RECORD OR ANY OTHER FACTS THAT AN ACCURATE TITLE SEARCH MAY DISCLOSE.
  2. THE FOLLOWING DOCUMENTS WERE USED AS REFERENCES FOR THIS SURVEY:
    - a. SURVEY PLAT - MAYME GRIFFIN / LIBERTY BANK MINOR PLAT, BY G. HAMMAN PS. # 1273, CRAIGHEAD COUNTY COURTHOUSE, PLAT BOOK 'C', PAGE 175, DATED 06/30/2005.
    - b. DEED - SAI REAL ESTATE LLC, CRAIGHEAD COUNTY COURTHOUSE, DOCUMENT # 2017R-024043, DATED 12/29/2017.

**OWNER'S CERTIFICATION**

WE, DO HEREBY CERTIFY THAT WE ARE THE OWNERS OF THE ABOVE DESCRIBED PROPERTY AND HAVE CAUSED SAME TO BE SURVEYED AND REQUEST A REZONING OF SAID PROPERTY FROM I-1 TO C-3 .

PRINTED NAME: \_\_\_\_\_ PRINTED NAME: \_\_\_\_\_  
 SIGNATURE: \_\_\_\_\_ SIGNATURE: \_\_\_\_\_  
 TITLE: \_\_\_\_\_ TITLE: \_\_\_\_\_



BRANDON G. WOOD  
 ARKANSAS SURVEYOR  
 # 1817

**REZONING PLAT: I-1 REQUESTING C-3**  
**LOT 1 OF SAI REAL ESTATE'S HIGHLAND REPLAT**  
 JONESBORO, CRAIGHEAD COUNTY, ARKANSAS  
 CLIENT: SAI REAL ESTATE, LLC

DATE: 04/05/2022  
 REV:

DRAWN BY: BGW

BRANDON WOOD, P.E., P.S.  
 ENGINEERING & SURVEYING  
 112 CR. 7025  
 BROOKLAND, AR 72417  
 PH: (670) 950-5504  
 FAX: (670) 972-5027  
 BWOOD@WOODENGR.COM  
 WWW.BWOODENGINEERING.COM

