

LINE TABLE:

LINE #	DIRECTION	LENGTH
L1	S32°20'12"W	43.20'
L2	S01°56'41"E	8.80'
L3	N89°10'32"E	24.08'
L4	S01°56'41"E	8.78'
L5	N89°10'32"E	24.08'
L6	S01°56'41"E	8.83'
L7	N89°10'32"E	24.08'

CURVE TABLE:

CURVE #	LENGTH	RADIUS	DELTA	CHORD DIRECTION	CHORD LENGTH
C1	42.10'	27.41'	87°59'48"	S45°10'12"W	38.08'
C2	236.96'	300.00'	45°15'18"	S24°34'20"E	230.84'
C3	152.28'	200.00'	43°37'29"	S69°00'44"E	148.63'
C4	213.26'	270.00'	45°15'18"	S24°34'20"E	207.76'
C5	129.44'	170.00'	43°37'29"	S69°00'44"E	126.33'
C6	260.65'	330.00'	45°15'18"	S24°34'20"E	253.93'
C7	175.12'	230.00'	43°37'29"	S69°00'44"E	170.92'

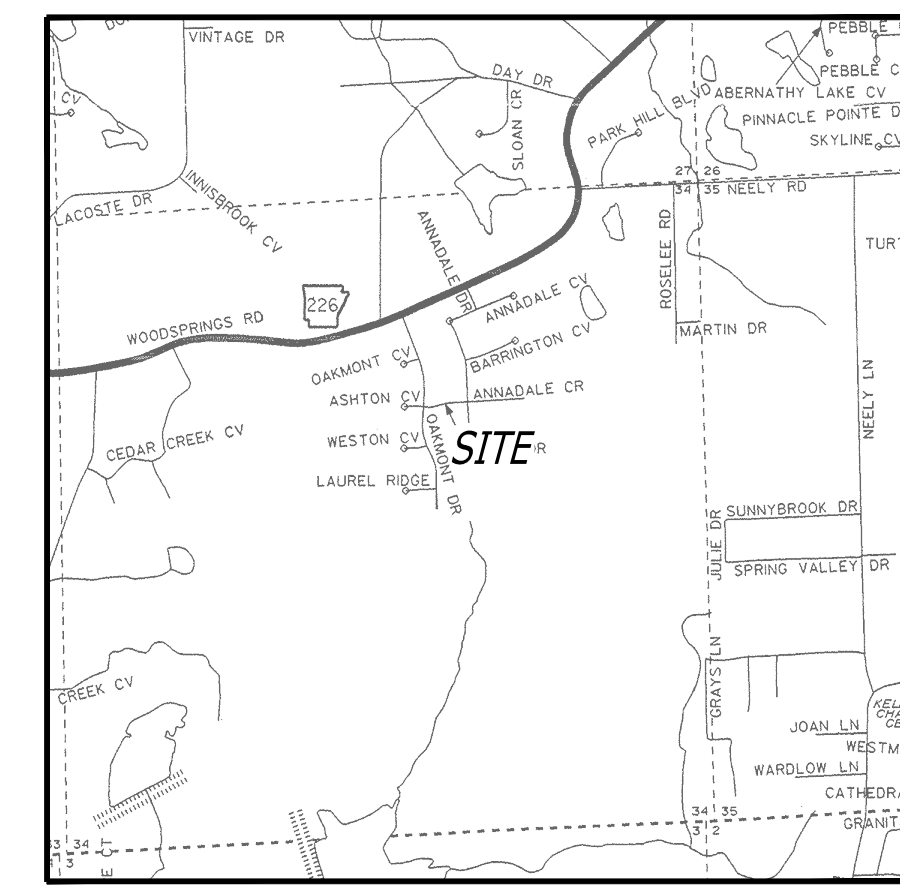

VICINITY MAP
(N.T.S)

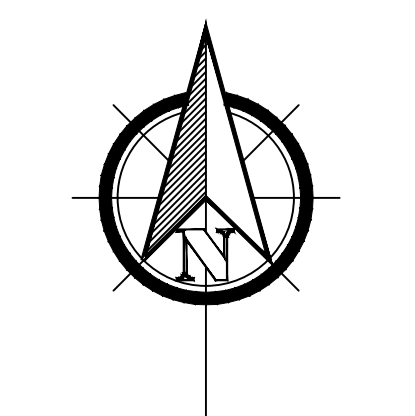

BEARINGS BASED ON ARKANSAS STATE PLANE GRID NORTH ZONE (0301)

UTILITY PROVIDERS:

ELECTRIC, WATER & SEWER:

CITY WATER & LIGHT
400 EAST MONROE
JONESBORO, AR 72401
(870)-935-5581

NATURAL GAS:

CENTERPOINT ENERGY
3013 OLD FEED HOUSE ROAD
JONESBORO, AR 72404
(870)-972-6682

TELECOMMUNICATIONS:

AT&T ARKANSAS
723 SOUTH CHURCH
JONESBORO, AR 72401
1-800-464-7928

SUDDENLINK COMMUNICATIONS

1520 SOUTH CARAWAY ROAD
JONESBORO, AR 72401
(870)-935-3615

RITTER COMMUNICATIONS

2400 RITTER DRIVE
(870)-336-3434

ZONING NOTES:

- CURRENT ZONING CLASSIFICATION:
R-1, SINGLE-FAMILY MEDIUM DENSITY DISTRICT.
- R-1 ZONING RESTRICTIONS:
 - STREET SETBACK - 25'
 - SIDE SETBACK - 7.5'
 - REAR SETBACK - 25'
 - MAXIMUM LOT COVERAGE - 35%
 - MAXIMUM HEIGHT LIMITATION - 35'
- FOR MORE INFORMATION CONTACT THE CITY OF JONESBORO PLANNING AND ZONING DEPARTMENT @ (870) 932-0406.

POINT OF BEGINNING

SOUTHEAST CORNER, LOT 22, BLOCK D, BARRINGTON PARK, PHASE VII (CABINET "C", PAGE 245)

SURVEYOR'S NOTES:

- SURVEYOR HAS MADE NO INVESTIGATION OR INDEPENDENT SEARCH FOR EASEMENTS OF RECORD OR ANY OTHER FACTS WHICH AN ACCURATE TITLE SEARCH MAY DISCLOSE.
- BASIS OF BEARINGS: ARKANSAS STATE PLANE GRID NORTH (0301).
- THE FOLLOWING DOCUMENTS WERE USED TO COMPLETE THIS SURVEY:
 - RECORD PLAT, BARRINGTON PARK SUBDIVISION, BY HERBERT C. HIME, P.S. 1142, RECORDED IN CABINET "C", PAGE 140, DATED APRIL 10, 2003.
 - RECORD PLAT, BARRINGTON PARK SUBDIVISION, PHASE II, REVISED, BY HERBERT C. HIME, P.S. 1142, RECORDED IN CABINET "C", PAGE 148, DATED SEPTEMBER 15, 2003.
 - RECORD PLAT, BARRINGTON PARK SUBDIVISION, PHASE III, REVISED, BY TERRY G. BARE, P.S. 1048, RECORDED IN CABINET "C", PAGE 190, DATED JANUARY 03, 2008.
 - RECORD PLAT, BARRINGTON PARK SUBDIVISION, PHASE VII, BY HERBERT C. HIME, P.S. 1142, RECORDED IN CABINET "C", PAGE 245, DATED JANUARY 03, 2014.
 - RECORD PLAT, BARRINGTON PARK SUBDIVISION, PHASE IX, BY HERBERT C. HIME, P.S. 1142, RECORDED IN CABINET "C", PAGE 272, DATED DECEMBER 06, 2016.
 - QUITCLAIM DEED, KELLER TO THE KENSINGTON DEVELOPMENT CORPORATION, RECORDED IN BOOK 625, PAGE 201, DATED APRIL 26, 2002.
 - QUITCLAIM DEED, KELLER TO THE KENSINGTON DEVELOPMENT CORPORATION, RECORDED IN BOOK 625, PAGE 204, DATED APRIL 26, 2002.
 - WARRANTY DEED, LAMASTUS TO THE KENSINGTON DEVELOPMENT CORPORATION, RECORDED IN BOOK 625, PAGE 207, DATED APRIL 26, 2002.
 - WARRANTY DEED, KELLER TO THE KENSINGTON DEVELOPMENT CORPORATION, RECORDED IN BOOK 625, PAGE 210, DATED APRIL 26, 2002.
 - SANITARY SEWER EASEMENT, ABEL TO CITY WATER AND LIGHT PLANT OF JONESBORO, RECORDED IN BOOK 658, PAGE 17, DATED NOVEMBER 04, 2003.
 - SANITARY SEWER EASEMENT, ABEL TO CITY WATER AND LIGHT PLANT OF JONESBORO, CRAIGHEAD COUNTY DOCUMENT NO. JB2015R-019042, DATED DECEMBER 09, 2015.
- THE SUBJECT PROPERTY LIES OUTSIDE THE 100 YEAR SPECIAL FLOOD HAZARD ZONE, AS SHOWN ON FEMA FLOOD INSURANCE RATE MAP: PANEL NO. 05031C0150C, EFFECTIVE DATE SEPTEMBER 27, 1991.
- BUILDINGS AND IMPROVEMENTS SURFACE AND/OR SUBSURFACE ON AND ADJACENT TO THE SUBJECT PROPERTY ARE NOT NECESSARILY SHOWN ON THIS BOUNDARY SURVEY.
- THE EXISTENCE AND/OR LOCATION OF UTILITY SERVICES TO THE SUBJECT PROPERTY ARE UNKNOWN AND ARE NOT SHOWN ON THIS BOUNDARY SURVEY.
- FIELD WORK WAS COMPLETED ON APRIL 07, 2022.

CERTIFICATE OF SUBDIVISION:

THIS IS TO CERTIFY THAT RIDGE SURVEYING AND CONSULTING, PLLC., PROFESSIONAL LAND SURVEYORS, HAVE SUBDIVIDED THE FOLLOWING DESCRIBED PARCEL OF LAND:

PART OF THE SOUTHWEST QUARTER OF THE NORTHEAST QUARTER OF SECTION 34, TOWNSHIP 14 NORTH, RANGE 03 EAST, JONESBORO, CRAIGHEAD COUNTY, ARKANSAS, BEING MORE PARTICULARLY DESCRIBED AS FOLLOWS:

BEGINNING AT THE SOUTHEAST CORNER OF LOT 22, BLOCK D OF BARRINGTON PARK, PHASE VII TO THE CITY OF JONESBORO, CRAIGHEAD COUNTY, ARKANSAS; THENCE SOUTH 01°07'56" WEST, 185.06 FEET TO A POINT ON A CURVE TO RIGHT; THENCE SOUTHEASTERLY ALONG SAID CURVE WITH A CENTRAL ANGLE OF 87°59'48", A RADIUS OF 27.41 FEET, 42.10 FEET TO A POINT THAT BEARS SOUTHWEST 45°10'12" WEST, 38.08 FEET FROM THE LAST SAID POINT; THENCE SOUTH 00°49'28" EAST, 199.51 FEET; THENCE SOUTH 89°30'01" WEST, 339.80 FEET; THENCE NORTH 01°15'38" WEST, 137.65 FEET; THENCE NORTH 56°45'32" WEST, 200.32 FEET; THENCE NORTH 34°06'30" WEST, 238.33 FEET; THENCE NORTH 29°11'38" WEST, 156.44 FEET; THENCE NORTH 05°03'21" EAST, 55.82 FEET; THENCE NORTH 88°05'59" EAST, 388.67 FEET; THENCE SOUTH 51°47'45" EAST, 56.33 FEET; THENCE SOUTH 64°58'50" EAST, 281.59 FEET; THENCE SOUTH 42°37'56" WEST, 95.07 FEET; THENCE SOUTH 32°20'12" WEST, 43.20 FEET; THENCE SOUTH 75°24'12" EAST, 204.39 FEET TO THE POINT OF BEGINNING, CONTAINING 8.33 ACRES (362,928 SQ. FT.), MORE OR LESS, SUBJECT TO ALL RIGHTS-OF-WAY AND EASEMENTS OF RECORD.

**SAYD PLAT SHALL HERE-IN AFTER BE DESIGNATED AND REFERRED TO AS:
BARRINGTON PARK SUBDIVISION, PHASE X
TO CITY OF JONESBORO, CRAIGHEAD COUNTY, ARKANSAS.**

WE BEING THE OWNERS DO HEREBY CERTIFY THAT WE ARE THE OWNERS OF THE PROPERTY DESCRIBED HEREON AND THAT WE ADOPT THE PLAN OF SUBDIVISION AND/OR EXTINGUISHED LOT LINES AND DEDICATE THE PERPETUAL USE OF ALL STREETS AND EASEMENTS AS NOTED.

NAME: _____, SIGNATURE: _____, DATE: _____

NAME: _____, SIGNATURE: _____, DATE: _____

SURVEYOR'S CERTIFICATION:

I, JOSHUA J. NEELY, CERTIFY THAT THE SURVEY SHOWN HEREON WAS MADE IN ACCORDANCE WITH THE REQUIREMENTS OF "ARKANSAS STANDARDS OF PRACTICE FOR PROPERTY BOUNDARY SURVEYS AND PLATS"; AND THAT THE ABOVE DESCRIBED TRACT WAS SURVEYED UNDER MY DIRECT SUPERVISION.



RECORD PLAT
CLIENT: KENSINGTON DEVELOPMENT CORPORATION
BARRINGTON PARK SUBDIVISION, PHASE X
TO THE CITY OF JONESBORO, CRAIGHEAD COUNTY, ARKANSAS

RIDGE SURVEYING & CONSULTING PLLC		404 Creath Ave., Suite B Jonesboro, AR 72401		870-203-9940 www.ridgesurveying.net	
DRAWING INFO	REVISIONS	DATE	BY	DESCRIPTION	
DRAWN BY:					
DATE:					
SCALE:					
CJOB NO.					

PRELIMINARY

RIDGE SURVEYING & CONSULTING, PLLC.
ARKANSAS - 2946

PRELIMINARY

JOSHUA J. NEELY - SURVEYOR
ARKANSAS - P.S. 1841

500-14N-03E-0-34-130-16-1841