

A PART OF THE NW 1/4 OF THE SE 1/4 SEC 36, TWP 14N, RGE 3E JONESBORO, CRAIGHEAD COUNTY, ARKANSAS

PREPARED FOR: REBECCA & JAMES HARDIN

01-143361-01800
N/F SOUTHERN HILLS REAL ESTATE, LLC
NOT PLATTED C3-LUO ZONING
SW 1/4 NE 1/4
21.54 ACRES±

BASIS OF BEARINGS:
ARKANSAS STATE PLANE COORDINATE
SYSTEM NORTH ZONE (301)
LAT. 35°47'46.08234", LONG. -90°43'52.37010"
COMB. SCALE FACTOR: 1.00007267036962
(GRID TO GROUND - DISTANCES ARE REPORTED IN GROUND)
CONVERGENCE ANGLE: N 00°44'18" W

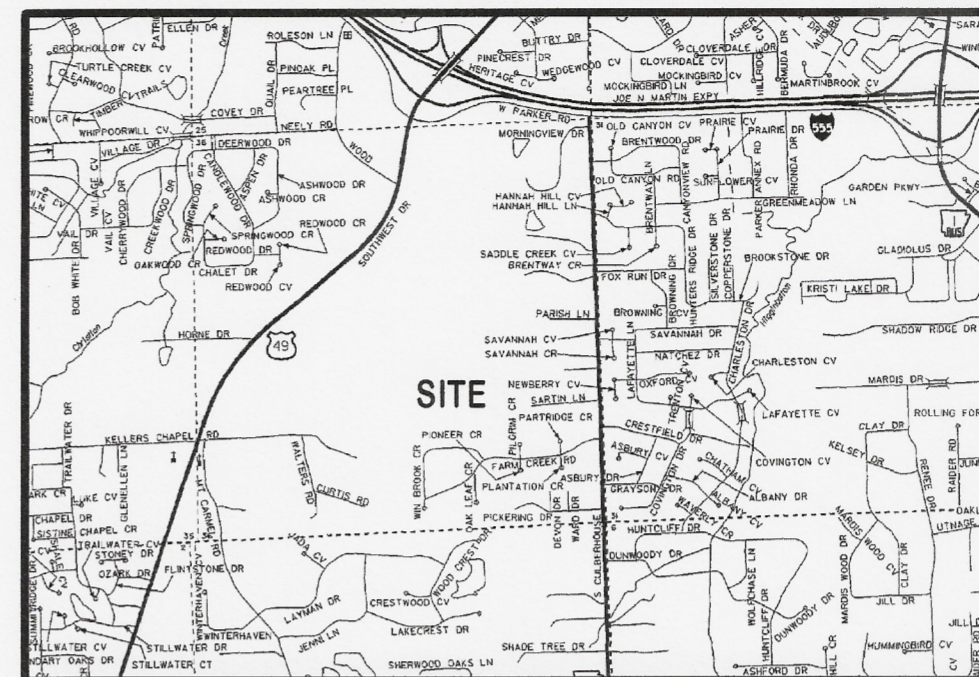
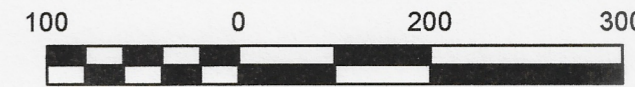

SURVEYOR'S NOTES:

- Except as specifically stated or shown on this plat, this survey does not purport to reflect any of the following which may be applicable to the subject real estate: easements, other than possible easements which were visible at the time of making this survey; building setback lines; restrictive covenants; subdivision restrictions; zoning or other land use regulations, and any other facts which an accurate and current title search may disclose.
- Surveyor has made no investigation or independent search for easements of record, encumbrances, restrictive covenants, ownership title evidence, or any other facts which an accurate and current title search may disclose.
- Plat represents a boundary survey of a parcel described in Craighead County Deed Records at Book JB2015R, Page 006149.
- Survey is valid only if print has original seal and signature of surveyor present.
- Declaration is made to original purchaser of the survey. It is not transferable to additional institutions or subsequent owners.
- The locations of underground utilities as shown hereon are based on above ground and visible structures. Locations of underground utilities/structures may vary from locations shown hereon. Additional buried utilities/structures may be encountered. No excavations were made during the progress of this survey to locate buried utilities/structures.
- This survey meets current "Arkansas Minimum Standards for Property Surveys and Plats." Field work for this survey was completed on 1/15/2021.
- Every document of record reviewed and considered as a part of this survey is noted hereon. No abstract of title, nor title commitment, nor results of title searches were furnished to the surveyor. There may exist other documents of record which would affect this parcel.
- All buildings, surface and subsurface improvements on and adjacent to the site are not necessarily shown.
- The location and/or existence of utility service lines to the property surveyed are unknown and are not shown.
- No attempt has been made as a part of this boundary survey to obtain or show data concerning existence, size, depth, condition, capacity, or location of any utility or municipal/public service facility. For information regarding these utilities or facilities, please contact the appropriate agencies or other surveys.

TRACT DESCRIPTION:

A part of the Northwest Quarter of the Southeast Quarter of Section 36, Township 14 North, Range 3 East, Craighead County Arkansas, being more particularly described as follows:
BEGINNING at the Southeast Corner of Lot 1 Block G of Southern Hills; Thence North 00°39'38" East, 603.43 feet to the **POINT OF BEGINNING**; Thence North 00°39'38" East, 245.94 feet; Thence with a curve to the right, with a radius of 1274.89 feet, 62.41 feet, to a point which bears South 80°11'05" East, 62.40 feet from the last said point; Thence South 75°17'56" East, 867.41 feet; Thence with a curve to the left, with a radius of 1000.08 feet, 83.37 feet, to a point which bears South 77°41'14" East, 83.35 feet from the last said point; Thence South 00°09'02" East, 172.90 feet; Thence South 89°20'58" W, 159.83 feet; Thence with a curve to the right, with a radius of 198.51, 59.69 feet to a point which bears South 07°51'57" West, 59.47 feet from the last said point; Thence North 75°17'56" West, 682.99 feet; Thence North 00°11'54" East, 62.36 feet; Thence North 89°48'06" West, 156.84 feet to the **POINT OF BEGINNING**, containing 5.73 acres more or less and being subject to all right of way and easements of record.

LEGEND

- CALCULATED POINT
- FOUND REBAR AS NOTED
- FOUND 1-1/4" IRON PIPE
- SUBJECT PROPERTY
- ADJACENT PROPERTY
- EASEMENT AS NOTED
- OVERHEAD ELECTRIC
- PROPOSED DEVELOPMENT

DANIELS
LAND SURVEYING PLLC
2713 PAULA DRIVE, SUITE A, JONESBORO, AR 72404
PHONE: 870.335.6225 | WEB: WWW.DANIELS-LS.COM

A PART OF THE NW 1/4 OF THE SE 1/4
SECT. 36, TWP 14N, RGE 3E
JONESBORO, CRAIGHEAD COUNTY, ARKANSAS
PREPARED FOR: REBECCA & JAMES HARDIN

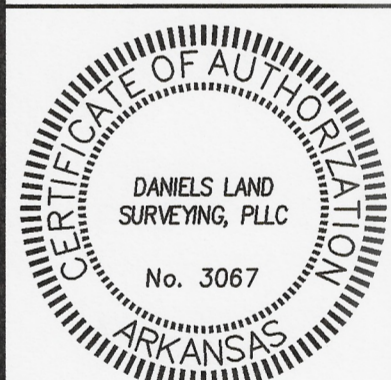

DANIELS LAND SURVEYING, PLLC
ARKANSAS COA 3067

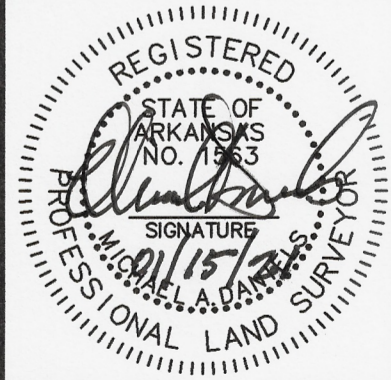

MICHAEL A. DANIELS
ARKANSAS PROFESSIONAL SURVEYOR 1563

REZONING PLAT

REVISIONS			
#	DATE	NOTES	BY

FIELD BOOK	SHEET
TSC 7	1 OF 1
DRAWN BY	CHECKED BY
SAW	AWD
DATE	SCALE
01/12/2021	1"=100'
PROJECT NO.	FILE NO.
0091-021	S36T14N R03E

STATE SURVEYOR CODE
500-14N-03E-0-36-204-16-1563