

**DESCRIPTION**

A PART OF THE NORTHWEST QUARTER OF THE SOUTHEAST QUARTER OF SECTION 18, TOWNSHIP 14 NORTH, RANGE 4 EAST, CRAIGHEAD COUNTY, ARKANSAS, BEING MORE PARTICULARLY DESCRIBED AS FOLLOWS:

BEGINNING AT THE NORTHWEST CORNER OF LOT 12-1 OF JONESBORO URBAN RENEWAL AND HOUSING AUTHORITY FIRST REPLAT; THENCE N89°06'09"E, A DISTANCE OF 121.78 FEET TO THE POINT OF BEGINNING PROPER; THENCE CONTINUE N89°06'09"E, A DISTANCE OF 20.50 FEET; THENCE S01°14'25"E A DISTANCE OF 138.99 FEET; THENCE S89°04'41"W, A DISTANCE OF 20.85 FEET; THENCE N01°05'51"W, A DISTANCE OF 139.00 FEET TO THE POINT OF BEGINNING PROPER, CONTAINING 0.06 ACRES, MORE OR LESS, SUBJECT TO ALL RIGHTS-OF-WAY AND EASEMENTS OF RECORD.

**SURVEYOR'S NOTES**

1. BASIS OF BEARING: ARKANSAS STATE PLANE, GRID NORTH ZONE(0301).
2. ALL MONUMENTS SET ARE 5/8" REBAR WITH BLUE PLASTIC CAP STAMPED BEARD PS 1691, UNLESS OTHERWISE NOTED.
3. REFERENCE DOCUMENTS USED IN THIS SURVEY:
  - WARRANTY DEED JB2013R-007074, RECORDED IN THE CRAIGHEAD COUNTY COURTHOUSE, JONESBORO, ARKANSAS.
  - WARRANTY DEED JB2013R-007076, RECORDED IN THE CRAIGHEAD COUNTY COURTHOUSE, JONESBORO, ARKANSAS.
  - COBB'S SURVEY OF THE NW 1/4, SE 1/4, SEC 18, T 14 N, R 4 E, DATED 5/20/1917.
  - JONESBORO URBAN RENEWAL AND HOUSING AUTHORITY FIRST REPLAT BY J.L. SCRAPE P.S. 515, DATED 4/9/1975.
  - PLAT OF SURVEY BY TERRENCE D. MOORE P.S. 1293, DATED 3/22/2013.
4. THERE HAS BEEN NO INVESTIGATION OR INDEPENDENT SEARCH FOR EASEMENTS OF RECORD, ENCUMBRANCES, RESTRICTIVE COVENANTS, OWNERSHIP, TITLE EVIDENCE, OR ANY OTHER FACTS THAT AN ACCURATE TITLE SEARCH MAY DISCLOSE.

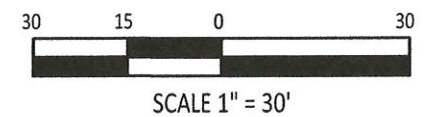

**LEGEND**

- FOUND 5/8" REBAR P.S. 1293 (UNLESS NOTED OTHERWISE)
- ⊙ SET MONUMENT
- △ CALCULATED (NOT SET)

**RIGHT-OF-WAY ABANDONMENT**

INTERSECTION OF EAST STREET AND CATE AVENUE  
SECTION 18, TOWNSHIP 14 NORTH, RANGE 4 EAST  
CRAIGHEAD COUNTY, JONESBORO, ARKANSAS

COMPANY INFO:  
2916 WOOD STREET  
JONESBORO, AR 72404  
PH: 1-870-203-9939  
WWW.TRALANENG.COM

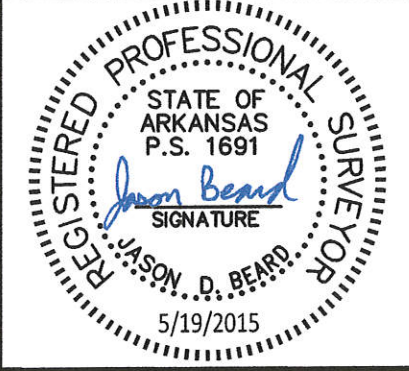
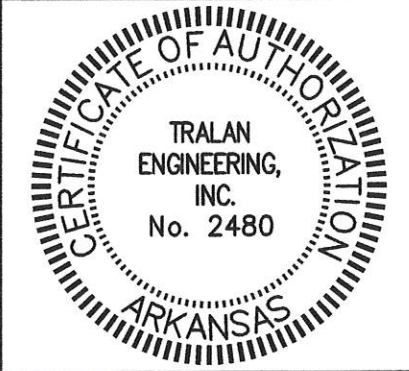

| DRAWING INFO |           |          |          |
|--------------|-----------|----------|----------|
| DRAWN BY:    | JDB       | SCALE:   | 1" = 30' |
| DATE:        | 5/19/2015 | JOB NO.: | 15-050   |

OAK STREET PROPERTIES, LLC

SHEET NUMBER:  
**1** of **1**