

- NOTES
- OWNER INFORMATION: CENTRAL BAPTIST CHURCH, 3707 HARRISBURG ROAD, JONESBORO, AR 72404
ARCHITECT INFORMATION: CAHOON-STEILING STUDIO, 915 SOUTHWEST DRIVE, JONESBORO, AR 72401
ENGINEER INFORMATION: McALISTER ENGINEERING, 1013 CR 620, JONESBORO, AR 72404
 - PROPERTY NOT LOCATED IN FLOOD ZONE AS SHOWN BY FLOOD INSURANCE RATE MAP FOR CRAIGHEAD COUNTY, ARKANSAS AND INCORPORATED AREAS, COMMUNITY - JONESBORO, CITY OF, NUMBER 050048, PANEL 0063, SUFFIX C, EFFECTIVE DATE, SEPTEMBER 27, 1991.
 - (ADA COMPLIANCE) ACCESSIBLE PARKING AND ROUTE MAXIMUM SLOPES - CROSS-SLOPES 1:50 (2 %), ACCESSIBLE ROUTE 1:20 (5 %), RAMPS 1:12 (8.3%)
 - PLACE CONSTRUCTION ENTRANCE/EXIT TO CONTROL TRACKING OF SEDIMENT ONTO ROADWAYS.
 - ALL UTILITIES EXIST ON SITE: THE NEAREST FIRE HYDRANT IS AT THE WEST R/WOF PARKER ANNEX ROAD MIDWAY OF LOT.
 - STABILIZE SLOPES GREATER THAN 3:1 WITH TERRACED LANDSCAPING, RIPRAP, GEOGRID, RETAINING WALL, PAVING OR OTHER ARCHITECT/ENGINEER APPROVED METHOD.
 - PARKING CALC PER SCHED A: CIVIC AND COMMERCIAL USE--CHURCH, REQUIRED PARKING: 1 SPACE PER 4 SEATS IN SANCTUARY. (600 SEATS) / (4 SPACES/SEAT) = 150 REQUIRED PARKING SPACES. 413 PROVIDED PARKING SPACES. 9/413 SPACES ARE ADA COMPLIANT.
 - ALL DRAINAGE STRUCTURES SHALL BE BUILT IN ACCORDANCE WITH THE CITY OF JONESBORO, CRAIGHEAD COUNTY, ARKANSAS STORMWATER DRAINAGE DESIGN MANUAL.
 - SOIL TYPE: COLLINS SILT LOAM, OCCASIONALLY FLOODED/LORING SILT LOAM 3-8% SLOPES (TYPE C)
 - MINIMUM REQUIRED ZONING SETBACKS: RESIDENTIAL 1 (R-1)
STREET SETBACK - 25'
SIDE SETBACK - 7.5'
REAR SETBACK - 25'

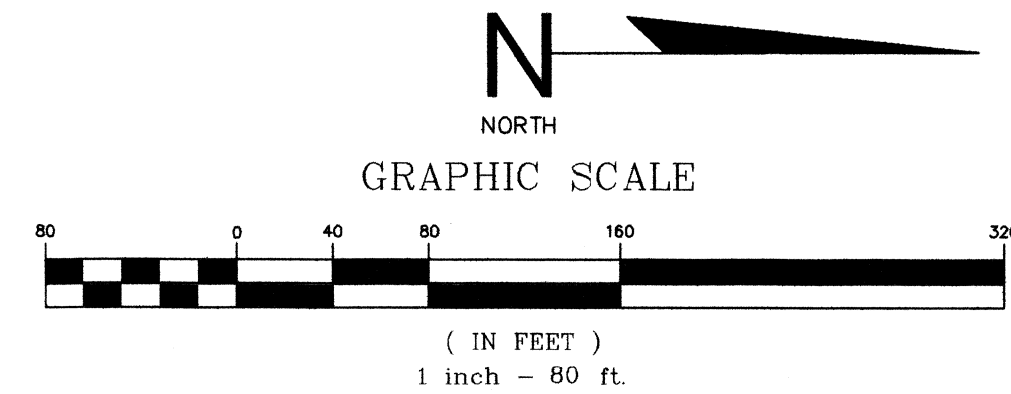

- LEGEND
- FOUND IRON PIN
 - EXISTING GRADE CONTOURS
 - FINISH GRADE CONTOURS

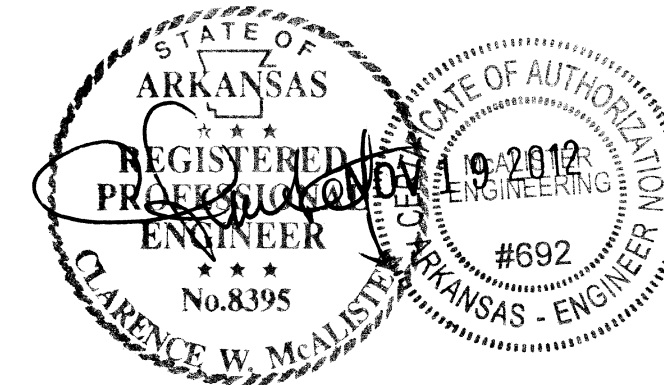
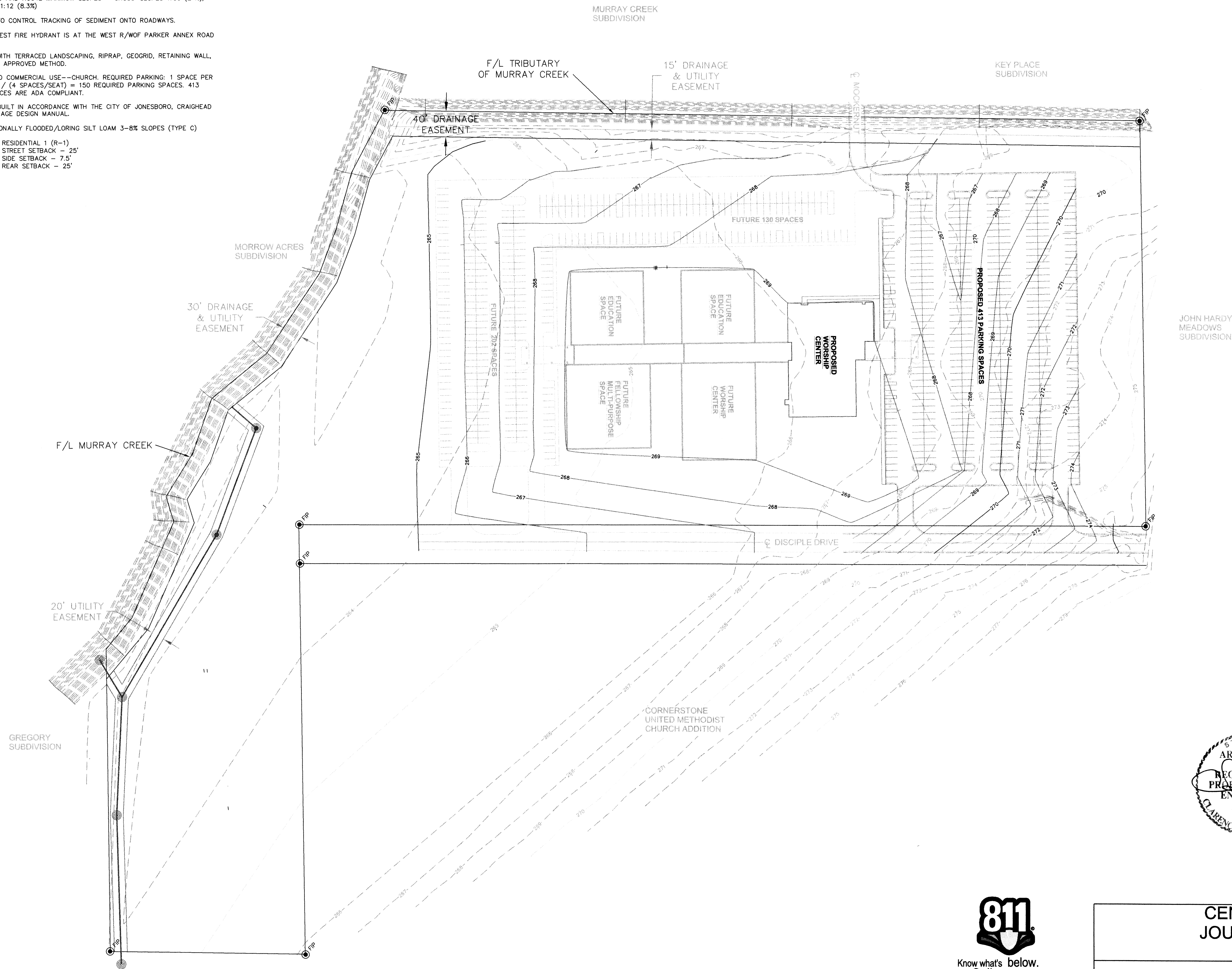

© Copyright 2012 McALISTER ENGINEERING

DATE	REVISION	BY

GENERAL PLAN/TOPO

CENTRAL BAPTIST CHURCH
JOURNEY CAMPUS - PHASE 1
JONESBORO, ARKANSAS

McALISTER ENGINEERING
CIVIL ENGINEERING AND LAND SURVEYING

1013 CR 620 JONESBORO, AR 72404
870-931-1420

CLARENCE W. "MAC" McALISTER, PE, PS

DRAWN BY: JH	CHECKED BY: CWM
SCALE: 1" = 80'	PROJECT 1250618
DATE: 10OCT12	CAD FILE: 1250618Jou...Phase1
DWG REF. 04E-14N-11	JOB NO. 1250618
JOB NO. 1250618	SHEET 2 / 6