

NW CORNER
NE 1/4, SE 1/4
SECTION 27, T14N, R4E
AS PER DUDLEY PLAT
N 89°07'21" E
25.00'

PROPERTY ZONED RS-7
20' FRONT AND REAR SETBACK
7.5' SIDYARD SETBACK

C/L DUDLEY ST.

S 00°03'11" W 280.00'

1
2
3
4
BLOCK A
R-2

DONALD STREET

1
2
3
BLOCK D
R-2

N 89°07'21" E 400.00'

C/L FRED STREET

R-2

17
18
19
R-2

1
2
3
4
BLOCK D
C-3

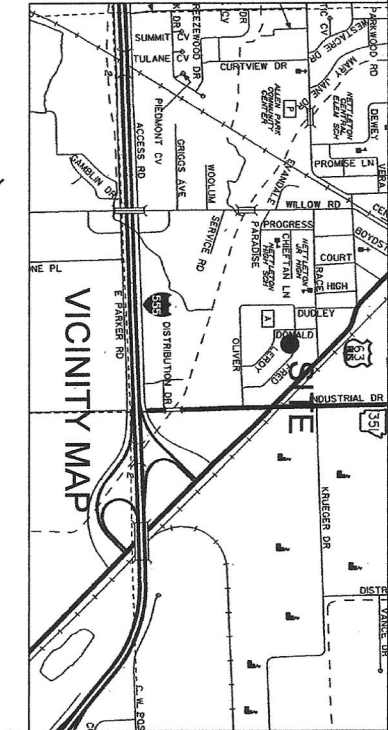

DESCRIPTION:
A PART OF BLOCK "D" OF DUDLEY'S FIRST ADDITION TO THE CITY OF JONESBORO, FORMERLY TOWN OF NETTLETON, ARKANSAS AND BEING MORE PARTICULARLY DESCRIBED AS FOLLOWS:
Commencing at the Northwest corner of the Northeast Quarter of the Southeast Quarter of Section 27, Township 14 North, Range 4 East; thence North 89°07'21" East 25.00 feet; thence South 00°03'11" West 280.00 feet; thence North 89°07'21" East 400.00 feet; thence continue North 89°07'21" East 60.00 feet to the point of beginning proper; thence North 00°03'11" East 120.00 feet; thence North 89°07'21" East 166.26 feet; thence South 43°13'41" East 134.37 feet; thence South 46°29'50" West 130.83 feet; thence North 65°24'16" West 157.89 feet; thence South 89°07'21" West 19.93 feet to the point of beginning proper; having an area of 33541.27 square feet, 0.77 acres more or less and being subject to all public and private roads and easements.

OWNER CERTIFICATION:
WE HEREBY CERTIFY THAT WE, THE OWNERS OF THE PROPERTY SHOWN AND DESCRIBED HEREON AND THAT WE ADOPT THE PLAN OF THE SUBDIVISION AND DEDICATED PERPETUAL USE OF ALL STREETS AND EASEMENTS AS NOTED AND WE FURTHER CERTIFY THAT WE HAVE READ AND ACKNOWLEDGED THE FOLLOWING STATEMENT.

SURVEYORS NOTES:
1. BEARINGS ARE STATE PLANE GRID BEARINGS (NAD 83 DATUM) AS PER GPS OBSERVATION ON SITE DURING SURVEY AND ARE TO BE USED TO DEFINE THE GENERAL DIRECTION AND TRUE ANGLE AT THE INTERSECTION OF THE PROPERTY AND LAND LINES.
2. PROPERTY IS SUBJECT TO UTILITY SERVICES AND UNDERGROUND UTILITY LINES NOT LOCATED.

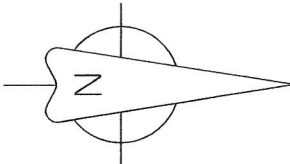
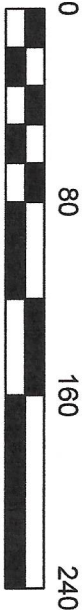

LEGEND

These standard symbols will be found in the drawing.

- FOUND CORNER AS NOTED
- SET 1/2" REBAR W/ CAP
- FD COTTON PICKER SPINDLE
- ▲ HIGHWAY RIGHT OF WAY MARKER
- ◎ FOUND REBAR
- △ CALCULATED CORNER
- X—X— FENCE LINE
- E—E— ELECTRIC
- SET PK NAIL
- POWER POLE
- MANHOLE

SURVEYOR'S CERTIFICATION:

THIS IS TO CERTIFY I HAVE ON THIS DATE SURVEYED THE ABOVE DESCRIBED PROPERTY IN ACCORDANCE WITH MONUMENTS FOUND THIS PLAT CONFORMS TO THAT SURVEYED.

H&S HIME PROFESSIONAL SURVEYING SERVICES
2619 CARAWAY RD. STE. "D"
JONESBORO, ARKANSAS 72401

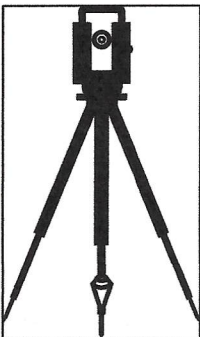
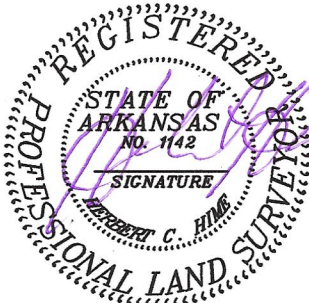

H&S HIME PROFESSIONAL
SURVEYING SERVICES
2619 CARAWAY RD - STE. "D"
JONESBORO, ARKANSAS 72401

PHONE: 870-972-1288
FAX: 870-972-1011
E-MAIL: hshime_butch@yahoo.com

LYNN TURNER - BLOCK "D" REPLAT OF

drawn: H. HIME	A PART OF BLOCK "D" OF DUDLEY'S FIRST ADDITION TO THE CITY OF JONESBORO, (FORMERLY TOWN OF NETTLETON), ARKANSAS
date: 11-05-2019	
scale: 1" = 80'	client: LYNN TURNER