

LEGAL DESCRIPTION:
 Lot 1, Block J, Halton's 2nd Addition, Jonesboro, Arkansas.

- NOTES:
- 1) NO FIELD WORK HAS BEEN PERFORMED TO DATE, TO CONFIRM THE LOT DIMENSIONS.
 - 2) CURRENT ZONING: C-3
 - 3) THIS PARCEL LIES WITHIN THE FLOODPLAIN. ANY DEVELOPMENT WILL HAVE TO FOLLOW THE APPROPRIATE FLOOD PLAN DEVELOPMENT REGULATIONS.

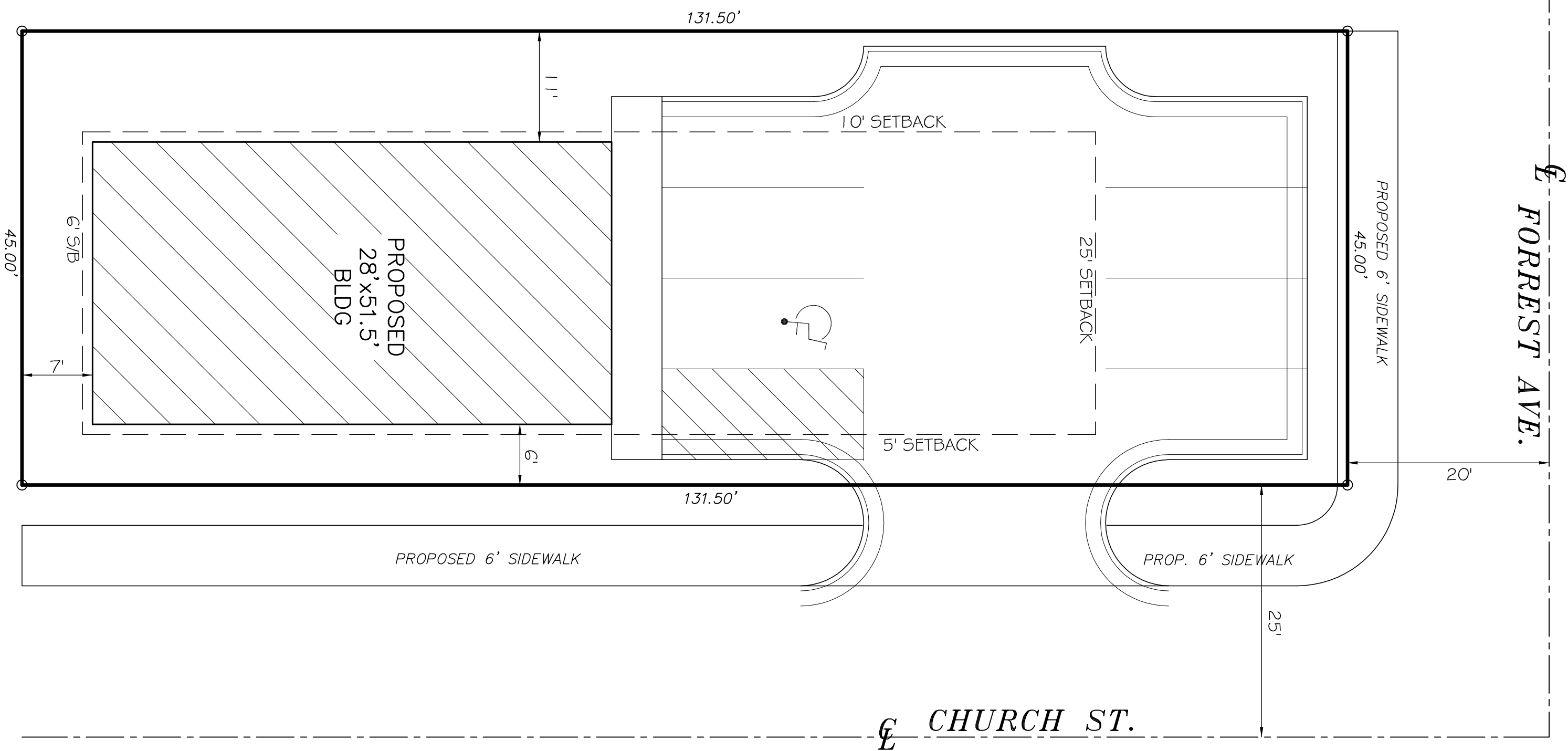

- REQUESTED VARIANCE
- 1) 6' SETBACK ON SOUTH LOT LINE.
 - 2) 5' FRONT SETBACK ON FORREST AVENUE.
 - 3) ALLOW PREVIOUSLY PLATTED LOT WIDTH OF 45 FT., AS PLATTED IN 1913, OR AS MEASURED UPON COMPLETION OF FIELD WORK.

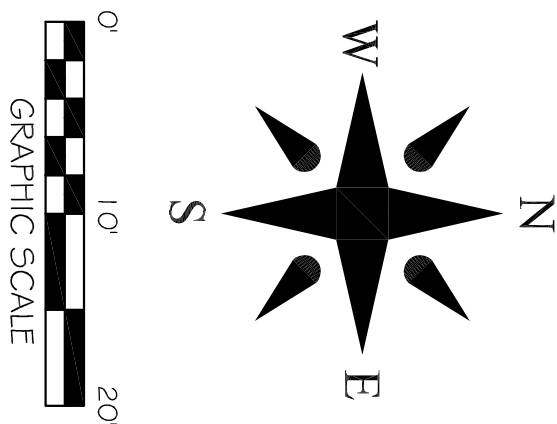

| | | | | | | | |
|---|--|--|--|----------------------------------|--------------------------------|---|-------------------|
| JOB NO.: 119008 SHEET NUMBER 1 of 1 | | VARIANCE PLAT 109 E. FORREST AVE. JONESBORO, ARKANSAS FOR ANDREW MILLER | | ENGINEERS PLANNERS SURVEYORS | Drawn By: RE Checked by: GH | Date: 06-19-19 Scale: 1"=10' Job No.: 119008 Section: 07 Township: 14N Range: 04E County: CRAIGHEAD | Sheet No.: 1 of 1 |
| | | 203 Southwest Dr. - Jonesboro, AR - (870)932-7880 - www.civilogic.net | | | © 2019, Civilogic | | |
| | | ONLY COPIES WITH VIOLET COLORED SIGNATURE ARE ORIGINAL CIVILOGIC COPIES | | | | | |