

VICINITY MAP

SCALE: 1" = 1000 ft.

LEGAL DESCRIPTION:

Lot 1, Block J, Haltom's 2nd Addition, Jonesboro, Arkansas.

NOTES:

- 1) NO FIELD WORK HAS BEEN PERFORMED TO DATE, TO CONFIRM THE LOT DIMENSIONS.
- 2) CURRENT ZONING: C-3
- 3) THIS PARCEL LIES WITHIN THE FLOODPLAIN. ANY DEVELOPMENT WILL HAVE TO FOLLOW THE APPROPRIATE FLOOD PLAIN DEVELOPMENT REGULATIONS.

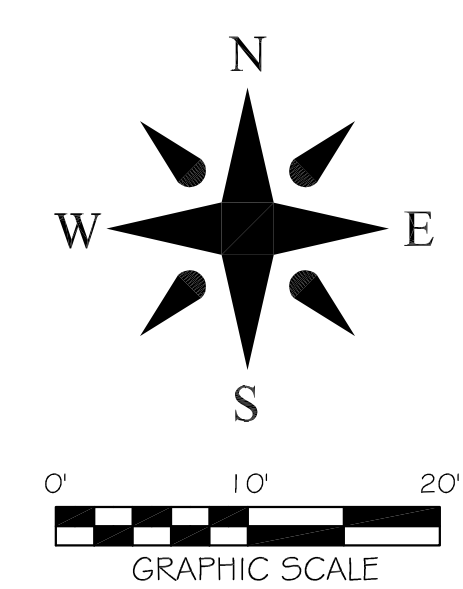
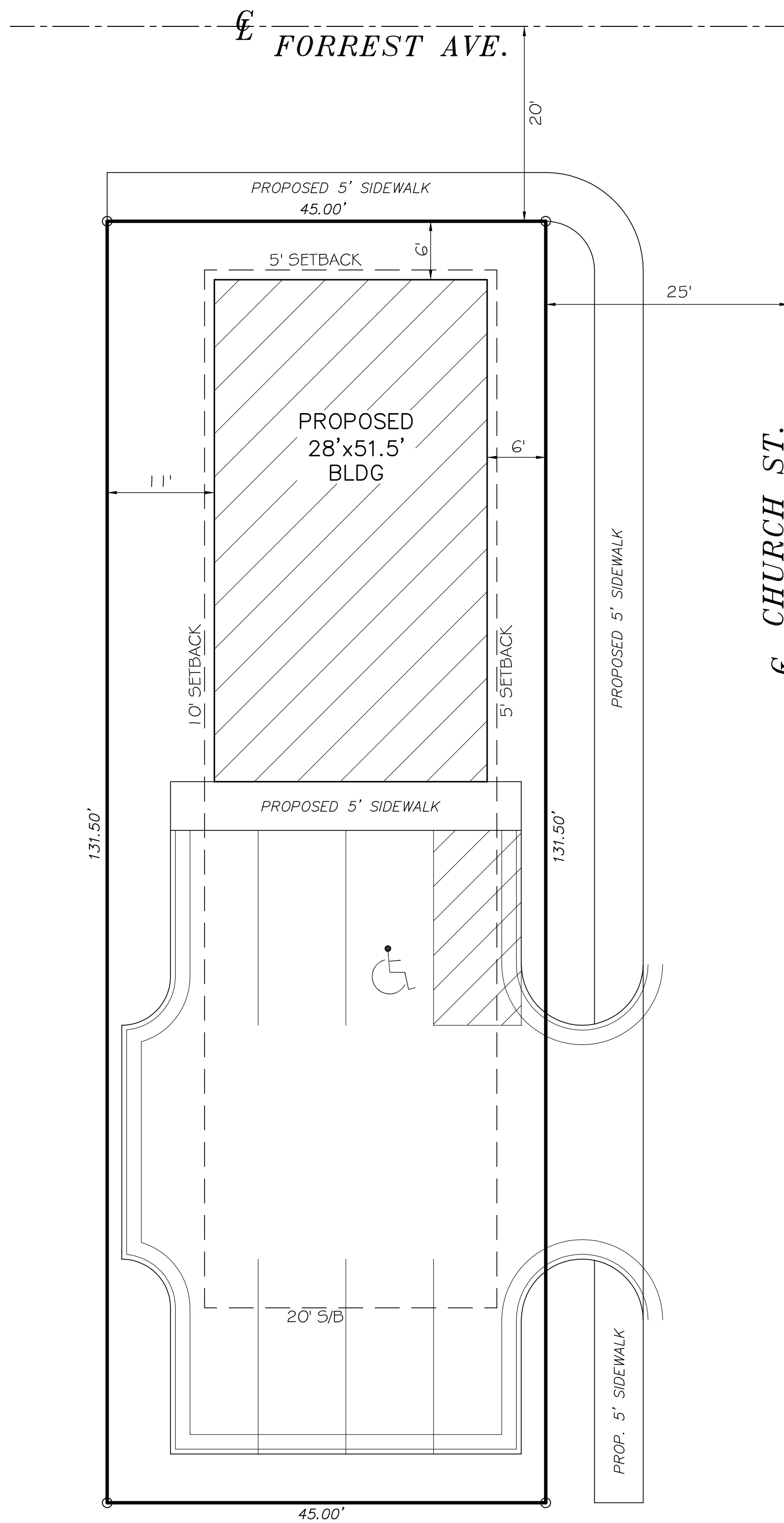

- REQUESTED VARIANCE**
- 1) 5' FRONT SETBACK ON CHURCH STREET.
 - 2) 5' FRONT SETBACK ON FORREST AVENUE.
 - 3) ALLOW PREVIOUSLY PLATTED LOT WIDTH OF 45 FT., AS PLATTED IN 1913, OR AS MEASURED UPON COMPLETION OF FIELD WORK.

<p>ENGINEERS</p>	<p>PLANNERS</p>	<p>SURVEYORS</p>	<p>Drawn By: RE</p>	<p>Checked by: GH</p>
			<p>Date: 04-01-19</p>	<p>Job No.: 119008</p>
<p>VARIANCE PLAT 109 E. FORREST AVE. JONESBORO, ARKANSAS FOR ANDREW MILLER</p>			<p>Scale: 1" = 10'</p>	<p>Sheet No.: 1 of 1</p>
			<p>Township: 14N</p>	<p>County: CRAIGHEAD</p>
<p>203 Southwest Dr. - Jonesboro, AR - (870) 932-7880 - www.civilogic.net</p>			<p>Range: 04E</p>	<p>Section: 07</p>
<p>© 2019, Civilogic</p>			<p>ONLY COPIES WITH VIOLET COLORED SIGNATURE ARE ORIGINAL CITILOGIC COPIES</p>	
<p>JOB NO.: 119008</p>			<p>SHEET NUMBER</p>	
<p>1 of 1</p>			<p>1 of 1</p>	