

CERTIFICATE OF SURVEY: THIS IS TO CERTIFY THAT HAYWOOD, KENWARD ASSOCIATES, INC., CIVIL ENGINEERS AND PROFESSIONAL LAND SURVEYORS, SURVEYED IN ACCORDANCE WITH "ARKANSAS MINIMUM STANDARDS FOR PROPERTY BOUNDARIES AND PLATS", THE PARCEL/PARCELS OF LAND DESCRIBED HEREON:

A PART OF THE WEST 1/4 OF THE SW 1/4 OF SECTION 8, TOWNSHIP 14 NORTH, RANGE 4 EAST, BEING MORE PARTICULARLY DESCRIBED AS FOLLOWS: BEGIN AT THE SOUTHWEST CORNER OF SECTION 8, TOWNSHIP 14 NORTH, RANGE 4 EAST; THENCE EAST ON THE SECTION 918.87' TO THE CENTERLINE OF GREENSBORO ROAD; THENCE WITH THE MEANDERINGS WITH SAID ROAD CENTERLINE AS FOLLOWS; N9°34'17"E-208.21'; N15°54'01"E-45.20' TO THE POINT OF BEGINNING PROPER; THENCE WITH THE MEANDERINGS WITH EXISTING FENCE LINES AND APPARENT POSSESSION LINES AS FOLLOWS; N72°50'52"W-187.66'; S0°17'01"W-31.37'; S89°30'18"W-194.03'; N1°09'38"E-210.42'; N89°58'05"W-139.79'; N1°19'46"E-202.84'; S89°45'47"E-442.91'; N1°30'21"E-734.91'; S74°30'31"E-296.02'; S1°42'38"W-476.43'; S89°50'40"W-127.97'; S3°48'12"W-191.07'; S8°57'14"E-159.59' TO THE CENTERLINE OF GREENSBORO ROAD; THENCE WITH THE MEANDERINGS WITH SAID ROAD CENTERLINE AS FOLLOWS; S29°41'38"W-56.23'; S24°45'09"W-89.86'; S21°15'27"W-97.81'; S15°54'01"W-44.53' TO THE POINT OF BEGINNING PROPER, CONTAINING 8.84 ACRES, MORE OR LESS, SUBJECT TO ALL RIGHTS OF WAY AND EASEMENTS OF RECORD.

MONUMENTS WERE FOUND OR SET AS NOTED ON THE PLAT OF SURVEY HEREON.

THE ABOVE DESCRIBED PARCEL IS NOT LOCATED WITHIN THE JONESBORO FLOOD HAZARD ZONE PER MAP NO. 05031C0044C DATED SEPTEMBER 27, 1991.



## REZONING EXHIBIT

PT. W1/2 SW1/4 SEC. 8, T14N - R4E

JONESBORO ARKANSAS

**HAYWOOD, KENWARD & ASSOCIATES, INC.**  
CIVIL ENGINEERS — SURVEYORS  
JONESBORO, ARKANSAS 72401

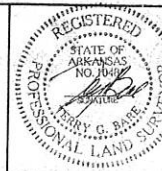

CLIENT: \_\_\_\_\_  
APPROVED: \_\_\_\_\_  
DATE: \_\_\_\_\_

REVISIONS	
DATE	DESCRIPTION

DRAWN: T.B.	SHEET OF
DATE: 11/7/94	SCALE: 1" = 50'
CHECKED: _____	DWG. NO. W - 85
DATE: _____	
JOB NO. _____	