

Lot 9
Clear View Estates
Zoned R-1

1 STORY
COMPOSITE ROOF
CONC. SLAB FND.

ASPHALT

CONC.

Zoned R-1

Lot 8
Clear View Estates
0.88 Acres
Zoned R-1

Lot 7
Clear View Estates
Zoned R-1

Lot 6
Clear View Estates
Zoned R-1

MAPLE VALLEY DRIVE

HIGHWAY 49 (SOUTHEAST DRIVE)

Zoned R-1

Zoned C-4

WIMPY LANE

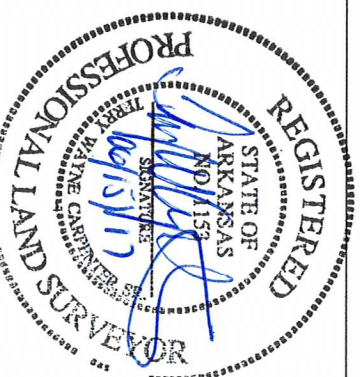

Surveyor's Certification:

I hereby certify that USI Consulting Engineers, Inc. has this date made a Rezoning Plat of the hereon described property and that the survey is accurate and correct to the best of my knowledge and belief. There are no apparent above ground encroachments other than as shown or stated hereon and that this survey was made in accordance with the Arkansas Standards of Practice for Property Boundary Surveys and Plats, in effect as of this date.

Terry W. Carpenter, Sr., Arkansas Professional Surveyor No. 1153

Date



Owner's Certification:

We hereby certify that we are the Owners of the property as described hereon and that we request the Zoning change as noted.

Wade S. Carpenter

Katrina Y. Carpenter



USI Consulting Engineers
Springdale, Arkansas
© 2017 USI Consulting Engineers

REZONING PLAT FOR
WADE & KATIE CARPENTER
LOT 8 - CLEAR VALLEY ESTATES
JONESBORO, CRAIGHHEAD COUNTY, ARKANSAS