

G:\Projects\2013\20130081\Construction\Phase 1\20130081_P1_H001_HSCAPE.dwg--H001 Dec 02, 2016 -- 1:17pm pwilliams

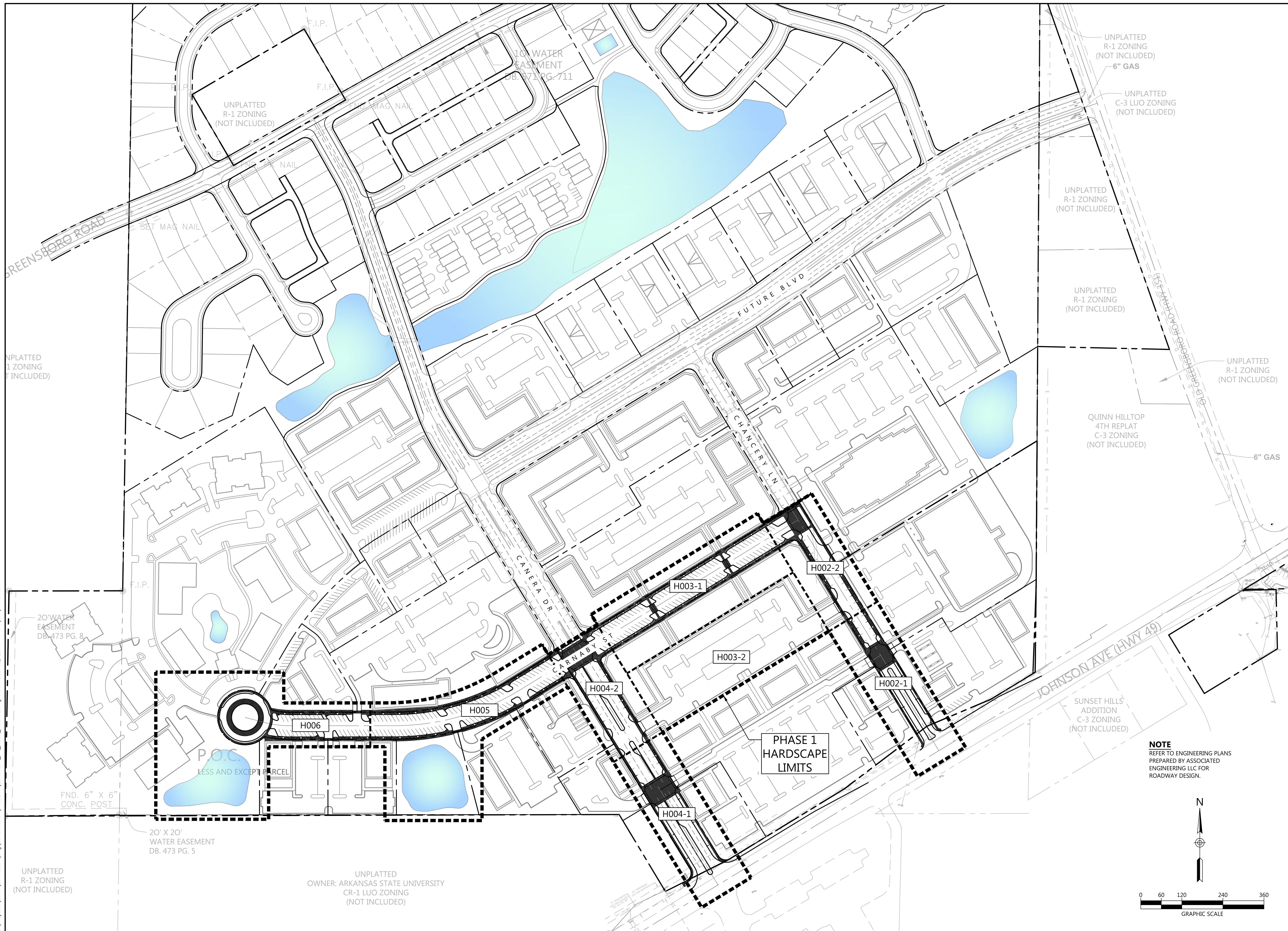

GREENSBOROUGH VILLAGE
 PHASES 1 & 1A
 U.S. HIGHWAY 49 (JOHNSON AVENUE)
 JONESBORO, ARKANSAS

Littlejohn
 An S&ME Company

1935 21st Avenue South, NASHVILLE, TENNESSEE 37212
 T 615.385.4144 F 615.385.4020 www.littlejohn.com

NOTE
 REFER TO ENGINEERING PLANS
 PREPARED BY ASSOCIATED
 ENGINEERING LLC FOR
 ROADWAY DESIGN.

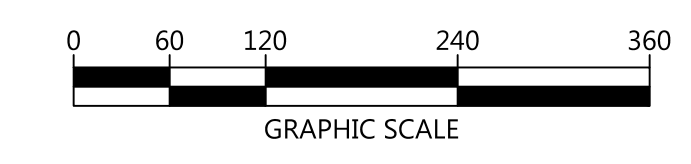
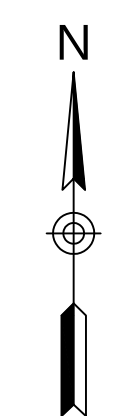

NO.	DESCRIPTION	DATE

**PHASE 1
 OVERALL
 HARDSCAPE**

DATE: 12/03/2016 DRAWN:
 CADD FILE: CHECKED: AR/JDH
 DWG#: SHEET
 SCALE: H001

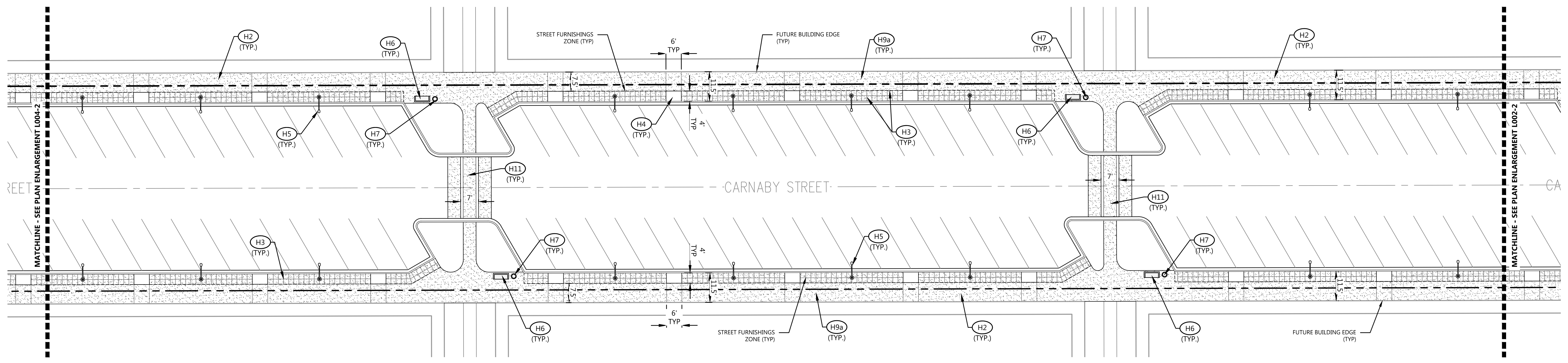

PLAN ENLARGEMENT L003-1

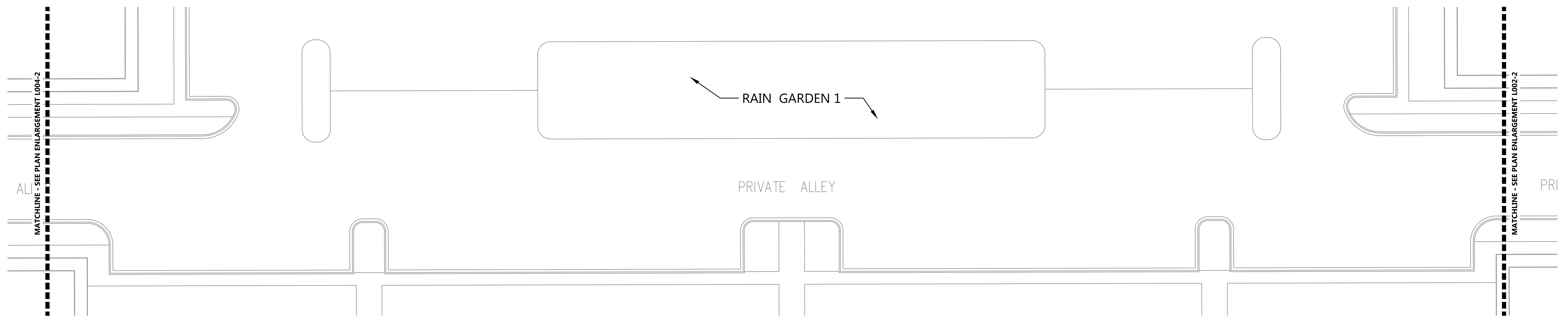

PLAN ENLARGEMENT L003-2

SITE HARDSCAPE KEYNOTES		
CODE	DESCRIPTION	DET #/SHT #
(H1)	STAMPED ASPHALT	8/H007
(H2)	CONCRETE SIDEWALK	1/H007
(H3)	SIDEWALK JOINTS	2/H007
(H4)	TREE WELL	5/L007
(H5)	STREET LIGHT FIXTURE	3/H007
(H6)	BENCH	4/H007
(H7)	WASTE RECEPTACLE	5/H007
(H8)	PLANTER	7/L007
(H9a)	STREETSCAPE TYPE A	7/H007
(H9b)	STREETSCAPE TYPE B	8/H007
(H10)	INTERSECTION & CROSSWALK	9/H007
(H11)	RAISED CROSSWALK	6/H007

PROPOSED FEATURES LEGEND	
BOUNDARY / RIGHT-OF-WAY	--- ---
STAMPED ASPHALT	[Hatched Pattern]
CONCRETE SIDEWALK	[Stippled Pattern]
PLANTER	○
BENCH	□
TRASH RECEPTACLE	●
STREET LIGHT FIXTURE	⊙

NOTE
REFER TO ENGINEERING PLANS PREPARED BY ASSOCIATED ENGINEERING LLC FOR ROADWAY DESIGN.

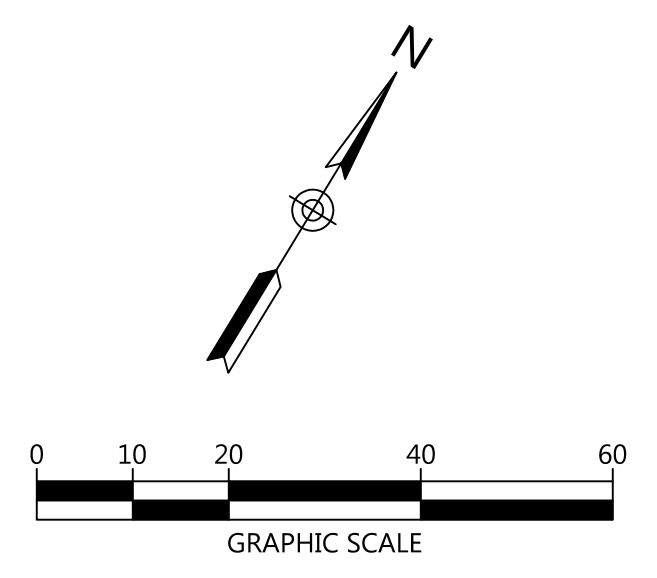

GREENSBOROUGH VILLAGE
PHASES 1 & 1A
U.S. HIGHWAY 49 (JOHNSON AVENUE)
JONESBORO, ARKANSAS

Littlejohn
An S&ME Company

1995 21st Avenue South, NASHVILLE, TENNESSEE 37212
T 615.385.4144 F 615.385.4020 www.littlejohn.com

NO.	DESCRIPTION	DATE

**PHASE 1
SITE
HARDSCAPE**

DATE: 12/03/2016 DRAWN: AR/JDH
CADD FILE: CHECKED: AR/JDH
DWG#: SHEET
SCALE: H003

G:\Projects\2013\20130081\Construction\Phase 1\20130081_P1_H001_HSCAPE.dwg--H003 Dec 02, 2016 -- 1:17pm pwilliams

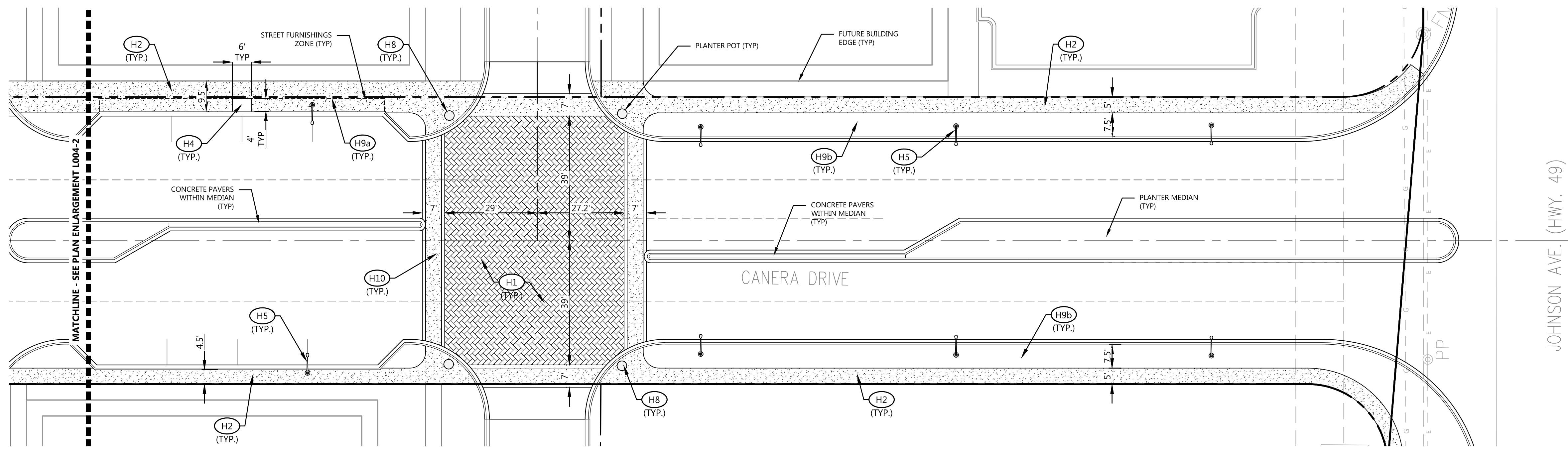

PLAN ENLARGEMENT L004-1

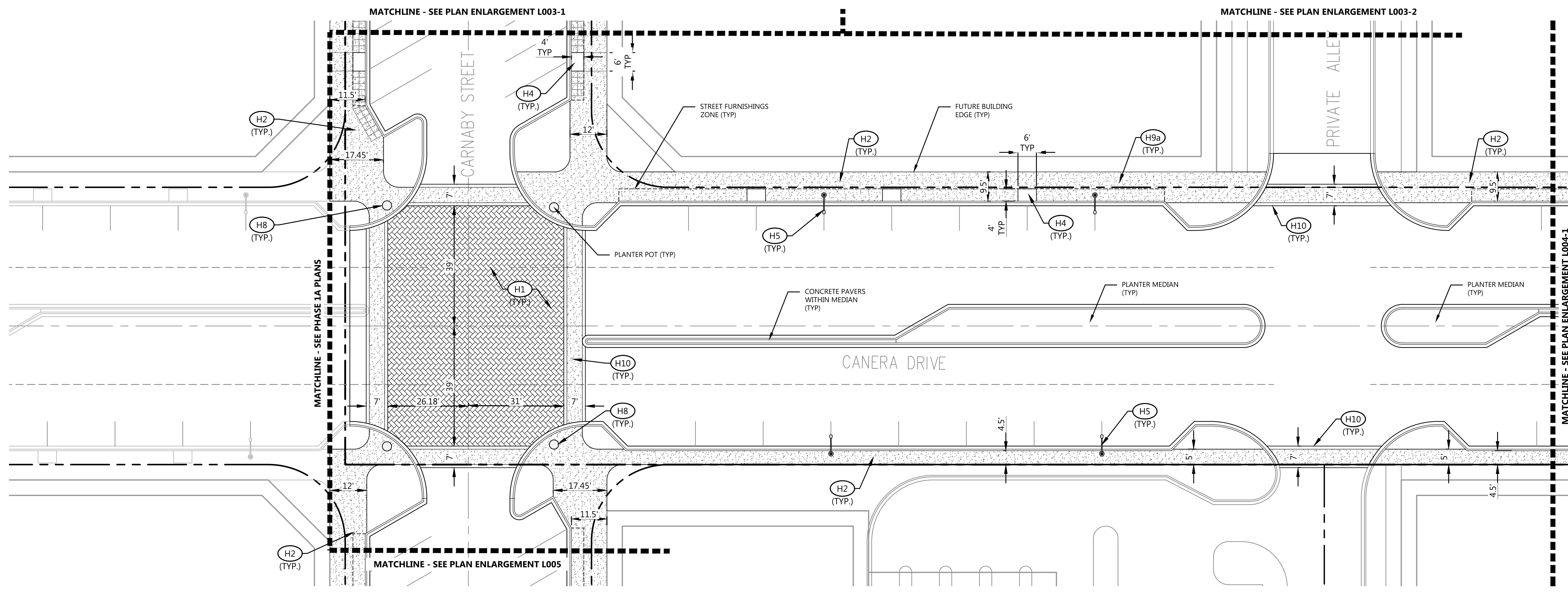

PLAN ENLARGEMENT L004-2

SITE HARDSCAPE KEYNOTES		
CODE	DESCRIPTION	DET #/SHT #
(H1)	STAMPED ASPHALT	8/H007
(H2)	CONCRETE SIDEWALK	1/H007
(H3)	SIDEWALK JOINTS	2/H007
(H4)	TREE WELL	5/L007
(H5)	STREET LIGHT FIXTURE	3/H007
(H6)	BENCH	4/H007
(H7)	WASTE RECEPTACLE	5/H007
(H8)	PLANTER	7/L007
(H9a)	STREETSCAPE TYPE A	7/H007
(H9b)	STREETSCAPE TYPE B	8/H007
(H10)	INTERSECTION & CROSSWALK	9/H007
(H11)	RAISED CROSSWALK	6/H007

PROPOSED FEATURES LEGEND

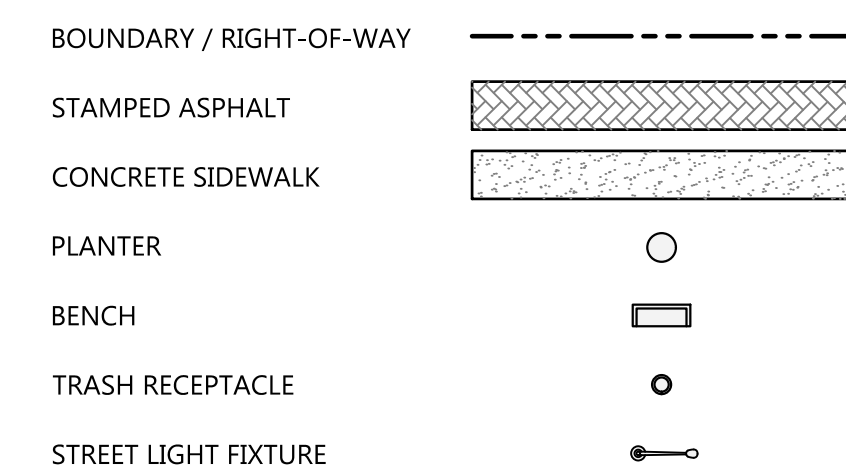

NOTE
REFER TO ENGINEERING PLANS
PREPARED BY ASSOCIATED
ENGINEERING LLC FOR
ROADWAY DESIGN.

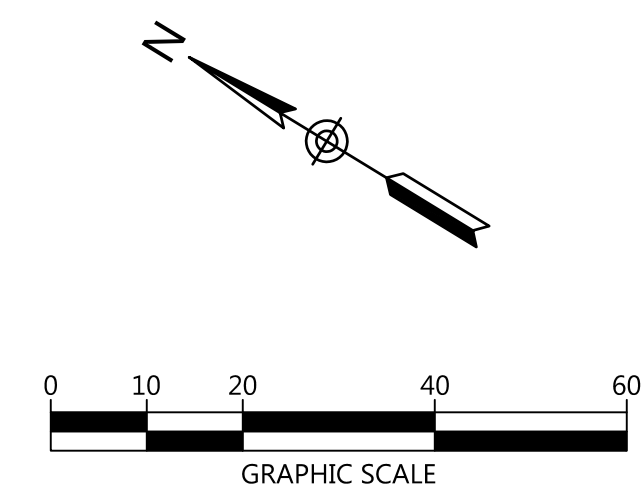

GREENSBOROUGH VILLAGE
PHASES 1 & 1A
U.S. HIGHWAY 49 (JOHNSON AVENUE)
JONESBORO, ARKANSAS

Littlejohn
An S&ME Company

1995 21st Avenue South, Nashville, Tennessee 37212
T: 615.385.4144 F: 615.385.4020 www.littlejohn.com

NO.	DESCRIPTION	DATE

**PHASE 1
SITE
HARDSCAPE**

DATE: 12/03/2016	DRAWN:
CADD FILE:	CHECKED: AR/JDH
DWG#:	SHEET
SCALE:	H004

G:\Projects\2013\20130081\Construction\Phase 1\20130081_P1_H001_HSCAPE.dwg-H005 Dec 02, 2016 - 1:18pm pwilliams

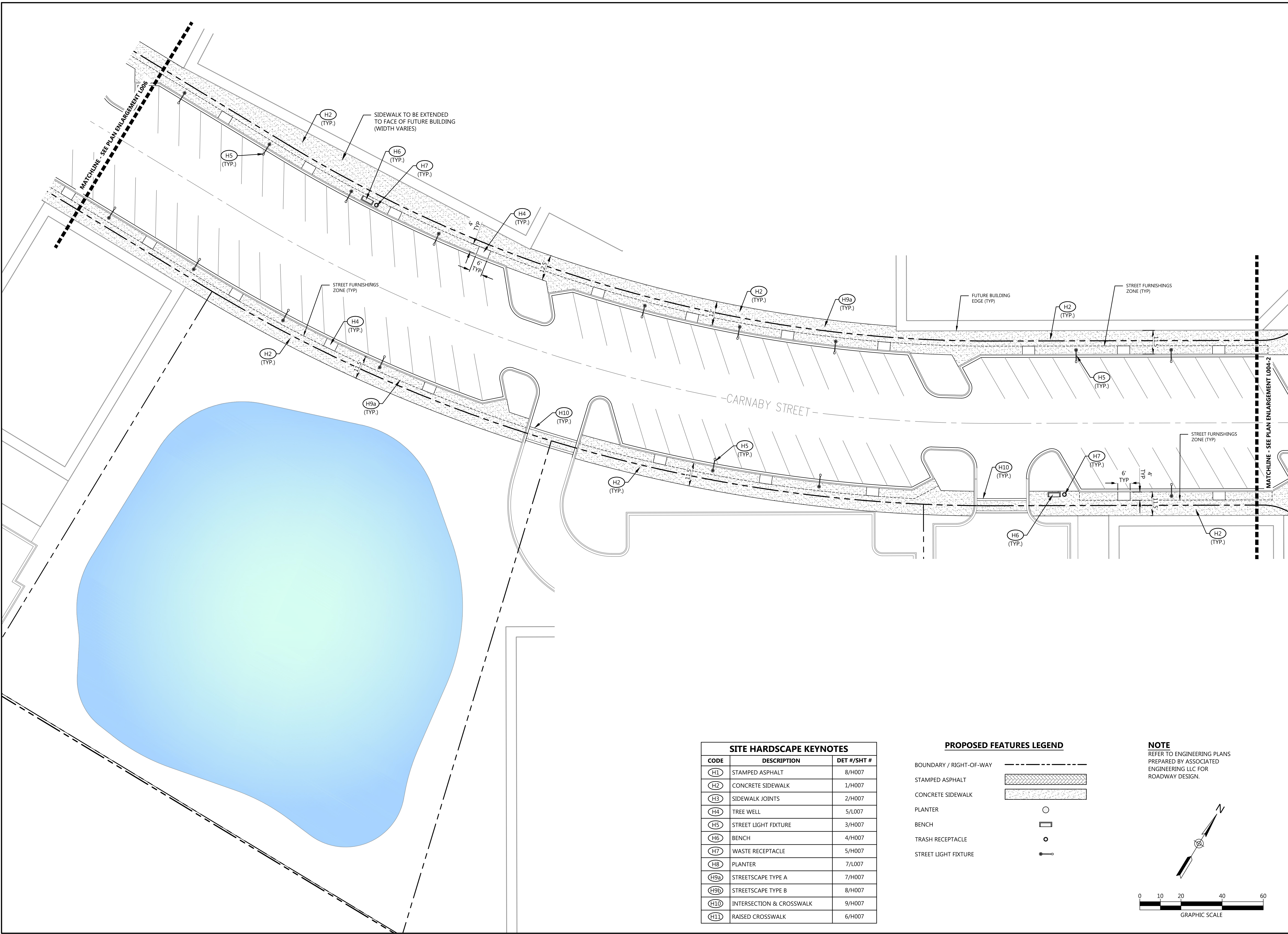

SITE HARDSCAPE KEYNOTES		
CODE	DESCRIPTION	DET #/SHT #
(H1)	STAMPED ASPHALT	8/H007
(H2)	CONCRETE SIDEWALK	1/H007
(H3)	SIDEWALK JOINTS	2/H007
(H4)	TREE WELL	5/L007
(H5)	STREET LIGHT FIXTURE	3/H007
(H6)	BENCH	4/H007
(H7)	WASTE RECEPTACLE	5/H007
(H8)	PLANTER	7/L007
(H9a)	STREETSCAPE TYPE A	7/H007
(H9b)	STREETSCAPE TYPE B	8/H007
(H10)	INTERSECTION & CROSSWALK	9/H007
(H11)	RAISED CROSSWALK	6/H007

PROPOSED FEATURES LEGEND	
BOUNDARY / RIGHT-OF-WAY	
STAMPED ASPHALT	
CONCRETE SIDEWALK	
PLANTER	
BENCH	
TRASH RECEPTACLE	
STREET LIGHT FIXTURE	

NOTE
REFER TO ENGINEERING PLANS PREPARED BY ASSOCIATED ENGINEERING LLC FOR ROADWAY DESIGN.

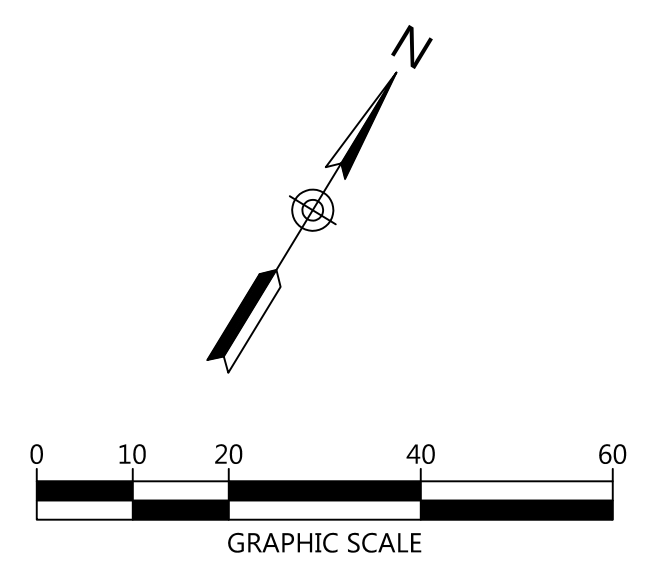

GREENSBOROUGH VILLAGE
PHASES 1 & 1A
U.S. HIGHWAY 49 (JOHNSON AVENUE)
JONESBORO, ARKANSAS

Littlejohn
An S&ME Company
1995 21st Avenue South, NASHVILLE, TENNESSEE 37212
T 615.385.4144 F 615.385.4020 www.littlejohn.com

NO.	DESCRIPTION	DATE

**PHASE 1
SITE
HARDSCAPE**
DATE: 12/03/2016 DRAWN:
CADD FILE: CHECKED: AR/JDH
DWG#: SHEET
SCALE: H005

G:\Projects\2013\20130081\Construction\Phase 1\20130081_P1_H001_HSCAPE.dwg--H006 Dec 02, 2016 -- 11:18pm pwilliams

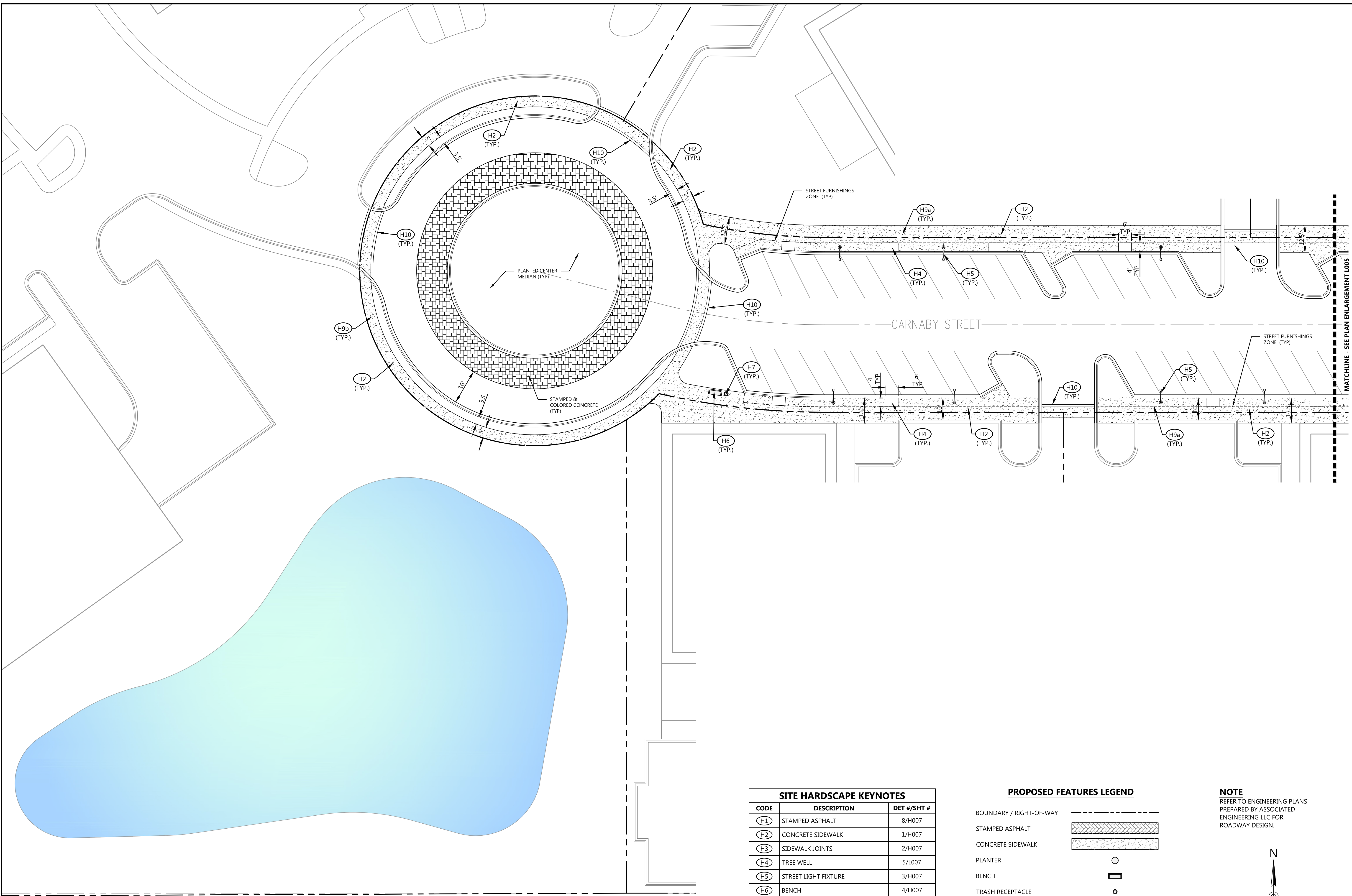

SITE HARDSCAPE KEYNOTES

CODE	DESCRIPTION	DET #/SHT #
(H1)	STAMPED ASPHALT	8/H007
(H2)	CONCRETE SIDEWALK	1/H007
(H3)	SIDEWALK JOINTS	2/H007
(H4)	TREE WELL	5/L007
(H5)	STREET LIGHT FIXTURE	3/H007
(H6)	BENCH	4/H007
(H7)	WASTE RECEPTACLE	5/H007
(H8)	PLANTER	7/L007
(H9a)	STREETSCAPE TYPE A	7/H007
(H9b)	STREETSCAPE TYPE B	8/H007
(H10)	INTERSECTION & CROSSWALK	9/H007
(H11)	RAISED CROSSWALK	6/H007

PROPOSED FEATURES LEGEND

BOUNDARY / RIGHT-OF-WAY	
STAMPED ASPHALT	
CONCRETE SIDEWALK	
PLANTER	
BENCH	
TRASH RECEPTACLE	
STREET LIGHT FIXTURE	

NOTE
REFER TO ENGINEERING PLANS PREPARED BY ASSOCIATED ENGINEERING LLC FOR ROADWAY DESIGN.

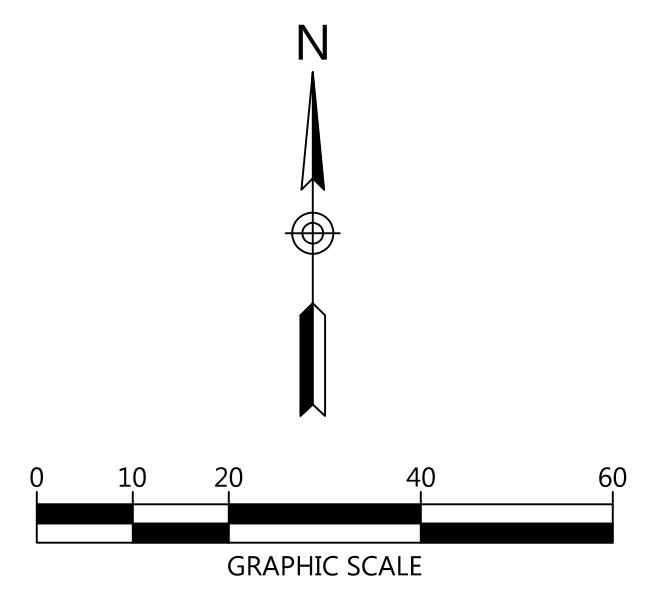

GREENSBOROUGH VILLAGE
PHASES 1 & 1A
U.S. HIGHWAY 49 (JOHNSON AVENUE)
JONESBORO, ARKANSAS

Littlejohn
An S&ME Company

1995 21st Avenue South, NASHVILLE, TENNESSEE 37212
T 615.385.4144 F 615.385.4020 www.littlejohn.com

NO.	DESCRIPTION	DATE

**PHASE 1
SITE
HARDSCAPE**

DATE: 12/03/2016	DRAWN:
CADD FILE:	CHECKED: AR/JDH
DWG#:	SHEET
SCALE:	H006

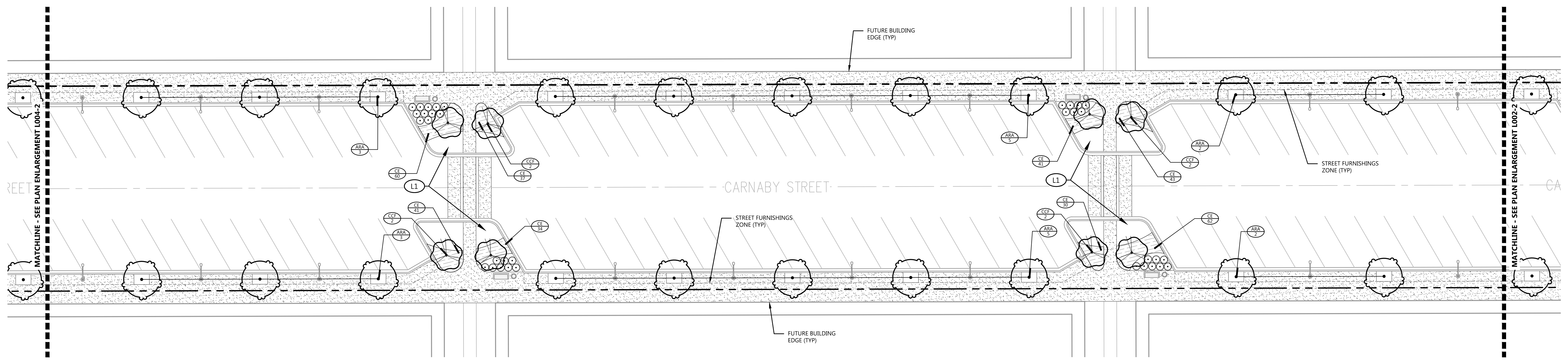

PLAN ENLARGEMENT L003-1

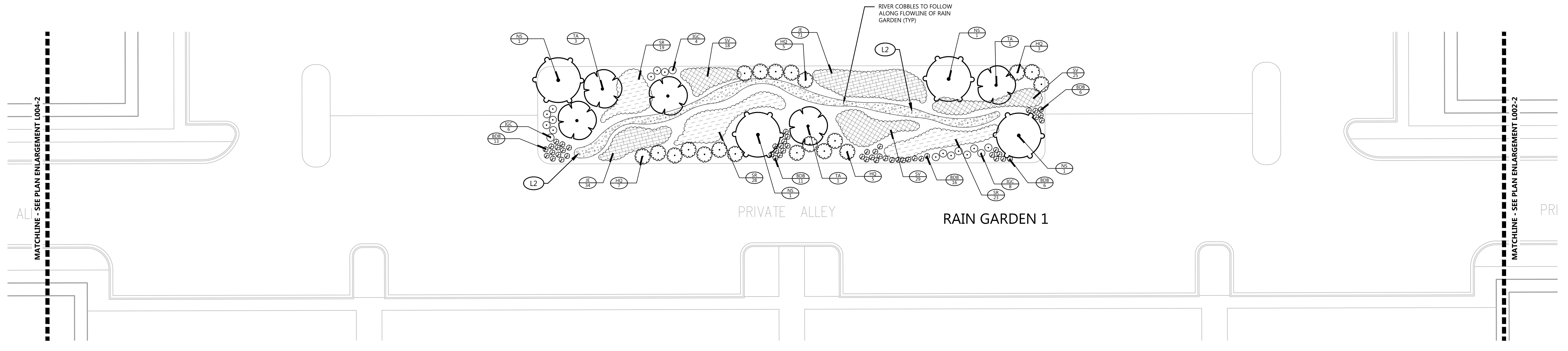

PLAN ENLARGEMENT L003-2

PLANT SCHEDULE L003-1

TREES	QTY	BOTANICAL NAME	COMMON NAME	CONT	CAL	SIZE	SPREAD	REMARKS	
ARA	20	Acer rubrum 'JFS-KW78'	Armstrong Gold Maple	B & B	3"	12-14'	5'	Well branched w/ strong central leader	
CCF	8	Cercis canadensis 'Forest Pansy' TM	Forest Pansy Redbud	B & B	2"	6-7'	4-4.5'	balanced canopy; well branched	
SHRUBS	QTY	BOTANICAL NAME	COMMON NAME	CONT	CALIPER	HEIGHT	SPREAD	SPACING	REMARKS
IGC	34	Ilex glabra 'Compacta'	Compact Inkberry Holly	#3 Cont.		21-24"	18"	36" o.c.	
GROUND COVERS	QTY	BOTANICAL NAME	COMMON NAME	CONT	CALIPER	HEIGHT	SPREAD	SPACING	REMARKS
CE	348	Carex oshimensis 'Everillo'	Everillo Japanese Sedge	#1 Cont.				18" o.c.	

PLANT SCHEDULE L003-2

TREES	QTY	BOTANICAL NAME	COMMON NAME	CONT	CAL	SIZE	SPREAD	REMARKS	
NS	4	Nyssa sylvatica	Blackgum	B & B	4"	14-16'	4-5'	Well branched	
TA	5	Taxodium ascendens	Pondcypress	B & B	3"	14-16'	4-6'		
SHRUBS	QTY	BOTANICAL NAME	COMMON NAME	CONT	CALIPER	HEIGHT	SPREAD	SPACING	REMARKS
BDB	52	Buddleja x 'Blue Chip'	Blue Chip Dwarf Butterfly Bush	#1 Cont.		12"	12"	24" o.c.	
HQ	20	Hydrangea quercifolia	Oakleaf Hydrangea	#7 Cont.		30-36"	30-36"	72" o.c.	Full
IGC	18	Ilex glabra 'Compacta'	Compact Inkberry Holly	#3 Cont.		21-24"	18"	36" o.c.	
GROUND COVERS	QTY	BOTANICAL NAME	COMMON NAME	CONT	CALIPER	HEIGHT	SPREAD	SPACING	REMARKS
JE	105	Juncus effusus	Soft Rush	6" Pot		12"	6"	30" o.c.	
SR	70	Solidago rugosa 'Fireworks'	Wrinkleleaf Goldenrod	6" Pot		12-15"	9-12"	42" o.c.	
SV	72	Scirpus validus	Great Bulrush	#1 Cont.		24"	9-12"	36" o.c.	

LANDSCAPE KEYNOTES	
CODE	DESCRIPTION
L1	AREA TO BE SODDED
L2	AREA TO BE 4"-6" RIVER ROCK

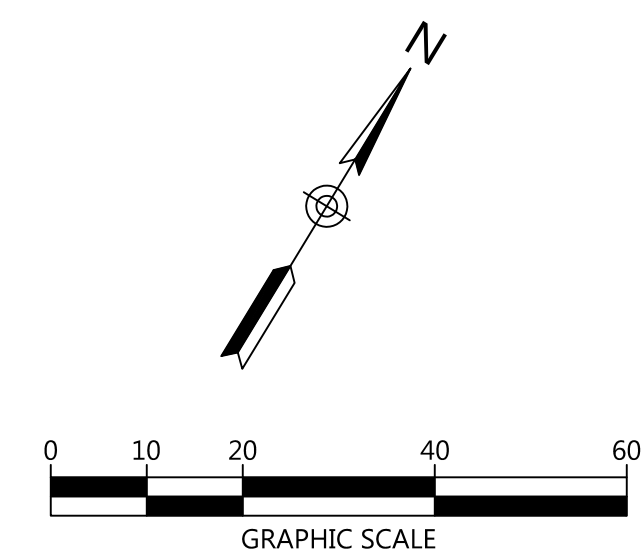

GREENSBOROUGH VILLAGE
 PHASES 1 & 1A
 U.S. HIGHWAY 49 (JOHNSON AVENUE)
 JONESBORO, ARKANSAS

Littlejohn
 An S&ME Company
 1995 21st Avenue South, NASHVILLE, TENNESSEE 37212
 T. 615.385.4144 F. 615.385.4020 www.littlejohn.com

NO.	DESCRIPTION	DATE

**PHASE 1
 SITE
 LANDSCAPE**
 DATE: 12/03/2016 DRAWN:
 CADD FILE: CHECKED: AR/JDH
 DWG#: SHEET
 SCALE: L003

G:\Projects\2013\20130081\001\Construction\Phase 1\20130081_L001_Landscape.dwg - 02.02.2016 - 1:21pm pwilkins

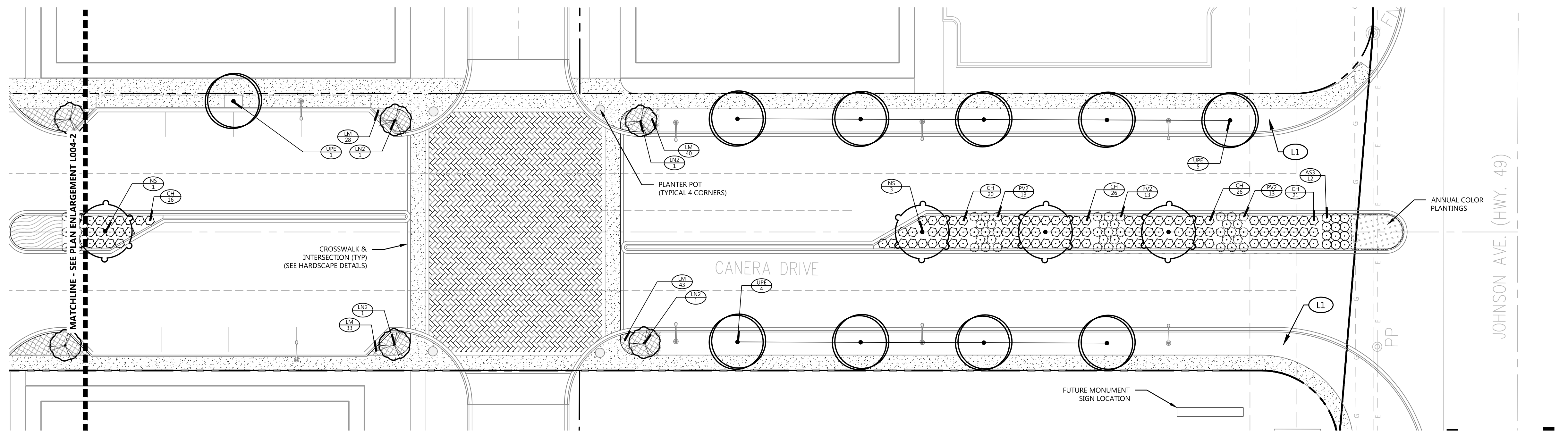

PLAN ENLARGEMENT L004-1

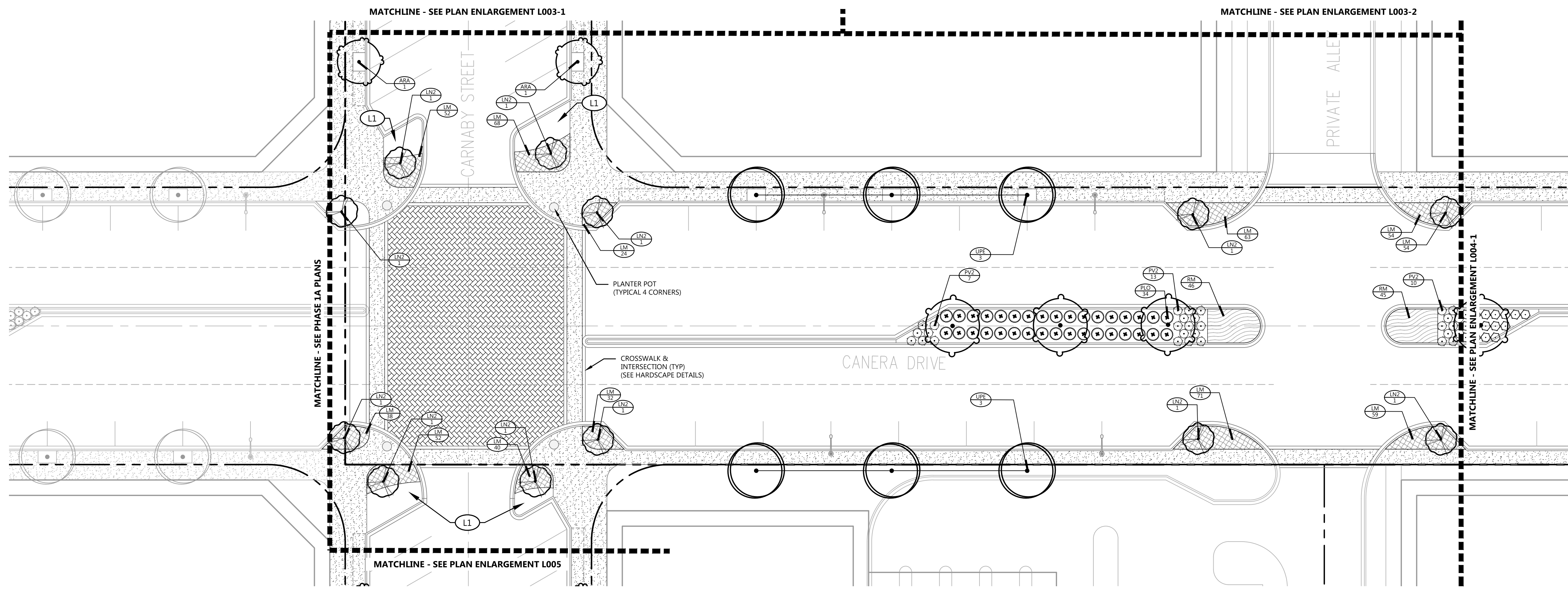

PLAN ENLARGEMENT L004-2

PLANT SCHEDULE L004-1

TREES	QTY	BOTANICAL NAME	COMMON NAME	CONT	CAL	SIZE	SPREAD	REMARKS	
LN2	4	Lagerstroemia indica 'Natchez'	Crape Myrtle	B & B		10-12'	6'	Limb up to 5.5' ht; single-stem	
NS	4	Nyssa sylvatica	Blackgum	B & B	4"	14-16'	4-5'	Well branched	
UPE	10	Ulmus parvifolia 'Everclear'	Everclear Lacebark Elm	B & B	3"	14-15'	4-5'		
SHRUBS	QTY	BOTANICAL NAME	COMMON NAME	CONT	CALIPER	HEIGHT	SPREAD	SPACING	REMARKS
AS3	12	Abelia x grandiflora 'Rose Creek'	Rose Creek Abelia	#3 Cont.		24"	24"	36" o.c.	
CH	109	Cephalotaxus harringtonia 'Prostrata'	Spreading Plum Yew	#3 Cont.			20"	36" o.c.	
PV2	39	Pennisetum alopecuroides 'Hameln'	Dwarf Fountain Grass	#1 Cont.				36" o.c.	
GROUND COVERS	QTY	BOTANICAL NAME	COMMON NAME	CONT	CALIPER	HEIGHT	SPREAD	SPACING	REMARKS
LM	144	Liriope muscari 'Big Blue'	Big Blue Lilyturf	4" pot				18" o.c.	

PLANT SCHEDULE L004-2

TREES	QTY	BOTANICAL NAME	COMMON NAME	CONT	CAL	SIZE	SPREAD	REMARKS	
ARA	2	Acer rubrum 'JFS-KW78'	Armstrong Gold Maple	B & B	3"	12-14'	5'	Well branched w/ strong central leader	
LN2	12	Lagerstroemia indica 'Natchez'	Crape Myrtle	B & B		10-12'	6'	Limb up to 5.5' ht; single-stem	
NS	3	Nyssa sylvatica	Blackgum	B & B	4"	14-16'	4-5'	Well branched	
UPE	6	Ulmus parvifolia 'Everclear'	Everclear Lacebark Elm	B & B	3"	14-15'	4-5'		
SHRUBS	QTY	BOTANICAL NAME	COMMON NAME	CONT	CALIPER	HEIGHT	SPREAD	SPACING	REMARKS
PLO	34	Prunus laurocerasus 'Otto Luyken'	Luykens Laurel	#7 Cont./B&B		30"	36"	48" o.c.	Dense and full
PV2	30	Pennisetum alopecuroides 'Hameln'	Dwarf Fountain Grass	#1 Cont.				36" o.c.	
GROUND COVERS	QTY	BOTANICAL NAME	COMMON NAME	CONT	CALIPER	HEIGHT	SPREAD	SPACING	REMARKS
LM	553	Liriope muscari 'Big Blue'	Big Blue Lilyturf	4" pot				18" o.c.	
RM	91	Rosa x 'Meidiflora'	Coral Drift Rose	#1 Cont.				24" o.c.	

LANDSCAPE KEYNOTES	
CODE	DESCRIPTION
L1	AREA TO BE SODDED
L2	AREA TO BE 4"-6" RIVER ROCK

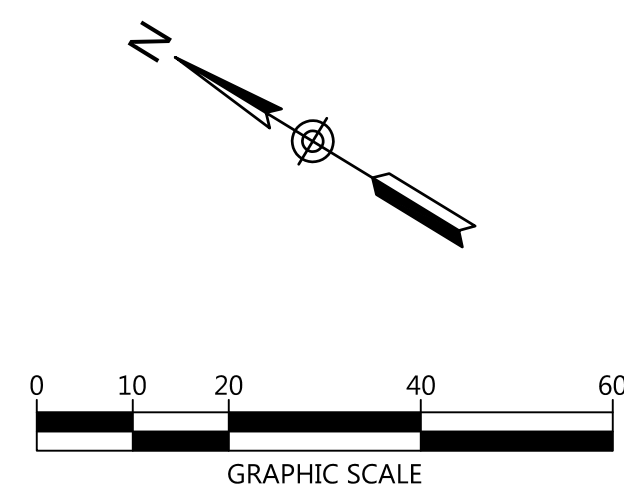

GREENSBOROUGH VILLAGE
PHASES 1 & 1A
U.S. HIGHWAY 49 (JOHNSON AVENUE)
JONESBORO, ARKANSAS

Littlejohn
An S&ME Company
1995 21st Avenue South, NASHVILLE, TENNESSEE 37212
T 615.385.4144 F 615.385.4020 www.littlejohn.com

NO.	DESCRIPTION	DATE

**PHASE 1
SITE
LANDSCAPE**

DATE: 12/03/2016 DRAWN:
CADD FILE: CHECKED: AR/JDH
DWG#: SHEET
SCALE: L004

G:\Projects\2013\20130081\ang\Construction\Phase 1\20130081_LP_L001_LSCAPE.dwg - L004 - Dec 02, 2016 - 1:22pm pml/iam

G:\Projects\2013\20130081\Construction\Phase 1\20130081_Landscape.dwg - 12/02/2016 - 1:22pm pwilliams

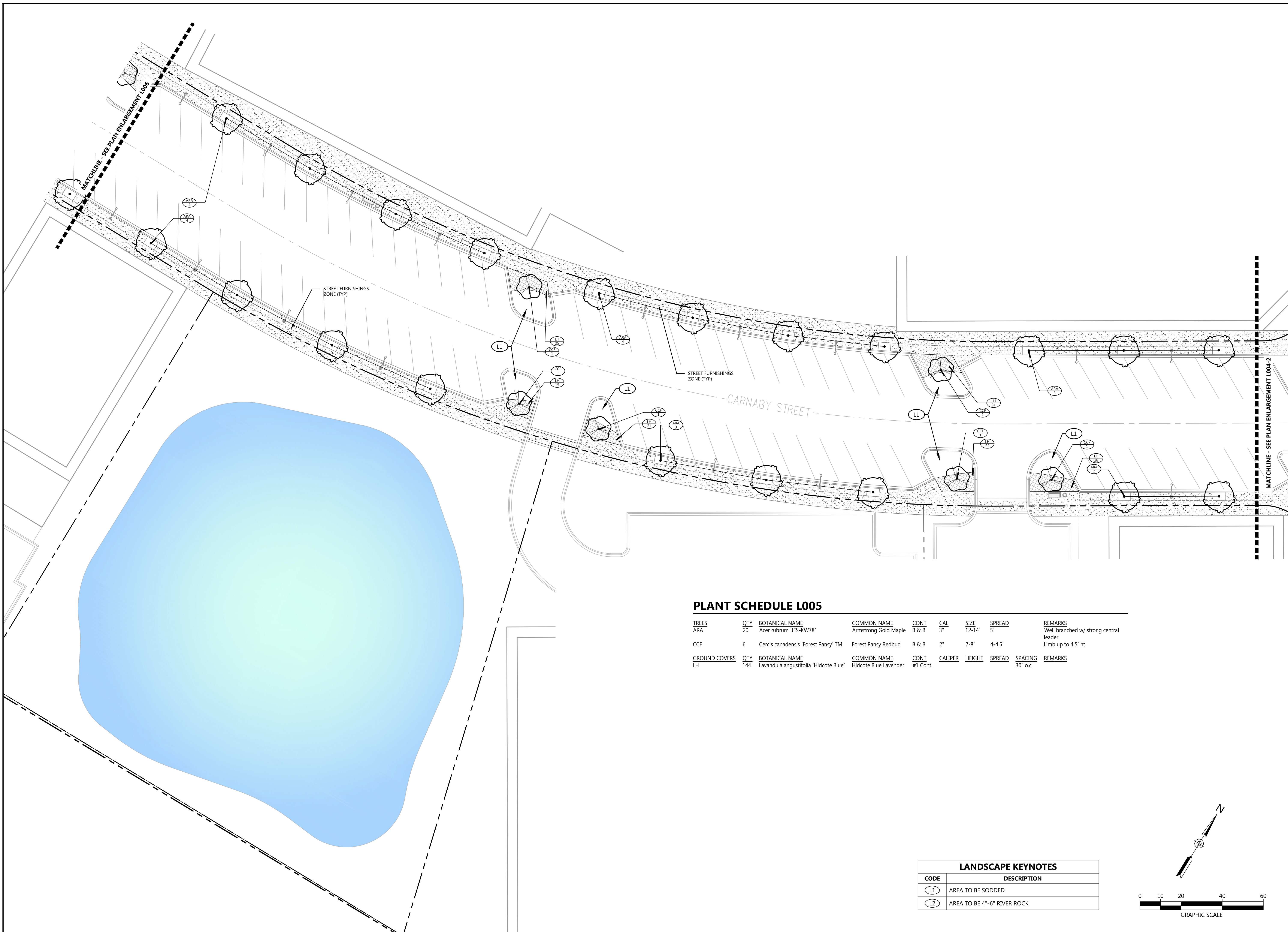

PLANT SCHEDULE L005

TREES	QTY	BOTANICAL NAME	COMMON NAME	CONT	CAL	SIZE	SPREAD	REMARKS	
ARA	20	Acer rubrum 'JFS-KW78'	Armstrong Gold Maple	B & B	3"	12-14'	5'	Well branched w/ strong central leader	
CCF	6	Cercis canadensis 'Forest Pansy' TM	Forest Pansy Redbud	B & B	2"	7-8'	4-4.5'	Limb up to 4.5' ht	
GROUND COVERS	QTY	BOTANICAL NAME	COMMON NAME	CONT	CALIPER	HEIGHT	SPREAD	SPACING	REMARKS
LH	144	Lavandula angustifolia 'Hidcote Blue'	Hidcote Blue Lavender	#1 Cont.				30" o.c.	

LANDSCAPE KEYNOTES	
CODE	DESCRIPTION
(L1)	AREA TO BE SODDED
(L2)	AREA TO BE 4"-6" RIVER ROCK

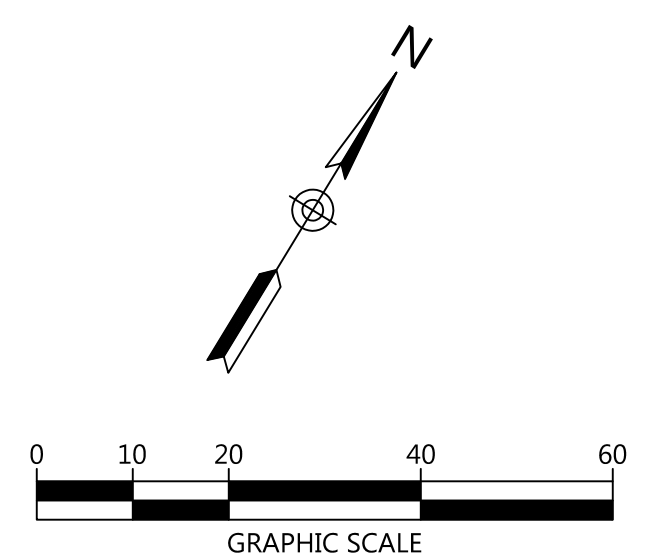

GREENSBOROUGH VILLAGE
 PHASES 1 & 1A
 U.S. HIGHWAY 49 (JOHNSON AVENUE)
 JONESBORO, ARKANSAS

Littlejohn
 An S&ME Company

1995 21st Avenue South, NASHVILLE, TENNESSEE 37212
 T 615.385.4144 F 615.385.4020 www.littlejohn.com

NO.	DESCRIPTION	DATE

**PHASE 1
 SITE
 LANDSCAPE**

DATE: 12/03/2016 DRAWN:
 CADD FILE: CHECKED: AR/JDH
 DWG#: SHEET
 SCALE: L005

G:\Projects\2013\20130081\Construction\Phase 1\20130081_Landscape.dwg - 12/2/2016 - 1:22pm pwilliams

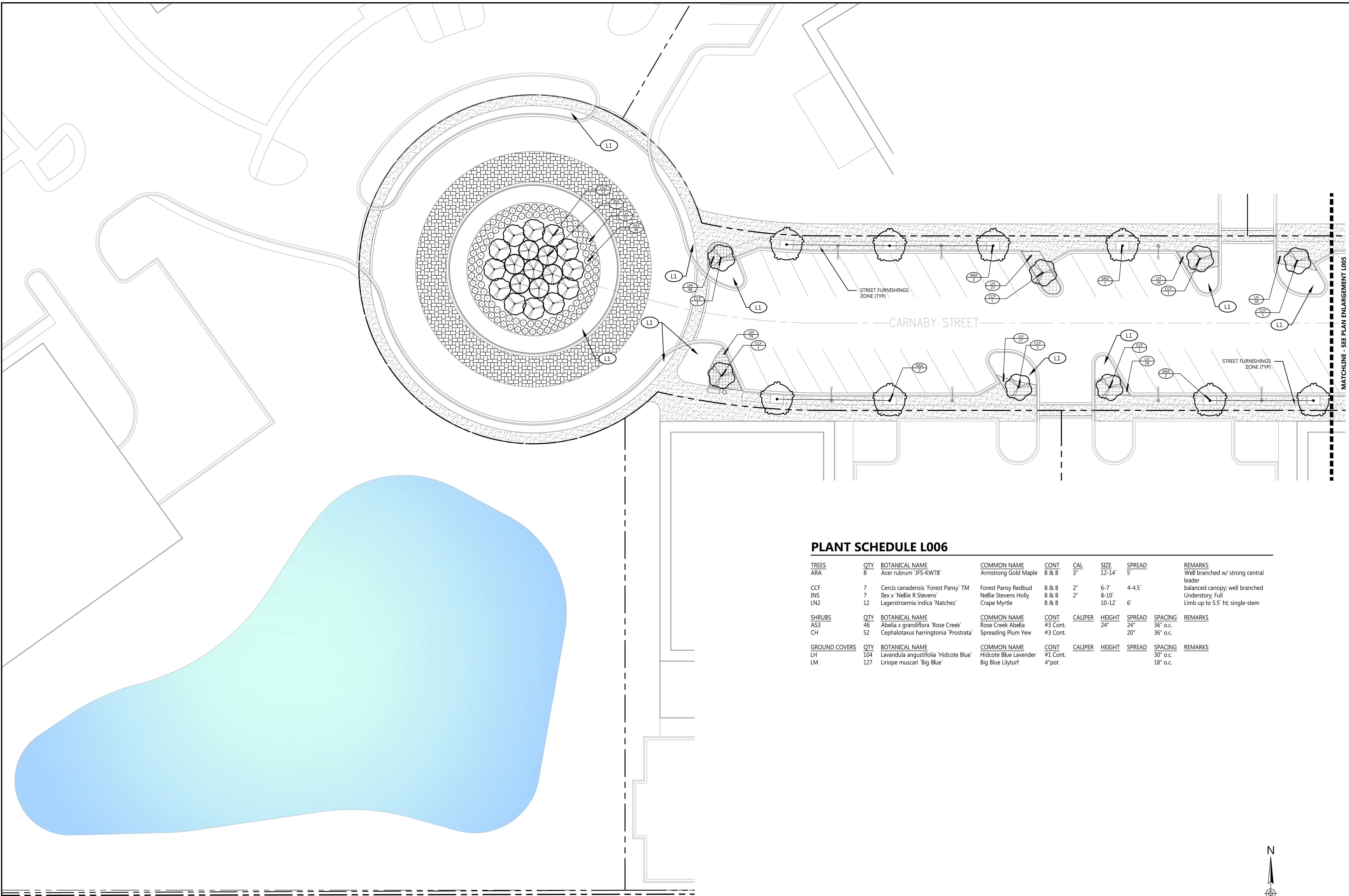

PLANT SCHEDULE L006

TREES	QTY	BOTANICAL NAME	COMMON NAME	CONT	CAL	SIZE	SPREAD	REMARKS	
ARA	8	Acer rubrum 'JFS-KW78'	Armstrong Gold Maple	B & B	3"	12-14'	5'	Well branched w/ strong central leader	
CCF	7	Cercis canadensis 'Forest Pansy'™	Forest Pansy Redbud	B & B	2"	6-7'	4-4.5'	balanced canopy; well branched	
INS	7	Ilex x 'Nellie R Stevens'	Nellie Stevens Holly	B & B	2"	8-10'	6'	Understory; Full	
LN2	12	Lagerstroemia indica 'Natchez'	Crape Myrtle	B & B		10-12'		Limb up to 5.5' ht; single-stem	
SHRUBS	QTY	BOTANICAL NAME	COMMON NAME	CONT	CALIPER	HEIGHT	SPREAD	SPACING	REMARKS
AS3	46	Abelia x grandiflora 'Rose Creek'	Rose Creek Abelia	#3 Cont.	24"	24"	24"	36" o.c.	
CH	52	Cephalotaxus harringtonia 'Prostrata'	Spreading Plum Yew	#3 Cont.		20"	20"	36" o.c.	
GROUND COVERS	QTY	BOTANICAL NAME	COMMON NAME	CONT	CALIPER	HEIGHT	SPREAD	SPACING	REMARKS
LH	104	Lavandula angustifolia 'Hidcote Blue'	Hidcote Blue Lavender	#1 Cont.				30" o.c.	
LM	127	Liriope muscari 'Big Blue'	Big Blue Lilyturf	4" pot				18" o.c.	

LANDSCAPE KEYNOTES	
CODE	DESCRIPTION
(L1)	AREA TO BE SODDED
(L2)	AREA TO BE 4"-6" RIVER ROCK

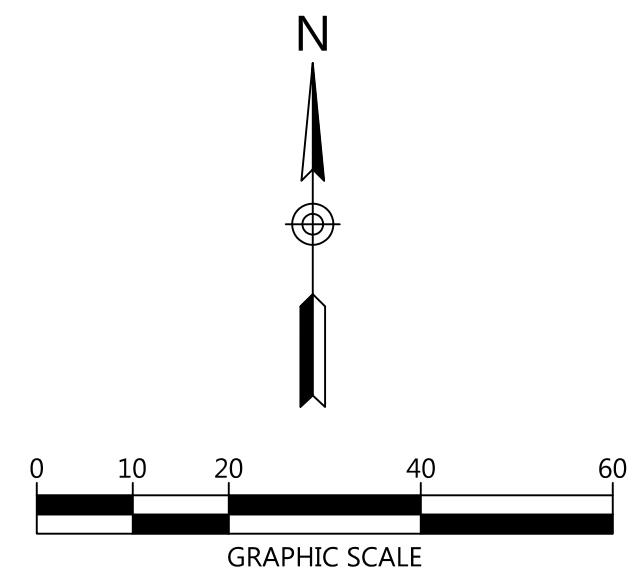

GREENSBOROUGH VILLAGE
 PHASES 1 & 1A
 U.S. HIGHWAY 49 (JOHNSON AVENUE)
 JONESBORO, ARKANSAS

Littlejohn
 An S&ME Company

1935 21st Avenue South, NASHVILLE, TENNESSEE 37212
 T 615.385.4144 F 615.385.4020 www.littlejohn.com

NO.	DESCRIPTION	DATE

**PHASE 1
 SITE
 LANDSCAPE**

DATE: 12/03/2016 DRAWN:
 CADD FILE: CHECKED: AR/JDH
 DWG#: SHEET
 SCALE: L006

PLANTING NOTES

- IT IS THE RESPONSIBILITY OF THE LANDSCAPE CONTRACTOR TO CONFIRM ALL MATERIAL QUANTITIES. IN THE EVENT OF A DISCREPANCY, THE QUANTITIES SHOWN ON THE PLAN SHALL TAKE PRECEDENCE OVER THE MATERIAL SCHEDULE.
- NO SUBSTITUTIONS AS TO TYPE, SIZE, OR SPACING OF PLANT MATERIALS SPECIFIED ON THIS PLAN MAY BE MADE WITHOUT THE APPROVAL OF THE OWNER'S REPRESENTATIVE.
- THE CONTRACTOR IS TO VERIFY THE EXACT LOCATION OF ALL EXISTING UTILITIES. TAKE CARE TO PROTECT UTILITIES THAT ARE TO REMAIN, REPAIR ANY DAMAGE ACCORDING TO LOCAL STANDARDS AND AT CONTRACTOR'S EXPENSE. COORDINATE ALL CONSTRUCTION WITH THE APPROPRIATE UTILITY COMPANY.
- ALL PLANTING BEDS TO RECEIVE PINE STRAW MULCH. MULCH TO BE INSTALLED TO 4" DEPTH UNLESS OTHERWISE INDICATED ON THE PLANTING DETAILS.
- NEW TREE PLANTINGS TO BE STAKED PER PLANTING DETAILS
- DIMENSIONS LISTED FOR HEIGHTS, SPREAD AND TRUNK SPECIFICATIONS ON THE PLANT MATERIAL SCHEDULE ARE GENERAL GUIDE FOR THE MINIMUM REQUIRED SIZE OF EACH PLANT.
- PRE-EMERGENT HERBICIDE SHALL BE APPLIED TO ALL PLANTING BEDS IMMEDIATELY PRIOR TO PLACEMENT OF MULCH FOR WEED CONTROL.
- ALL DISTURBED AREAS OF THE SITE ARE TO BE SEEDED AND/OR SODDED IN ACCORDANCE WITH THE SPECIFICATIONS.
- NO EXCAVATION OR PLANTING PIT SHALL BE LEFT OPEN OVERNIGHT.
- THE LANDSCAPE CONTRACTOR SHALL OBTAIN ANY NECESSARY PERMITS, LICENSES, ETC. AND SHALL GIVE ALL NOTICES AND COMPLY WITH ALL APPLICABLE LAWS, ORDINANCES, CODES, RULES AND REGULATIONS DURING THE COURSE OF THE INSTALLATION OF THIS PROJECT.
- ALL PLANT MATERIALS TO BE NURSERY GROWN AND TO COMPLY WITH THE AMERICAN STANDARD FOR NURSERY STOCK FOR SIZE AND QUALITY.
- THE LANDSCAPE ARCHITECT RESERVES THE RIGHT TO REFUSE ANY PLANT MATERIAL OR ANY DEFECTIVE WORKMANSHIP.
- ALL PLANTS SHALL HAVE A WELL-FORMED HEAD WITH MINIMUM CALIPER, HEIGHT AND SPREAD OF THE SIDE BRANCHES AS SHOWN ON THE PLANT LIST. TRUNKS SHALL BE UNDAMAGED AND SHAPE SHALL BE TYPICAL OF THE SPECIES.
- MEASUREMENT OF CONIFER HEIGHT SHALL INCLUDE NOT MORE THAN FIFTY PERCENT (50%) OF THIS YEARS VERTICAL GROWTH (TOP CANDLE).
- THE LANDSCAPE CONTRACTOR WILL BE RESPONSIBLE FOR STAKING AND LAYOUT OF PLANTINGS ON THIS PROJECT. THE LANDSCAPE ARCHITECT OR OWNER SHALL BE ADVISED WHEN STAKES ARE READY FOR INSPECTION ON VARIOUS PLANTING AREAS. ALL LAYOUT WORK SHALL BE INSPECTED AND APPROVED BY THE LANDSCAPE ARCHITECT OR OWNER PRIOR TO OPENING ANY PLANT PITS.
- IT IS THE RESPONSIBILITY OF THE LANDSCAPE CONTRACTOR TO VERIFY THAT EACH EXCAVATED TREE OR SHRUB PIT WILL PERCOLATE (DRAIN) PRIOR TO ADDING TOPSOIL AND INSTALLING TREES OR SHRUBS. THE CONTRACTOR SHALL FILL THE BOTTOM OF SELECTED HOLES WITH SIX INCHES OF WATER. THIS WATER SHOULD PERCOLATE OUT WITHIN A 24-HOUR PERIOD. THE OWNER OR LANDSCAPE ARCHITECT SHALL VERIFY ACCURACY AND EFFECT OF PERCOLATION TESTING. IF THE SOIL AT A GIVEN AREA DOES NOT DRAIN PROPERLY, A P V C DRAIN OR GRAVEL SUMP SHALL BE INSTALLED OR THE PLANTING RELOCATED.
- SHOULD THE LANDSCAPE CONTRACTOR ENCOUNTER UNSATISFACTORY SURFACE OR OTHER SUBSURFACE DRAINAGE CONDITIONS, SOIL DEPTH, LATENT SOILS, HARD PAN, STEAM OF OTHER UTILITY LINES OR OTHER CONDITIONS THAT WILL JEOPARDIZE THE HEALTH AND VIGOR OF THE PLANTS, HE MUST ADVISE THE LANDSCAPE ARCHITECT IN WRITING OF THE CONDITIONS PRIOR TO INSTALLING THE PLANTS. OTHERWISE THE LANDSCAPE CONTRACTOR WARRANTS THAT THE PLANTING AREAS ARE SUITABLE PROPER GROWTH AND DEVELOPMENT OF THE PLANTS TO BE INSTALLED.
- NO MATERIAL SHALL BE PLANTED BEFORE FINISH GRADING HAS BEEN COMPLETED.
- EXISTING TREES TO BE PRESERVED ARE TO BE BARRICADED BEFORE BEGINNING CONSTRUCTION. IN ACCORDANCE WITH THE TREE PRESERVATION NOTES AND DETAILS ON THE LANDSCAPE PLAN.
- SELECTIVE CLEARING CONSISTING OF REMOVAL OF VINES, SAPLINGS UNDER 1" DIAMETER AND UNDERBRUSH SHALL BE PERFORMED IN TREE PRESERVATION AREAS INTERNAL TO THE PROJECT AND NOTED ON PLANS.
- PLANTS IDENTIFIED IN ALTERNATE AREAS ARE TO BE BID SEPARATELY.
- ALL BEDS ARE TO BE TILLED TO A DEPTH OF 8" WITH THE ADDITION OF: (1) 6 CU. FT. BALE OR SPHAGNUM PEAT MOSS PER 40 SQ. FT. OF BED AREA; (25#) 10-10-10 FERTILIZER PER 1000 SQ. FT. IF azaleas, rhododendrons or PIERIS ARE USED, ADD 1.3 CU. FT. FINELY GROUND "PINE" BARK MULCH PER 25 SQ. FT. OF BED AREA. ALL ADDITIONS ARE TO BE SPREAD AND TILLED INTO THE SOIL UNIFORMLY.
- CONTRACTOR SHALL NOTIFY THE LANDSCAPE ARCHITECT WHEN THE PLANT MATERIALS ARE AVAILABLE AT THE JOB SITE FOR REVIEW BY THE LANDSCAPE ARCHITECT PRIOR TO INSTALLATION.

IRRIGATION NOTES:

- LANDSCAPE CONTRACTOR TO PROVIDE IRRIGATION SYSTEM ON A DESIGN/BUILD ARRANGEMENT FOR AREA NOTED ON THE PLAN. CONTRACTOR TO PREPARE DESIGN DRAWINGS IN ACCORDANCE WITH PERFORMANCE SPECIFICATIONS CONTAINED IN THE PROJECT MANUAL AND SUBMIT SAME FOR APPROVAL BY THE OWNER'S REPRESENTATIVE PRIOR TO CONSTRUCTION.
- CONTRACTOR TO CONFIRM ADEQUATE PRESSURE EXISTS TO OPERATE SYSTEM PRIOR TO INSTALLATION.
- IRRIGATION SPRINKLER HEADS SHALL BE MANUFACTURED BY EITHER TORO OR RAINBIRD. IRRIGATION CONTROLLER SHALL BE TORO VISION II MODEL OR APPROVED EQUAL.
- MAIN LINE TO BE CLASS 200 PVC PIPE. LATERAL LINES TO BE CLASS 150 PVC.
- IRRIGATION SYSTEM TO BE OPERATIONAL BEFORE PLANTING MATERIALS MAY BE INSTALLED IN PLANTING BEDS.
- INSTALL SPRINKLER HEADS ACCORDING TO MANUFACTURERS SPECIFICATIONS. FLUSH ALL LINES BEFORE INSTALLING NOZZLES.
- WIRE CONNECTIONS TO BE MADE BY USING RAINBIRD MODEL ST-103/PT-ST SNAP-TITE CONNECTIONS.
- LEAVE 18 INCHES OF ADDITIONAL WIRE AT EACH VALVE LOCATION. ROLL WIRE INTO COIL AT EACH LOCATION.
- ALL VALVES SHALL BE LOCATED IN AMATEX 10 INCH CIRCULAR VALVE BOXES WITH COVER, OR EQUAL.
- IRRIGATION CONTRACTOR TO COORDINATE PLACEMENT OF REQUIRED SLEEVES WITH GENERAL CONTRACTOR PRIOR TO PAVING AND CONCRETE INSTALLATION BEING COMPLETED.

6

SPADE BED EDGE
NOT TO SCALE

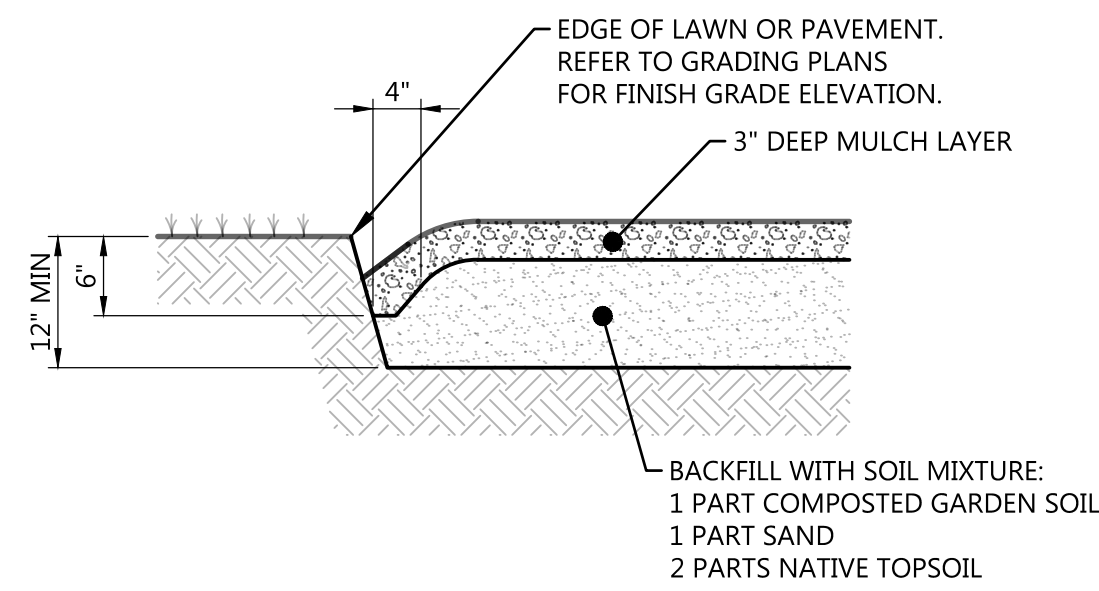

7

PLANTER
NOT TO SCALE

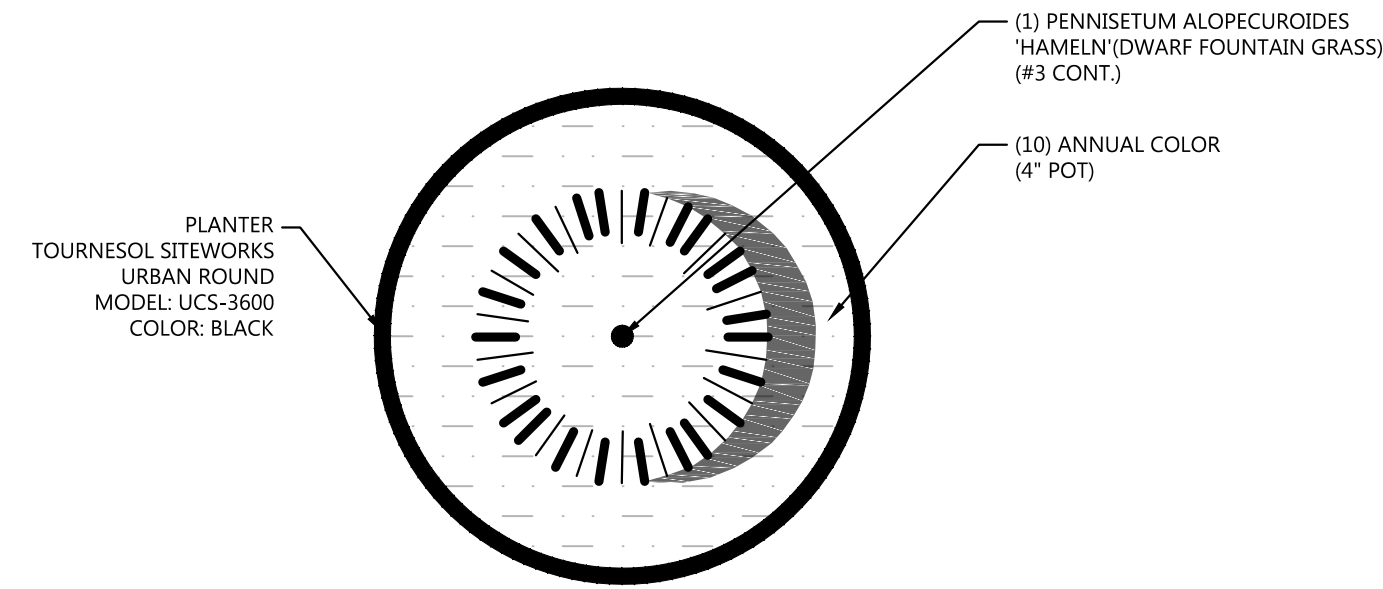

4

CANOPY TREE PLANTING
NOT TO SCALE

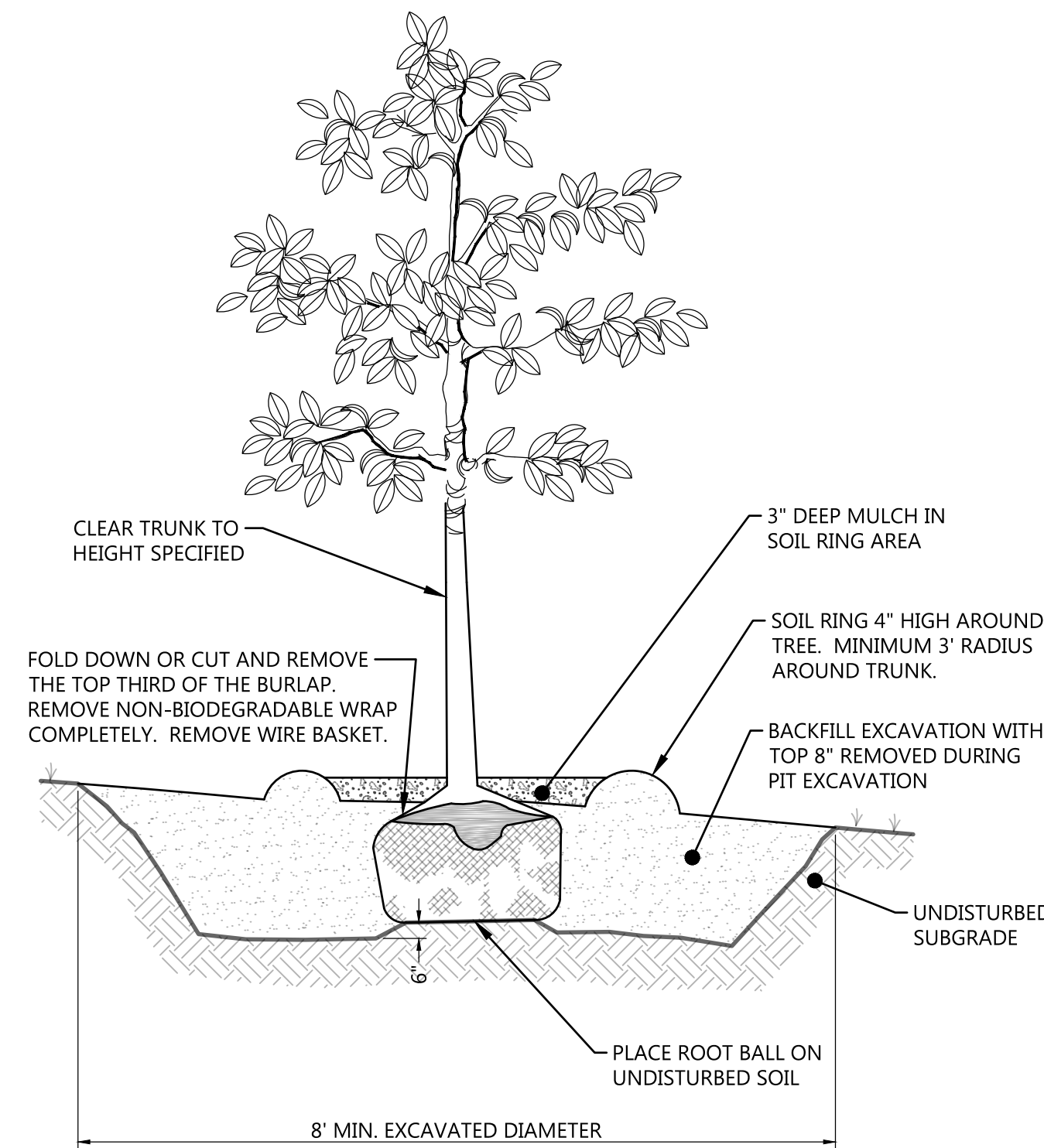

- NOTES:
- SCARIFY THE EDGES OF THE EXCAVATED PIT AND TAKE ALL NECESSARY MEASURES TO ASSURE ADEQUATE DRAINAGE.
 - TO ENSURE SUCCESSFUL ESTABLISHMENT OF ALL TREES PLANTED OUTSIDE THE LIMITS OF IRRIGATION EVERY SUCH TREE SHALL BE FITTED WITH A SLOW-RELEASE WATERING SYSTEM SUCH AS "TREEGATOR BAGS" OR AN APPROVED EQUAL.
 - AS PART OF THE MAINTENANCE PLAN IT IS RECOMMENDED THAT ALL TREES OUTSIDE THE LIMITS OF IRRIGATION BE WATERED A MAXIMUM OF TWO TIMES PER WEEK DURING DRY SEASONS AND ONE TIME PER WEEK DURING WET SEASONS FOR A MINIMUM OF TWO YEARS FROM THE DATE OF INSTALLATION.
 - IT IS THE OWNER'S RESPONSIBILITY TO COORDINATE AND SCHEDULE TREE MAINTENANCE.

5

TREE WELL
NOT TO SCALE

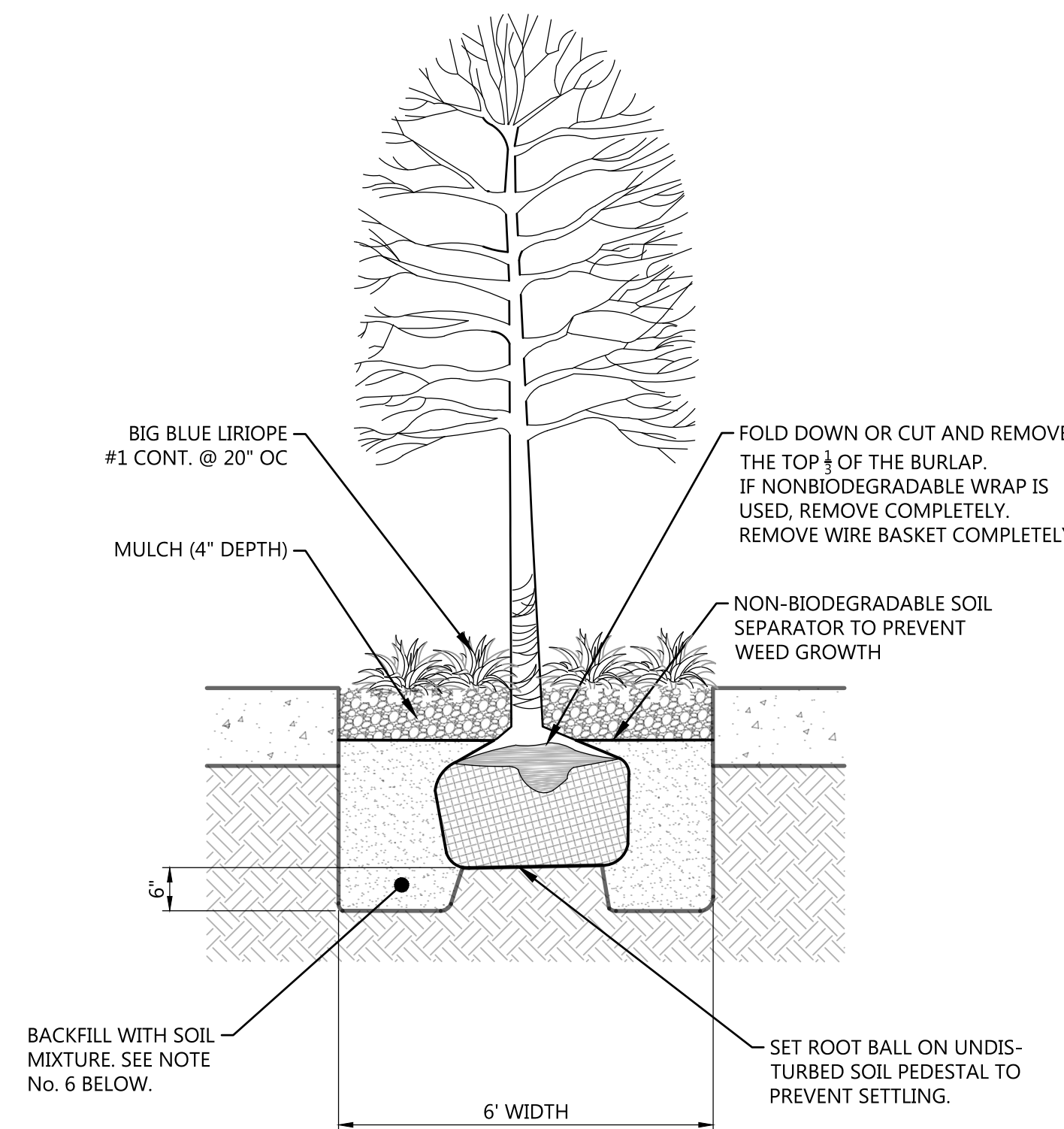

- NOTES:
- TREE STAKING IS NOT PREFERRED BUT TO BE USED AS A LAST RESORT ON WINDY SITES. INSTALL TWO OF THE THREE STAKES AND GUY WIRES ON THE UPHILL SIDE OF THE TREE. DO NOT DAMAGE MAIN ROOTS OR DESTROY ROOT BALL WHEN INSTALLING TREE STAKES.
 - WATER THOROUGHLY AFTER INSTALLATION.
 - REMOVE GUY WIRES AND TIES AFTER 6 MONTHS OR AT THE DIRECTION OF THE LANDSCAPE ARCHITECT.
 - TREE SHALL STAND PLUMB.
 - SOIL MIX: 1 PART ORGANIC MATERIAL, 1 PART SAND AND 2 PARTS TOPSOIL.

1

GROUNDCOVER PLANTING
NOT TO SCALE

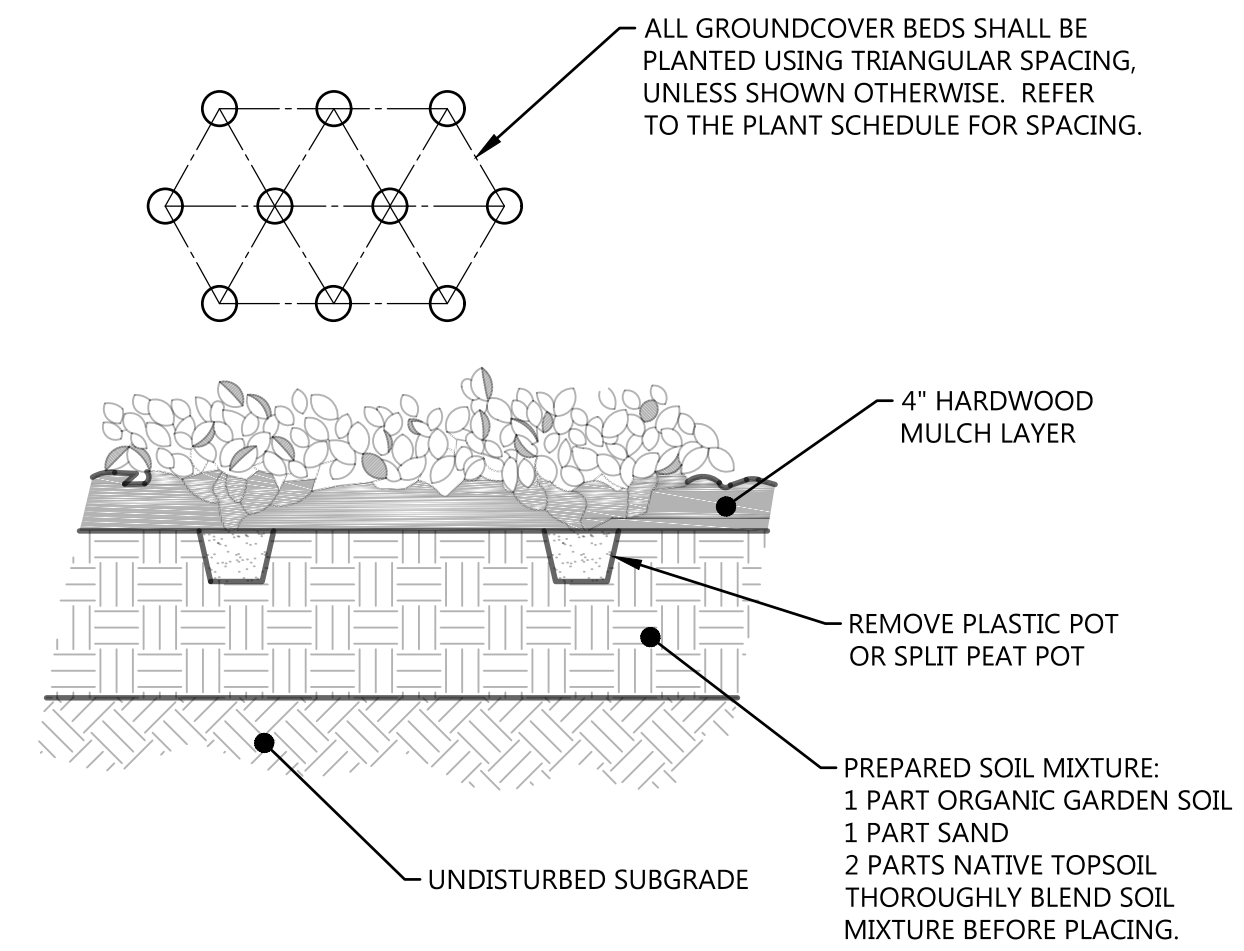

2

SHRUB PLANTING
NOT TO SCALE

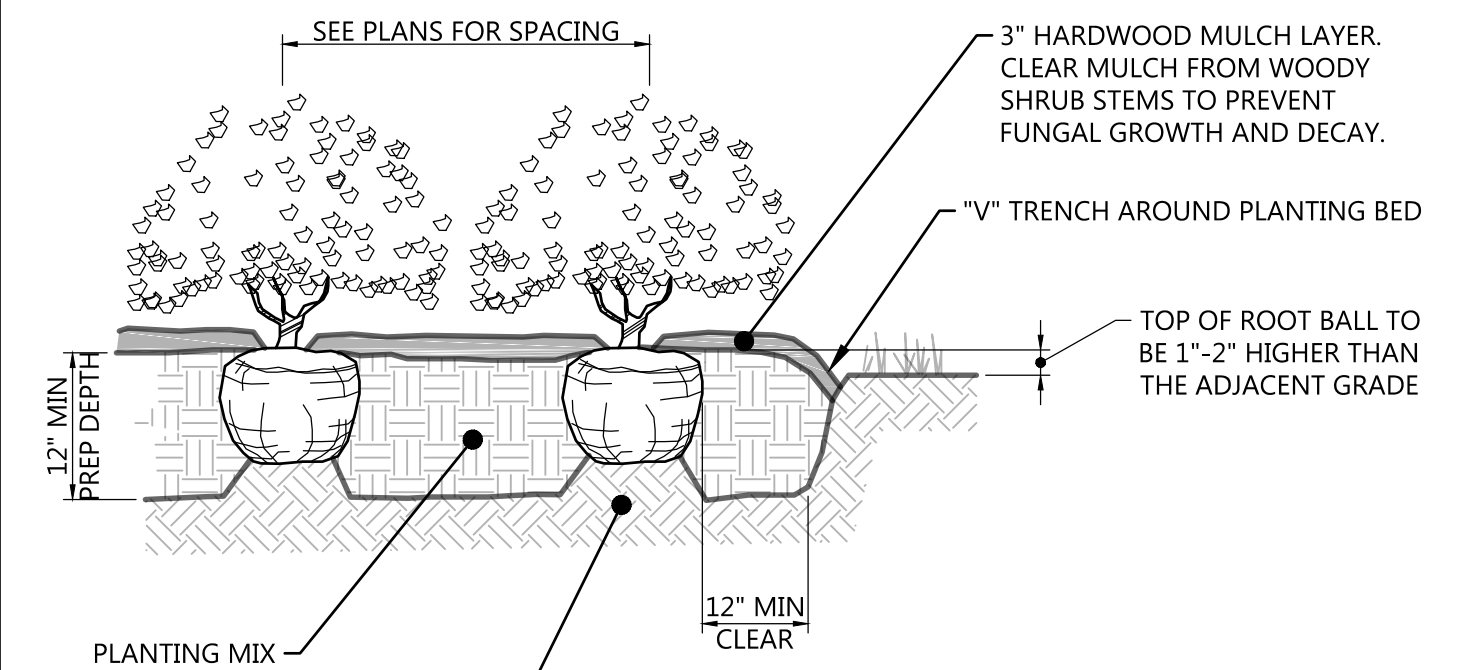

- NOTES:
- TAMP PLANTING MIX AS PIT IS FILLED AROUND EACH PLANT BALL.
 - SOAK EACH PLANT BALL AND PIT IMMEDIATELY AFTER PLANTING.
 - SCARIFY THE ROOT BALL IF ROOT-BOUND IN ITS CONTAINER.
 - WHERE SHRUBS APPEAR IN BED AREAS, 3" OF MULCH SHALL BE SPREAD OVER THE ENTIRE AREA WITHIN THE BED EDGE AS INDICATED ON THE PLANS.
 - DO NOT PRUNE BEFORE ACCEPTANCE.
 - REMOVE BURLAP FROM TOP THIRD OF ROOT BALL OR CAREFULLY REMOVE THE PLASTIC CONTAINER, IF ONE IS USED.
 - BACKFILL WITH SOIL MIXTURE AS FOLLOWS: 1 PART COMPOSTED GARDEN SOIL - 1 PART SAND - 2 PARTS NATIVE TOPSOIL.

3

SHRUB PLACEMENT
NOT TO SCALE

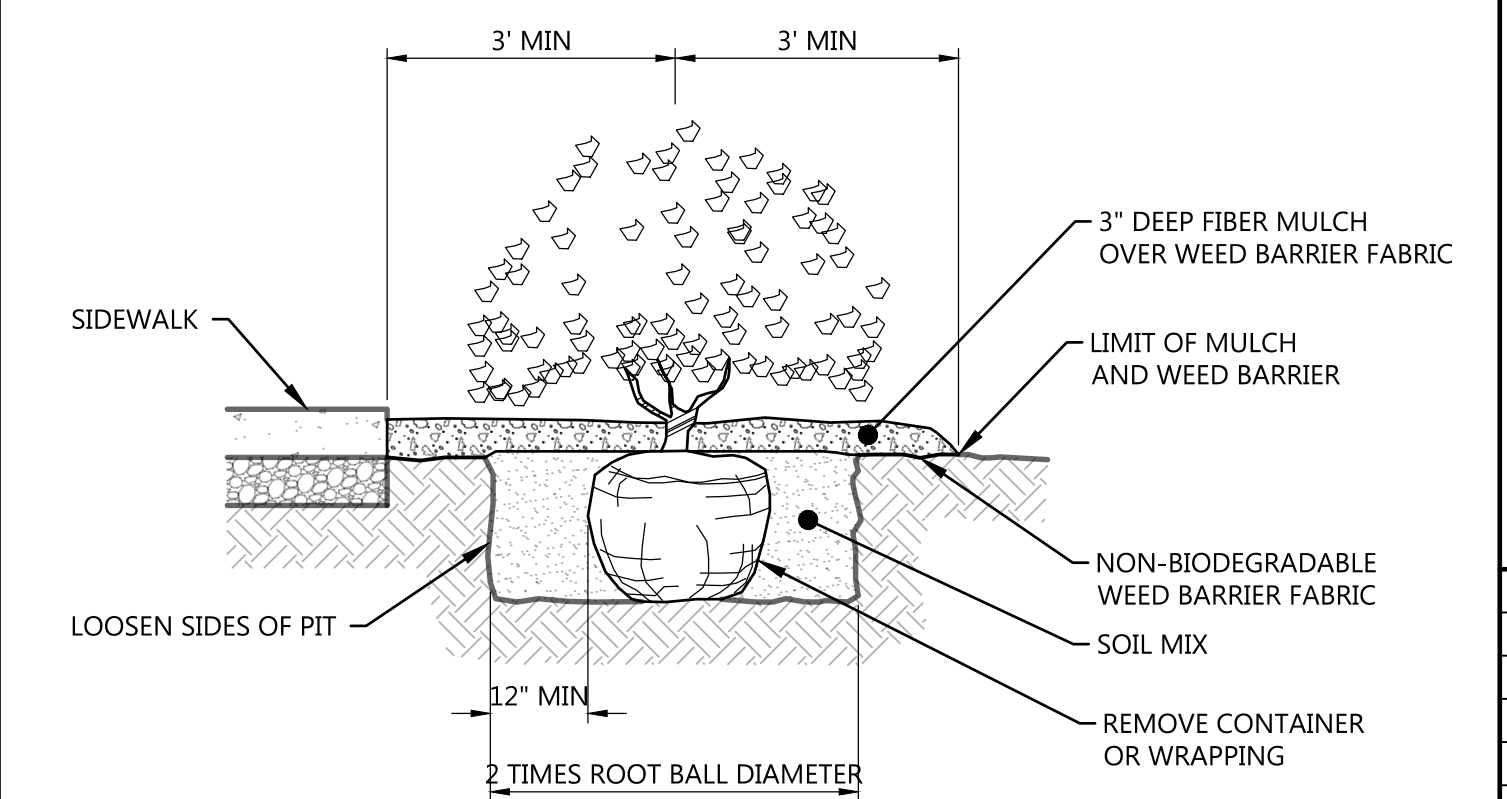

- NOTES:
- ANY BROKEN OR CRUMBLING ROOT BALL WILL BE REJECTED.
 - PRUNE ALL DAMAGED OR DEAD WOOD IMMEDIATELY PRIOR TO PLANTING.
 - INSTALL SHRUB FLUSH WITH ADJACENT GRADE.
 - SOAK EACH PLANT BALL AND PIT IMMEDIATELY AFTER PLANTING.
 - SCARIFY ROOT BALL IF ROOT-BOUND IN CONTAINER.
 - HOLD MULCH 1" BELOW EDGE OF WALK OR CURB.
 - PROTECT ALL SHRUBS WITH CAGES OF WELDED WIRE MESH 5' IN DIAMETER, 5' HIGH. SECURE WITH 6" STEEL T-POSTS DRIVEN MIN. 1' INTO THE GROUND. WIRE THE POSTS TO THE CAGE.

GREENSBOROUGH VILLAGE
PHASES 1 & 1A
U.S. HIGHWAY 49 (JOHNSON AVENUE)
JONESBORO, ARKANSAS

Littlejohn
An S&ME Company

1895 21st Avenue South, NASHVILLE, TENNESSEE 37212
F 615.385.4144 F 615.385.4020 www.littlejohn.com

NO.	DESCRIPTION	DATE

LANDSCAPE NOTES & DETAILS

DATE: 12/03/2016	DRAWN:
CADD FILE:	CHECKED: AR/DH
DWG#:	SHEET
SCALE:	L007